

**ARKANSAS DEPARTMENT OF ENVIRONMENTAL QUALITY  
NOTICE OF INTENT  
AGGREGATE FACILITIES  
NPDES GENERAL PERMIT ARG500000**

Application Type: New  Renewal  (Permit # ARG50 \_\_\_\_\_)

**I. PERMITTEE/OPERATOR INFORMATION**

Permittee (Legal Name): LENTZ SAND AND GRAVEL, LLC Operator Type:  
 Permittee Mailing Address: 194 SARDIS ROAD  State  Partnership  
 Permittee City: MORRILTON  Federal  Corporation\*  
 Permittee State: ARKANSAS Zip: 72110  Sole Proprietorship/Private  
 Permittee Telephone Number: (501) 354-6769 \*State of Incorporation: ARKANSAS  
 Permittee Fax Number: (501) 354-2994 The legal name of the Permittee must be  
 identical to the name listed with the Arkansas  
 Permittee E-mail Address: LENTZ.CONSTRUCTION@SBCGLOBAL.NET Secretary of State.

**II. INVOICE MAILING INFORMATION**

Invoice Contact Person: MYRA LENTZ City: MORRILTON  
 Invoice Mailing Company: LENTZ SAND AND GRAVEL, LLC State: ARKANSAS Zip: 72110  
 Invoice Mailing Address: 194 SARDIS ROAD Telephone: (501) 354-6769

**III. FACILITY INFORMATION**

Facility Name: LENTZ SAND & GRAVEL, LLC Facility Contact Person: ROBERT LENTZ  
 Facility Address: 1463 LOLLIE ROAD Telephone Number: 501-354-6769  
 Driving Directions to Facility: OFF HWY. 286 WEST TO LOLLIE ROAD - TURN LEFT - APPROX. 2 MILES TO GATE ON RIGHT.  
 Facility County: FAULKNER Facility City, State & Zip: CONWAY, ARKANSAS, 72034  
 Facility Latitude: 35 Deg 2 Min 59.74 Sec Facility Longitude: 92 Deg 32 Min 5.98 Sec  
 Accuracy: NA Method: NA Datum: NA Scale: NA Description: NA  
 Facility SIC Code: 1442 Facility NAICS: 212321

**IV. DISCHARGE INFORMATION**

Outfall Number: 001 Estimated Flow: NO DISCHARGE MGD (Million Gallons per Day)  
 Effluent Description: PROCESS WATER FROM WELL  
 Stream Segment: 3F Hydrologic Basin Code: 11110203  
 Outfall Latitude: 35 Deg 2 Min 55.62 Sec Outfall Longitude: 92 Deg 32 Min 13.7 Sec  
 Accuracy: NA Method: NA Datum: NA Scale: NA Description: NA  
 Receiving Stream: TUPelo Bayou TO ARKANSAS RIVER  
 Treatment System\*: SEDIMENTATION POND  
 Outfall Number: NA Flow: NA MGD (Million Gallons per Day)  
 Effluent Description: NA  
 Stream Segment: NA Hydrologic Basin Code: NA  
 Outfall Latitude: NA Deg NA Min NA Sec NA Outfall Longitude: NA Deg NA Min NA Sec NA

WATER DIVISION  
 5301 NORTSHORE DRIVE / NORTH LITTLE ROCK, ARKANSAS 72118  
 PHONE 501-682-0623 / FAX 501-682-0880

www.adeq.state.ar.us

Accuracy: NA Method: NA Datum: NA Scale: NA Description: NA  
 Receiving Stream: NA  
 Treatment System\*: NA  
 \*Include addition of any chemicals, if applicable.

**V. FACILITY PERMIT INFORMATION**

NPDES Individual Permit Number (If Applicable): AR00  
 NPDES General Permit Number (If Applicable): ARG 50000 REQUIRED  
 State Construction Permit Number: ARG50 C  
 NPDES General Construction Stormwater Permit Number (If Applicable): ARR15  
 NPDES Industrial Stormwater General Permit Number: ARR00  
 Mining Permit Number: NA  
 Other Department Permits: CORP. OF ENGRS.

**VI. OTHER INFORMATION:**

1. Does this facility intend to dredge or remove sand or gravel from within the submerged portions of a stream or drainage? Yes  No
2. Is the facility a producer of industrial sand?

Geological Description of Site: SANDY LOAM SOIL  
 Additional Location Description: NA  
 Additional Comments: NA  
 Consultant Contact Name: NA  
 Consultant Email Address: NA  
 Consultant Address: NA City: NA State: NA Zip: NA  
 Consultant Phone Number: NA Consultant Fax Number: NA

**VII. CERTIFICATION OF OPERATOR**

"I certify that, if this facility is a corporation, it is registered with the Secretary of the State of Arkansas. I certify that the cognizant official designated in this Application is qualified to act as a duly authorized representative under the provisions of 40 CFR 122.22(b). If no cognizant official has been designated, I understand that the Department will accept reports signed only by the Applicant. I certify under penalty of law that this document and all attachments were prepared under my direction or supervision in accordance with a system designed to assure that qualified personnel properly gather and evaluate the information submitted. Based on my inquiry of the person or persons directly responsible for gathering the information, the information submitted is, to the best of my knowledge and belief, true, accurate, and complete. I am aware that there are significant penalties for submitting false information, including the possibility of fine and imprisonment for knowing violations."

Responsible Official Printed Name: ROBERT LENTZ Title: MGR. AND VICE PRES.  
 Responsible Official Signature: [Signature] Date: 4-12-16  
 Responsible Official Email: lentzconstruction@sbcglobal.net  
 Cognizant Official Printed Name: Robert Lentz Title: MGR.  
 Cognizant Official Signature: [Signature] Telephone: 1-501-652-0416  
 Cognizant Official Email: lentzconstruction@sbcglobal.net

WATER DIVISION  
 5301 NORTSHORE DRIVE / NORTH LITTLE ROCK, ARKANSAS 72118  
 PHONE 501-682-0623 / FAX 501-682-0880  
 www.adeq.state.ar.us

**X. PERMIT REQUIREMENT VERIFICATION**

Please check the following to verify completion of permit requirements. If you answer "NO" to any of questions below the application will be considered incomplete and cause a delay in the permitting process.

	Yes	No	
Submittal of Complete NOI?	<input checked="" type="checkbox"/>	<input type="checkbox"/>	
Submittal of Required Permit Fee?	<input checked="" type="checkbox"/>	<input type="checkbox"/>	<b>New Permittees Only</b> Check Number: <u>12676</u>
Submittal of Topographic Map?	<input checked="" type="checkbox"/>	<input type="checkbox"/>	
Submittal of Disclosure Statement?	<input checked="" type="checkbox"/>	<input type="checkbox"/>	
Industrial Operator's License Number:			<u>NA</u>

QUADRANGLE LOCATION



Gleason Quad

ACTION NO. 15259-1  
Mr. Robert T. Williams  
SAND AND GRAVEL REMOVAL  
Arkansas River, NM 153.4 - 154.5 LB  
April 2011  
SHEET 1 OF 2

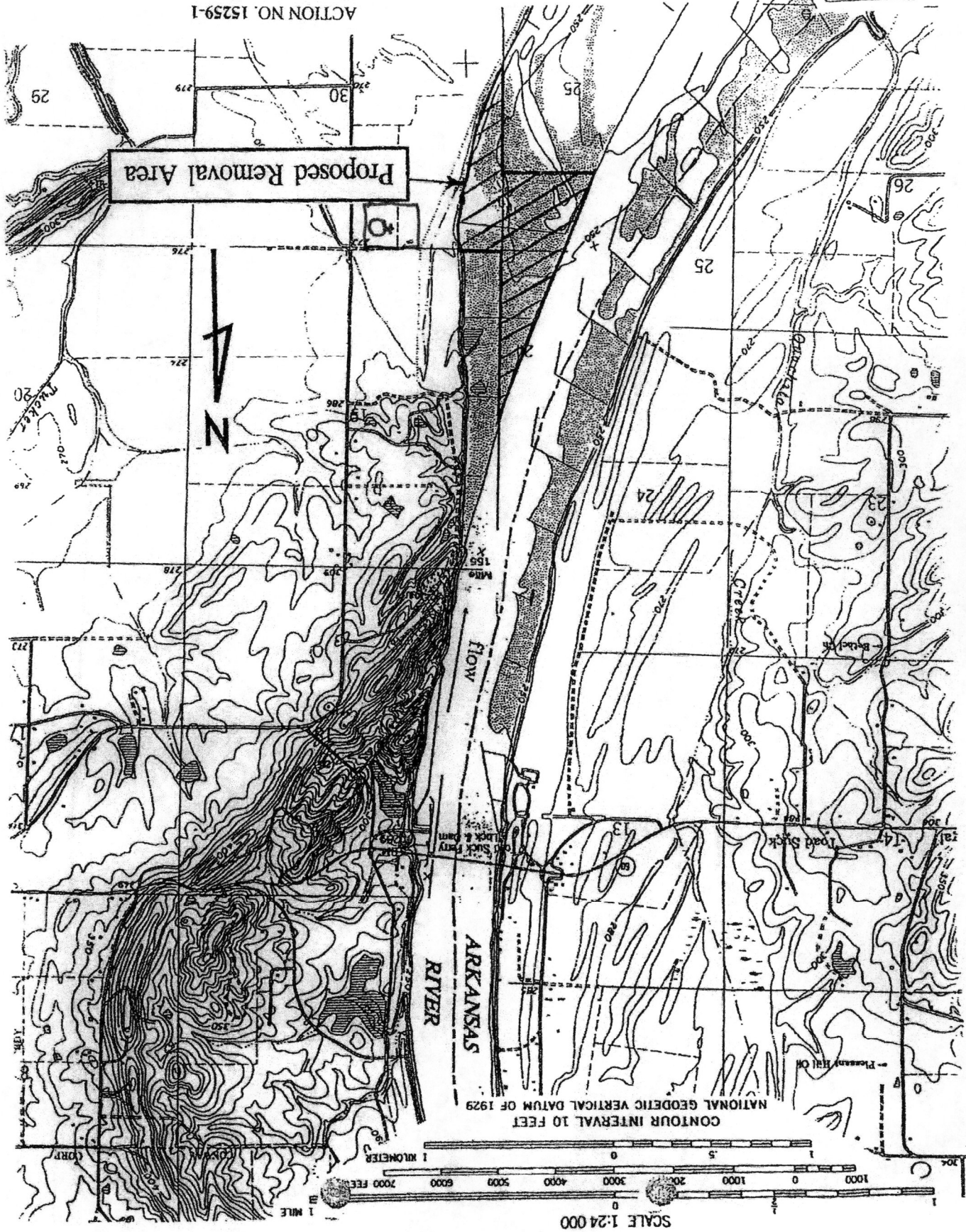

CONTOUR INTERVAL 10 FEET  
NATIONAL GEODETIC VERTICAL DATUM OF 1929

SCALE 1:24 000



Proposed Removal Area

ARKANSAS RIVER

Flow

30  
276  
277

25

24

25

26

23

14

0

1000

2000

3000

4000

5000

6000

7000

8000

9000

10000

1 KILOMETER

1 MILE

0

1

2

3

4

5

6

7

8

9

10

11

12

13

14

15

16

17

18

19

20

21

22

23

24

25

26

27

28

29

30

31

32

33

34

35

36

37

38

39

40

41

42

43

44

45

46

47

48

49

50

51

52

53

54

55

56

57

58

59

60

61

62

63

64

65

66

67

68

69

70

71

72

73

74

75

76

77

78

79

80

81

82

83

84

85

86

87

88

89

90

91

92

93

94

95

96

97

98

99

100

101

102

103

104

105

106

107

108

109

110

111

112

113

114

115

116

117

118

119

120

121

122

123

124

125

126

127

128

129

130

131

132

133

134

135

136

137

138

139

140

141

142

143

144

145

146

147

148

149

150

151

152

153

154

155

156

157

158

159

160

161

162

163

164

165

166

167

168

169

170

171

172

173

174

175

176

177

178

179

180

181

182

183

184

185

186

187

188

189

190

191

192

193

194

195

196

197

198

199

200

201

202

203

204

205

206

207

208

209

210

211

212

213

214

215

216

217

218

219

220

221

222

223

224

225

226

227

228

229

230

231

232

233

234

235

236

237

238

239

240

241

242

243

244

245

246

247

248

249

250

251

252

253

254

255

256

257

258

259

260

261

262

263

264

265

266

267

268

269

270

271

272

273

274

275

276

277

278

279

# ARKANSAS DEPARTMENT OF ENVIRONMENTAL QUALITY DISCLOSURE STATEMENT

## Instructions for the Completion of this Document:

- A. Individuals, firms or other legal entities with no changes to an ADEQ Disclosure Statement, complete items 1 through 5 and 18.
- B. Individuals who never submitted an ADEQ Disclosure Statement, complete items 1 through 4, 6, 7, and 16 through 18.
- C. Firms or other legal entities who never submitted an ADEQ Disclosure Statement, complete 1 through 4, and 6 through 18.

If Not Submitting by ePortal, Mail Original to:

ADEQ

DISCLOSURE STATEMENT

[List Proper Division(s)]

5301 Northshore Drive

North Little Rock, AR 72118-5317

1. APPLICANT: (Full Name)

LENTZ SAND AND GRAVEL, LLC

2. MAILING ADDRESS (Number and Street, P.O.Box Or Rural Route) :

194 SARDIS ROAD

3. CITY, STATE, AND ZIPCODE:

MOKRILTON, ARKANSAS 72110

4a. Applicant Type:

Individual  Corporate or Other Entity

4b. Reason for Submission:

Permit  License  Certification  Operational Authority

New Application  Modification  Renewal Application (If no changes from previous disclosure statement, complete number 5 and 18.)

4c. Division:

Air  Water  Hazardous Waste  Regulated Storage Tank  Mining  Solid Waste

5. Declaration of No Changes:

The violation history, experience and credentials, involvement in current or pending environmental lawsuits, civil and criminal, have not changed since the last Disclosure Statement that was filed with ADEQ on NO CHANGES

**6. Describe the experience and credentials of the Applicant, including the receipt of any past or present permits, licenses, certifications or operational authorization relating to environmental regulation. (Attach additional pages, if necessary.)**

**7. List and explain all civil or criminal legal actions by government agencies involving environmental protection laws or regulations against the Applicant \* in the last ten (10) years including:**

1. Administrative enforcement actions resulting in the imposition of sanctions;
2. Permit or license revocations or denials issued by any state or federal authority;
3. Actions that have resulted in a finding or a settlement of a violation; and
4. Pending actions.

(Attach additional pages, if necessary.)

\* Firms or other legal entities shall also include this information for all persons and legal entities identified in sections 8-16 of this Disclosure Statement.

**8. List all officers of the Applicant. (Add additional pages, if necessary.)**

NAME: \_\_\_\_\_ TITLE: \_\_\_\_\_

STREET: \_\_\_\_\_

CITY, STATE, ZIP: \_\_\_\_\_

NAME: \_\_\_\_\_ TITLE: \_\_\_\_\_

STREET: \_\_\_\_\_

CITY, STATE, ZIP: \_\_\_\_\_

NAME: \_\_\_\_\_ TITLE: \_\_\_\_\_

STREET: \_\_\_\_\_

CITY, STATE, ZIP: \_\_\_\_\_

**9. List all directors of the Applicant. (Add additional pages, if necessary.)**

NAME: \_\_\_\_\_ TITLE: \_\_\_\_\_

STREET: \_\_\_\_\_

CITY, STATE, ZIP: \_\_\_\_\_

NAME: \_\_\_\_\_ TITLE: \_\_\_\_\_

STREET: \_\_\_\_\_

CITY, STATE, ZIP: \_\_\_\_\_

NAME: \_\_\_\_\_ TITLE: \_\_\_\_\_

STREET: \_\_\_\_\_

CITY, STATE, ZIP: \_\_\_\_\_

**10. List all partners of the Applicant. (Add additional pages, if necessary.)**

NAME: \_\_\_\_\_ TITLE: \_\_\_\_\_

STREET: \_\_\_\_\_

CITY, STATE, ZIP: \_\_\_\_\_

NAME: \_\_\_\_\_ TITLE: \_\_\_\_\_

STREET: \_\_\_\_\_

CITY, STATE, ZIP: \_\_\_\_\_

NAME: \_\_\_\_\_ TITLE: \_\_\_\_\_

STREET: \_\_\_\_\_

CITY, STATE, ZIP: \_\_\_\_\_

**11. List all persons employed by the Applicant in a supervisory capacity or with authority over operations of the facility subject to this application.**

NAME: \_\_\_\_\_ TITLE: \_\_\_\_\_

STREET: \_\_\_\_\_

CITY, STATE, ZIP: \_\_\_\_\_

NAME: \_\_\_\_\_ TITLE: \_\_\_\_\_

STREET: \_\_\_\_\_

CITY, STATE, ZIP: \_\_\_\_\_

NAME: \_\_\_\_\_ TITLE: \_\_\_\_\_

STREET: \_\_\_\_\_

CITY, STATE, ZIP: \_\_\_\_\_

12. List all persons or legal entities, who own or control more than five percent (5%) of the Applicant's debt or equity.

NAME: \_\_\_\_\_ TITLE: \_\_\_\_\_

STREET: \_\_\_\_\_

CITY, STATE, ZIP: \_\_\_\_\_

NAME: \_\_\_\_\_ TITLE: \_\_\_\_\_

STREET: \_\_\_\_\_

CITY, STATE, ZIP: \_\_\_\_\_

NAME: \_\_\_\_\_ TITLE: \_\_\_\_\_

STREET: \_\_\_\_\_

CITY, STATE, ZIP: \_\_\_\_\_

13. List all legal entities, in which the Applicant holds a debt or equity interest of more than five percent (5%).

NAME: \_\_\_\_\_ TITLE: \_\_\_\_\_

STREET: \_\_\_\_\_

CITY, STATE, ZIP: \_\_\_\_\_

NAME: \_\_\_\_\_ TITLE: \_\_\_\_\_

STREET: \_\_\_\_\_

CITY, STATE, ZIP: \_\_\_\_\_

NAME: \_\_\_\_\_ TITLE: \_\_\_\_\_

STREET: \_\_\_\_\_

CITY, STATE, ZIP: \_\_\_\_\_

14. List any parent company of the Applicant. Describe the parent company's ongoing organizational relationship with the Applicant.

NAME: \_\_\_\_\_

STREET: \_\_\_\_\_

CITY, STATE, ZIP: \_\_\_\_\_

Organizational Relationship:

15. List any subsidiary of the Applicant. Describe the subsidiary's ongoing organizational relationship with the Applicant.

NAME: \_\_\_\_\_

STREET: \_\_\_\_\_

CITY, STATE, ZIP: \_\_\_\_\_

Organizational Relationship:



16. List any person who is not now in compliance or has a history of noncompliance with the environmental laws or regulations of this state or any other jurisdiction and who through relationship by blood or marriage or through any other relationship could be reasonably expected to significantly influence the Applicant in a manner which could adversely affect the environment.

NAME: \_\_\_\_\_ TITLE: \_\_\_\_\_

STREET: \_\_\_\_\_

CITY, STATE, ZIP: \_\_\_\_\_

NAME: \_\_\_\_\_ TITLE: \_\_\_\_\_

STREET: \_\_\_\_\_

CITY, STATE, ZIP: \_\_\_\_\_

17. List all federal environmental agencies and any other environmental agencies outside this state that have or have had regulatory responsibility over the Applicant.

**18. VERIFICATION AND ACKNOWLEDGEMENT**

The Applicant agrees to provide any other information the director of the Arkansas Department of Environmental Quality may require at any time to comply with the provisions of the Disclosure Law and any regulations promulgated thereto. The Applicant further agrees to provide the Arkansas Department of Environmental Quality with any changes, modifications, deletions, additions or amendments to any part of this Disclosure Statement as they occur by filing an amended Disclosure Statement.

**DELIBERATE FALSIFICATION OR OMISSION OF RELEVANT INFORMATION FROM DISCLOSURE STATEMENTS SHALL BE GROUNDS FOR CIVIL OR CRIMINAL ENFORCEMENT ACTION OR ADMINISTRATIVE DENIAL OF A PERMIT, LICENSE, CERTIFICATION OR OPERATIONAL AUTHORIZATION.**

**COMPLETE THIS SECTION ONLY IF SUBMITTING OTHER THAN BY EPORTAL:**

I, ROBERT LENTZ, certify under penalty of law that this document and all attachments were prepared under my direction or supervision in accordance with a system designed to assure that qualified personnel properly gather and evaluate the information submitted. Based on my inquiry of the person or persons who manage the system, or those persons directly responsible for gathering the information, the information submitted is, to the best of my knowledge and belief, true, accurate, and complete. I am aware that there are significant penalties for submitting false information, including the possibility of fines and imprisonment for knowing violation.

APPLICANT  
SIGNATURE:

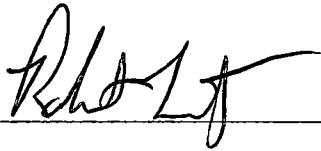

TITLE:

VICE PRESIDENT

DATE:

# **INSTRUCTIONS FOR DISCLOSURE STATEMENT**

Arkansas Code Annotated Section 8-1-106 requires that all applicants for the issuance, or transfer of any permit, license, certification or operational authority issued by the Arkansas Department of Environmental Quality (ADEQ) file a disclosure statement with their applications. The filing of a disclosure statement is mandatory. No application can be considered complete without one.

Disclosure statement means a written statement by the applicant that contains:

- The full name and business address of the applicant and all affiliated persons;
- The full name and business address of any legal entity in which the applicant holds a debt or equity interest of at least five percent (5%) or that is a parent company or subsidiary of the applicant, and a description of the ongoing organizational relationships as they may impact operations within the state;
- A description of the experience and credentials of the applicant, including any past or present permits, licenses, certifications, or operational authorizations relating to environmental regulation;
- A listing and explanation of any civil or criminal legal actions by government agencies involving environmental protection laws or regulations against the applicant and affiliated persons in the ten (10) years immediately preceding the filing of the application, including administrative enforcement actions resulting in the imposition of sanctions, permit or license revocations or denials issued by any state or federal authority, actions that have resulted in a finding or a settlement of a violation, and actions that are pending;
- A listing of any federal environmental agency and any other environmental agency outside this state that has or has had regulatory responsibility over the applicant; and
- Any other information the Director of the Arkansas Department of Environmental Quality may require that relates to the competency, reliability, or responsibility of the applicant and affiliated persons.

## **Exemptions:**

The following persons or entities are not required to file a disclosure statement:

- Governmental entities, consisting only of subdivisions or agencies of the federal government, agencies of the state government, counties, municipalities, or duly authorized regional solid waste authorities as defined by § 8-6-702. (This exemption shall not extend to improvement districts or any other subdivision of government which is not specifically instituted by an act of the General Assembly.)
- Applicants for a general permit to be issued by the department pursuant to its authority to implement the National Pollutant Discharge Elimination System for storm water discharge.
- If the applicant is a publicly held company required to file periodic reports under the Securities and Exchange Act of 1934 or a wholly owned subsidiary of a publicly held company, the applicant shall not be required to submit a disclosure statement, but shall submit the most recent annual and quarterly reports required by the Securities and Exchange Commission which provide information regarding legal proceedings in which the applicant has been involved. The applicant shall submit such other information as the director may require that relates to the competency, reliability, or responsibility of the applicant and affiliated persons.

## **Exemptions continued:**

The following permits, licenses, certifications, and operational authorizations are also exempt from submitting a disclosure statement:

- **Hazardous Waste Treatment, Storage, and Disposal Permit Modifications (Class 1, 2, and 3), as defined in Arkansas Pollution Control and Ecology Commission (APC&EC) Regulation 23;**
- **Phase 1 Consultants, as defined in APC&EC Regulation 32;**
- **Certifications for Operators of Commercial Hazardous Waste Facilities, as defined in APC&EC Regulation 23 § 264.16(f);**
- **Regulated Storage Tank Contractor or Individual License Renewals as defined in APC&EC Regulation 12;**
- **Certifications for Persons Operating and Maintaining Underground Storage Tank Systems which Contain Regulated Substances, as defined in APC&EC Regulation 12.701, *et. seq.*;**
- **Individual Homeowners seeking coverage under General Permit ARG5500000;**
- **Wastewater Operator Licenses, as defined in APC&EC Regulation 3;**
- **Water Permit Modifications for permits issued under the authority of the Arkansas Water and Air Pollution Control Act (Ark. Code Ann. §8-4-101, *et. seq.*);**
- **Solid Waste Permit Modifications for permits issued under APC&EC Regulation 22;**
- **Solid Waste Landfill Operator License Renewals, as defined in Regulation No. 27;**
- **Air Permit Modifications for permits issued under APC&EC Regulations 18, 19, and 26; and**
- **Asbestos Certification Renewals, as defined in Regulation 21.**

**Deliberate falsification or omission of relevant information from disclosure statements shall be grounds for civil or criminal enforcement action or administrative denial of a permit, license, certification, or operational authorization.**

Lentz Sand & Gravel, LLC  
194 Sardis Road  
Morrilton, AR 72110

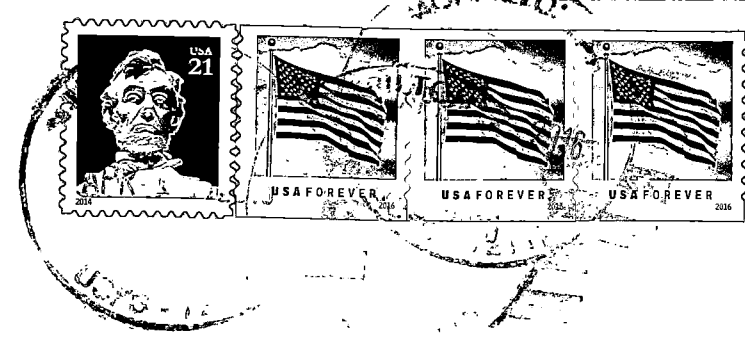

Arkansas Department of  
Environmental Quality  
Water Division – Enforcement Branch  
5301 Northshore Drive  
North Little Rock, AR 72118-5317

