

MINUTE ORDER NO. 80-35

PAGE 1 OF 1 PAGES

~~Based on the results of the water analysis of the monitoring wells near the
Fulton Sanitary Landfill, the high chert content of the soils, the abundance
of solution channel ways in the underlying limestone and the requirement for
three (3) feet of compacted clay liner, the Department recommends that Permit
No. S-0115 be extended until January 1, 1981, with no extension to be considered
beyond this date.~~

COMMISSIONERS

[Handwritten signatures]

[Handwritten signature]

SUBMITTED BY:

John D. Ward

DATE PASSED:

5/23/80

Chronological History of Permit Extensions for the
Fulton Sanitary Landfill #2 Permit No. S-0115

Original permit issued July 22, 1977; Restricted to
twelve (12) months operation

July 29, 1978 - extended to November 1, 1978 with provision
of extension for life of fill volume if leachate problem
resolved and landfill operated in compliance.

November 21, 1978 - Extended to January 1, 1980

March 14, 1980 - Extended to May 23, 1980 with provision of
submission of approvable plans by May 2.

PERMIT APPLICATION SUMMARY

1. Name of Applicant Lynn Fulton Address P.O. Box 207, Rogers, AR 72756
2. Name of Facility Fulton Sanitary Landfill
3. Engineer/Firm Crafton, Tull & Associates Address Rogers, Arkansas
4. Application Date This A.P. is to reinstate S-0115
5. Site Location Portion SW⁴SE⁴Section 29, NW⁴NE⁴Section 32, Township 20 North,
Range 29 West, Benton County, Arkansas
6. Operation Trench and area fill landfill
7. Residences Within $\frac{1}{2}$ Mile Approximately 54 hours. See attached map
8. Water Supplies Within Vicinity Private wells and public water supply - see attached map
9. Soils/Groundwater No permanent groundwater aquifer found within the depths tested
by the soils lab.
10. Drainage Sequence See attached map.
11. Hearing Date. ----- Dept. Represented ----- Remarks -----
12. Recommended Additional Permit Provisions 1) a three foot clay liner will be placed
over all areas of residual soil, including bottom and sides of all fill areas. This
liner will be constructed so as to meet the recommendations and specifications as set
forth in paragraph two, page six of McClelland Engineers, Inc. report LR80-055 dated
April 22, 1980. 2) a minimum of 3 additional monitoring wells will be installed.
13. Summary Comments Based primarily upon the following, the staff recommends that the
operation of the disposal site be extended to January 1, 1980 and that during this
time, the applicant find a more suitable site: 1) Pollution of the monitoring wells.
2) High ~~sh~~ert content of the soils, 3) Abundant solution channel ways in the
underlying limestone as indicated by the substantial loss of drill mud, 4) Require-
ment of 3' compacted clay liner.

Approval Recommended _____ Engineer Robert R. Dorsey Date _____

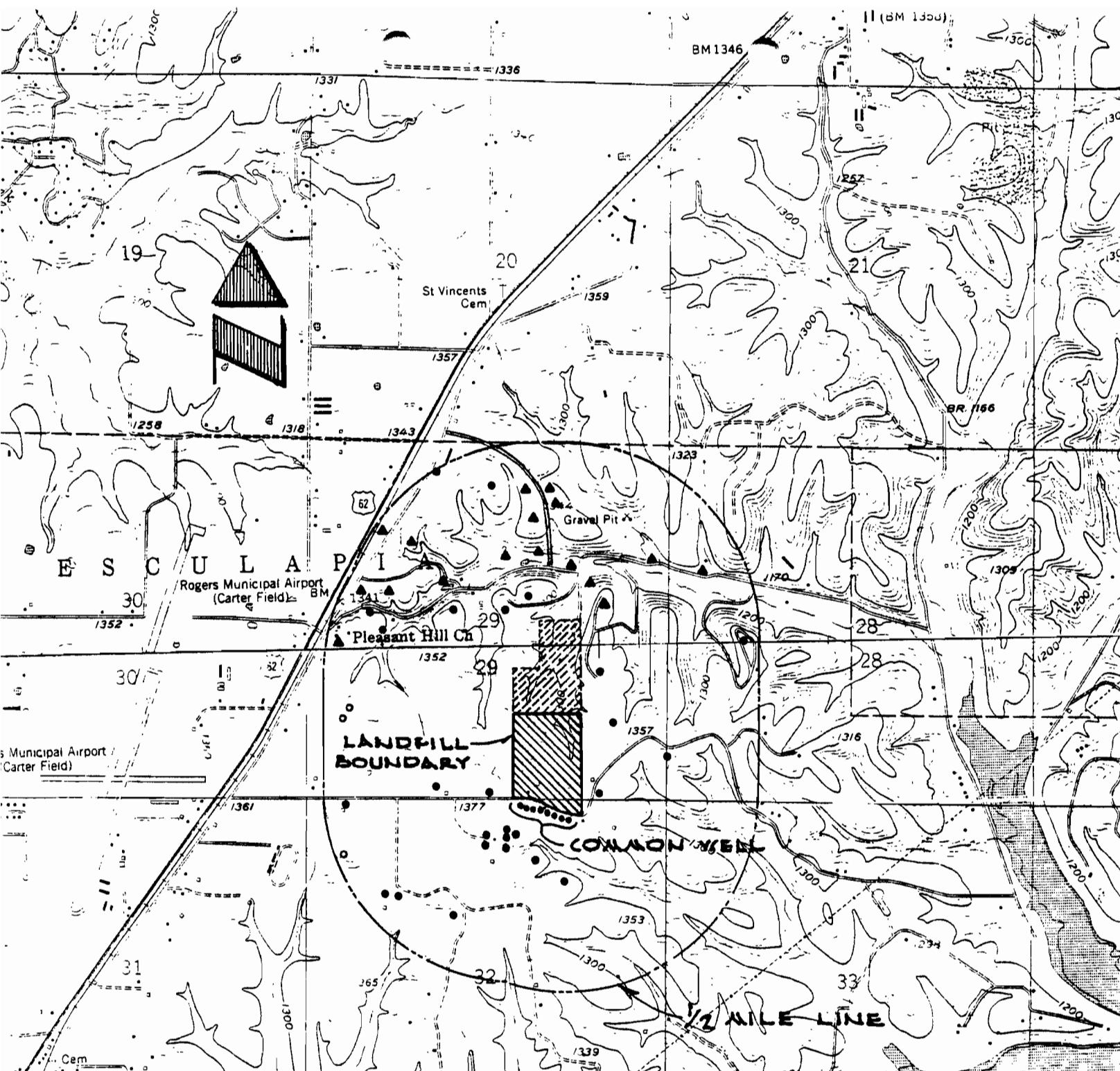

**FULTON SANITARY LANDFILL
HOUSE LOCATIONS WITHIN
1/2 MI. OF BOUNDARY**

KEY

- ▲ HOUSE WITH BENTON CO. WATER DISTRICT NO. 1 SERVICE AVAILABLE
- HOUSE WITH NO WATER SUPPLY
- HOUSE WITH PRIVATE WELL



**CRAFTON, TULL &
ASSOCIATES, INC.**
CONSULTING ENGINEERS ROGERS, ARK.

MAY 1980

SCALE 1 IN. = 2,000 FT

77146

WATER ANALYSIS

Project: Fulton Sanitary Landfill Owner: Fulton Sanitation

Location: Approx. 3 mi. N/E of Rogers 224 North First Street
 Description P.O. Box Street
Benton County, Arkansas Rogers, Arkansas 72756
City, County, State City, State, Zip

Sampled by	Bill Rolth	Bill Rolth	Bill Rolth			
Sample Source	Well No.1	Well No.2	Well No.3			
Sample Date	5/2/80	5/2/80	5/2/80			
Test Date	See Below	See Below	See Below			
pH (2)	9.3	11.1	6.9			
BOD (2)	32	11	35			
Total Solids (5)	190	554	406			
Chloride (5)	42.5	25.25	42.5			
Alkalinity (2)	44	558	297			
Total Hardness (2)	48	454	224			
Sulfide (2)	0.017	0.018	0.038			
Sulfate (2)	25.3	31.4	11.6			
COD (5)	183	58	81			
Copper (5)	< 0.04	0.05	0.08			
Zinc (5)	0.05	< 0.02	0.03			
Iron (5)	0.3	0.21	2.86			
Manganese (5)	0.07	< 0.03	1.85			
Lead (5)	< 0.1	< 0.1	< 0.1			
Sodium (5)	36	30	37			
Total Chromium (7)	< 0.04	< 0.04	< 0.04			
Cadmium (7)	< 0.01	< 0.01	< 0.01			

Test Dates
 (2) = May 2, 1980
 (5) = May 5, 1980
 (7) = May 7, 1980

B-1

Laboratory report forms are attached

All test results are reported in mg/l except pH.

PERMIT
FOR THE CONSTRUCTION AND/OR OPERATION
OF A SOLID WASTE DISPOSAL
FACILITY

Permit No. S-0115

Date July 22, 1977

TO: Mr. Lynn Fulton
Fulton Sanitary Landfill #2
Post Office Box 207
Rogers, Arkansas 72756

LOCATION: S-29 and 32, T-20N, R-29W

ENGINEER: McGoodwin, Williams, Yates
Fayetteville

This permit is your authority to construct and/or operate the Solid Waste Disposal Facility set forth in your application dated ~~September 24, 1975~~. This permit is issued pursuant to and subject to the provisions of the Arkansas Solid Waste Management Act (Act 237 of 1971; Sec. 82-2701 et seq., Ark. Stats.), hereinafter called the "Act", the Arkansas Solid Waste Disposal Code, hereinafter called the "Code", and all other applicable rules and regulations of the Department of Pollution Control and Ecology, hereinafter called "Department", and the following terms and conditions:

1. The disposal facility shall be constructed, maintained, and operated in accordance with the final plans and specifications as approved by the Department and in compliance with all applicable provisions of the Act, the Code, and all other applicable rules and regulations.
2. This permit shall automatically terminate unless construction of the disposal facility has been commenced within 1A month(s) of the date hereof and completed with all reasonable diligence. The Department shall be notified in writing when the disposal facility has been completed in order that it may be inspected.
3. The disposal facility shall be operated by qualified personnel and maintained in good operating condition at all times.
4. This permit may be revoked or modified whenever, in the opinion of the Department, the facilities are no longer in compliance with the Act, the Code, and applicable rules and regulations. This permit shall not relieve the permittee, its agents or employees, from compliance with all provisions of the Act and the Code.
5. Nothing herein contained shall be construed as releasing the permittee from any liability for damage to persons or property by reason of the installation, maintenance, or operation of the disposal facility.
6. This permit is issued in reliance upon the statements and representations made in the application and the plans and specifications and the Department has no responsibility for the adequacy or proper functioning of the disposal facility.
7. RESTRICTION: Permit to operate this facility is limited to twelve (12) months.

Approved:

COMMISSION ON POLLUTION CONTROL & ECOLOGY

By

Billy Frank

Chairman

DEPARTMENT OF POLLUTION CONTROL & ECOLOGY

By

S. L. Davis

Director