

# Mayflower Pipeline Incident Update

June 28, 2013

## Current Response Status/Activities

### Neighborhood

- Have completed hydro-vacing around utilities between #20 and #24
- Covering excavation along driveway of #50 – have contacted fence contractor
- Awaiting sample results from #50

### Main Street

- No change - continue monitoring and maintenance activities

### 365

- Have completed hydro-vacing small area near 365 along creek where small amount of oil was found

### Cove

- Continue monitoring and maintenance, including airboat pom-pom operations
- Working to finalize boom removal strategy – replacing skirt boom south of willows

### Attachments

- Northwoods Air Sampling Results/Meetings with Homeowners
- Northwoods Excavation Plan/Update

MDW 06/27/13

# Mayflower Pipeline Incident Update

June 28, 2013

## Key Incident Statistics

### Solid Waste Summary (original response)

	Soil	Debris	Wood Chips	Vac Boxes	Total
Conway	0	1	0	0	1
Landfill	433	315	281	79	1108
Total	433	316	281	79	1109

Have generated additional roll offs from maintenance activities (hydro vacuuming)

### Solid Waste Summary (recent residential remediation)

	Soil	Debris	Wood Chips	Vac Boxes	Total
(EMES)	25	0	0	0	25
Landfill	11	0	0	0	11
Left	16	0	0	0	16

Awaiting sample results prior to disposal

### Oil/Liquids Summary (number of fracs)

	Total Fracs	Frac Shipped	Frac Left
Oil/water to Rineco	26	26	0
Decon water to Rineco	8	8	0
Oil/water to BRRF	38	38	0
Total oil/water	72	72	0

Note: 37 drums of decon water bottoms have been sent to Rineco

## Mayflower Pipeline Incident Update

**June 28, 2013**

## Northwoods Subdivision

Updated: 6/27/13

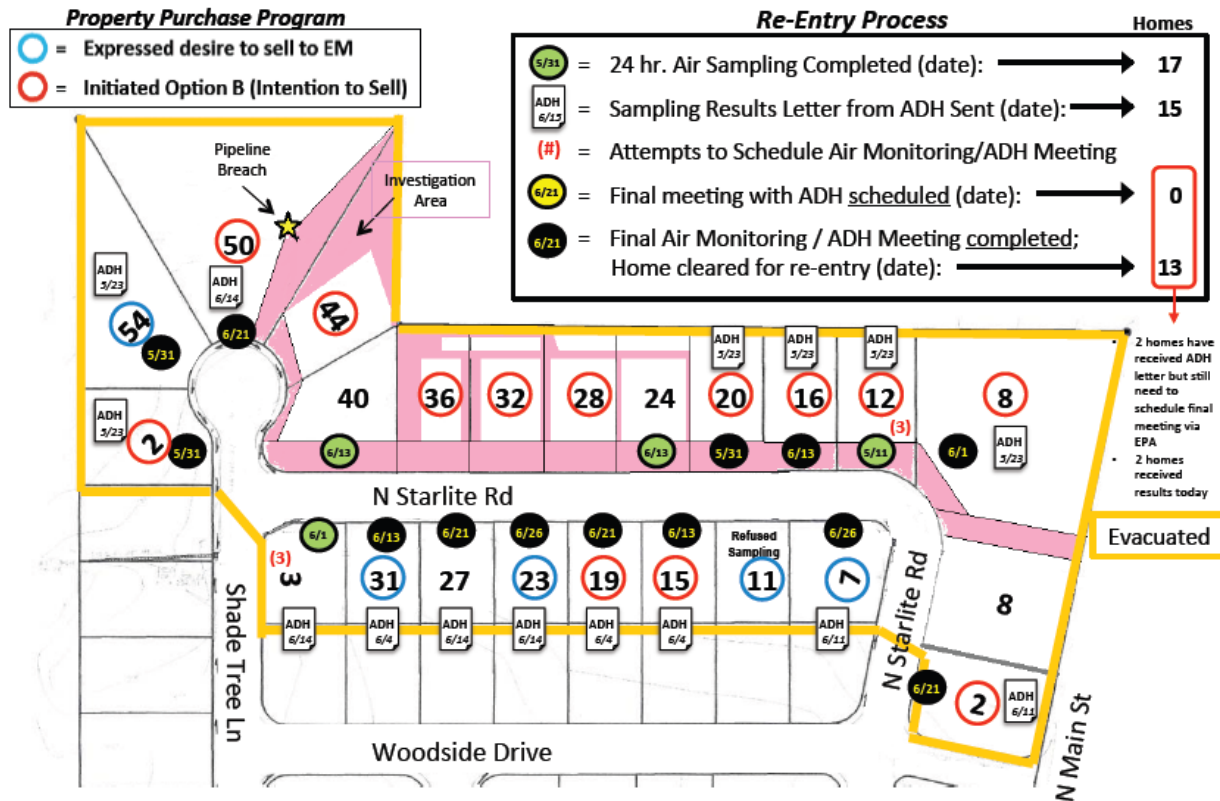

# Mayflower Pipeline Incident Update

June 28, 2013

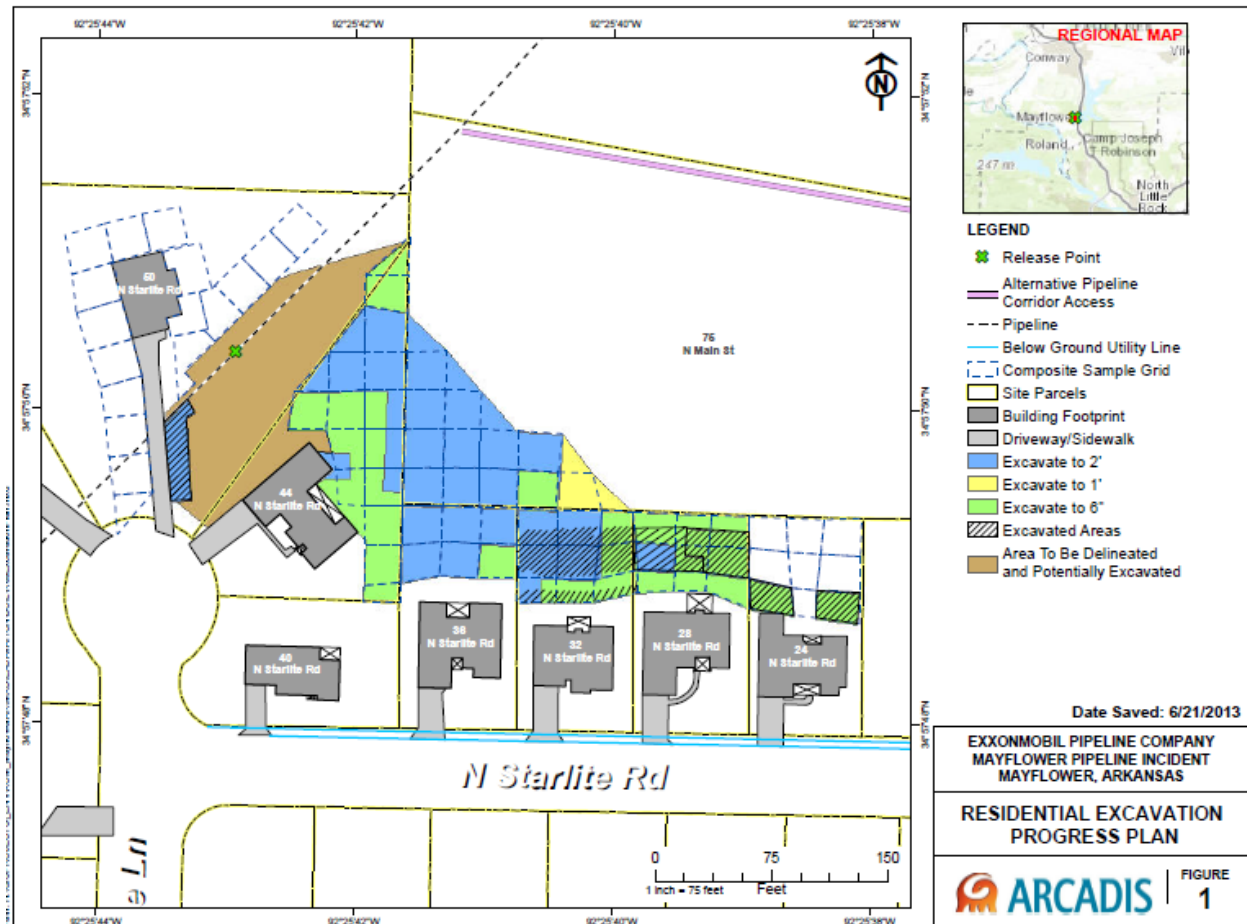

- Completed side/front yard sampling for 28 N. Starlite. Est'd grid for sampling at 32 N. Starlite.
- Performed excavation activities at 32 N. Starlite.
- Supported pot-holing and inspection of utilities east of 24 N. Starlite. No oil or sheen observed.
- Currently awaiting sampling results of additional potholing/excavation activity conducted at 24 and 50 N. Starlite.