



DIVISION OF
ENVIRONMENTAL QUALITY

126375

Sarah Huckabee Sanders
GOVERNOR

Shane E. Khoury
SECRETARY

6/26/2023

Jerry Coleman
General Manager
BFI Waste Systems of Arkansas
1911 W 65th St
Little Rock, AR 72209

RE: Inspection conducted on June 14, 2023
AFIN 63-00155
Permit Number 0261-S1-R3

Dear Mr Coleman,

The Arkansas Division of Environmental Quality Office of Land Resources (DEQ) conducted a routine inspection of your facility pursuant to the Arkansas Solid Waste Management Act (Arkansas Code, Annotated, § 8-6-201 *et seq.*), of 1971, as amended, the Arkansas Pollution Control & Ecology Commission Regulation 22 (Solid Waste Management), and the above-referenced permit. The inspection identified conditions at your facility which the DEQ alleges are violations. A copy of the inspection report is attached.

You should immediately initiate actions to correct the alleged violations cited. A written response of the corrective actions taken, or to be taken, must be submitted within thirty (30) calendar days from the date on this letter to the attention of Kim Davenport. The response may include, but is not limited to, photographs, copies of disposal receipts, records, or analytical results, as applicable. If you have any questions regarding the alleged violations, please do not hesitate to contact me at (501) 682-0586 or Kimberly.Davenport@arkansas.gov.

Sincerely,

A handwritten signature in blue ink, appearing to read "Kim Davenport".

Kim Davenport
Solid Waste Inspector

cc: Nicholas Jones P.E., Senior Operations Manager, Office of Land Resources

**Division of Environmental Quality
Office of Land Resources
Class 1 Landfill Inspection Form**

Site Name	BFI Waste Systems of Arkansas	County	Saline	AFIN	63-00155
Facility Address	18511 W Sardis Road, Bauxite, AR	Phone #	859-227-3861 (Jerry Coleman) 901-873-8334 (Brad Zimmerman)	Permit #	0261-S1-R3
Permittee Address	18511 W Sardis Road, Bauxite, AR	Email Address	jcoleman2@republicservices.com mwinkle@republicservices.com	PDS #	126375
Date	6/14/2023	Entry Time	0745	Exit Time	0925

Operational Standards

Category 1

	Regulation	Item Description	Comments
	417	Access Requirements	
	411(j)	Adequate Provision for Backup Equipment	
	423(b)	Annual Compliance Inspection by Registered Engineer	

Category 2

	Regulation	Item Description	Comments
	411(a)	Operations in Accordance with Permit Documents	
	411(c)	Smallest Practical Area, Unloading Supervised, Single Working Face	
	411(b)	Operations by Licensed On-site Personnel at All Times	
	411(g)	Litter Control Provisions Maintained	
	427	Surface Water Controls	
	411(h)(1)	Contouring Prevents Surface Water Flowing Into or Through Waste	
	418(a)(b)	Run-on/off Control System Present and Adequate	
	411(h)(2)	Surface Water Control Prevents Off-site Sediment Accumulation	
	411(i)	Adequate Maintenance of Intermediate/Final Cover Vegetation	
X	415(a)(1)	Gas Monitoring Program	EGM reports indicate the facility continues to have exceedances greater than twenty-five percent (25%) of the lower explosive limit (LEL) for methane. Refer to included EGM report.
	411(o)	Leachate Leaks or Evidence of Leachate Seepage	
	429	Leachate Collection System	

Category 3

	Regulation	Item Description	Comments
	413(a)(b)(c)	Satisfactory Daily/Alternate/Intermediate Cover	
	419(a)(5)	Cause Discharge/Leachate Leaving Landfill	
	411(f)(3)	Depositing Waste in Standing Water Prohibited	
	411(o)	Erosion or Other Cover Defects Resulting in Exposed Refuse	
	309(c)	Overfill/Off Lined Area	

Records

Date of Last Annual Report	3/31/2023	Date of Last Quarterly Methane Monitoring					
Date of Last Groundwater Monitoring Report	5/26/2023	Previous Quarter Waste Received			78,700.80 Tons		
Operator Name & Number	Spencer Robbins-003765		Signature of Inspector				
Exit Interview Conducted with	Michael Winkle		Method	On-site	Date	6/14/2023	Time 0900



25809 I-30 South
Bryant, AR 72022
P (501) 847-9292
F (501) 847-9210
Terracon.com

June 21, 2023

Office of Land Resources
Division of Environmental Quality
Regulated Waste Operations
5301 Northshore Drive
North Little Rock, AR 72118-5317

ATTN: Ms. Annette Cusher, P.E.
cusher@adeq.state.ar.us

**RE: Second Quarter 2023 Explosive Gas Monitoring
BFI - Saline County Landfill
Terracon Project No. 35237080**

Dear Ms. Cusher:

Enclosed are the results of the Second Quarter 2023 explosive gas monitoring event conducted on June 7, 2023 at the BFI Saline County Landfill (Landfill). Explosive gas monitoring was conducted at the eleven (11) barholes and fifteen (15) gas monitoring probes. Please note the gas measurements for methane at gas monitoring probe GP-1, GP-2, GP-3, GP-13 and GP-15 as well as barhole 7, barhole 8, and barhole 9 reported methane above the 100% Lower Explosive Limit (LEL). Measurements in the remaining barholes and monitoring probes were below regulatory limits for the facility. As part of the nature and extent plan, the explosive gas plan will be revised once the perimeter gas monitoring system has been approved. If you have any questions, please contact either me or David Jaros at (501) 847-9292.

Sincerely,
Terracon Consultants, Inc.

Matt Acree, G.I.T.
Staff Geologist

David Jaros, P.G.
Project Manager

Enclosed: Explosive Gas Monitoring Record Forms for the Second Quarter 2023
Figure 1- Explosive Gas Monitoring Probes, Gas Extraction Wells, and Barhole Locations

cc: Brad Zimmerman - Republic Services
Heath Lockley - Republic Services

BFI - SALINE COUNTY LANDFILL

Second Quarter 2023

Explosive Gas Monitoring Record

DATE: 6/7/2023

MONITORING EQUIPMENT USED: Honeywell BTX II

MONITORING CONDUCTED BY: Wes Williams

WEATHER CONDITIONS (General): Clear, 92°F

Monitoring Point	Performance Criteria	% LEL Methane	O2 Level	Time
GP-1	100% LEL	>100%	2.2	0750
GP-2	100% LEL	>100%	3.9	0758
GP-3	100% LEL	>100%	1.3	0833
GP-4	100% LEL	0%	15.8	0817
GP-5	100% LEL	0%	13.1	0825
GP-6	100% LEL	0%	16.9	0834
GP-7R	100% LEL	0%	19.1	0811
GP-8	100% LEL	0%	18.9	0840
GP-9	100% LEL	0%	14.7	0805
GP-10	100% LEL	0%	16.3	0935
GP-11	100% LEL	0%	11.9	0925
GP-12	100% LEL	0%	8.8	0917
GP-13	100% LEL	>100%	1.6	0910
GP-14	100% LEL	0%	16.1	0857
GP-15	100% LEL	>100%	0.8	0850
Garage	25% LEL	0%	20.9	1025
Weigh Station	25% LEL	0%	20.9	0946
Office Building	25% LEL	0%	20.9	1015
Customer Drop Building	25% LEL	0%	20.9	0955
Storm Shelter	25% LEL	0%	20.9	1004

*Values in **BOLD** exceed Lower Explosive Limit (LEL)

BFI – SALINE COUNTY LANDFILL

Second Quarter 2023

Explosive Gas Monitoring Record

DATE: 6/7/2023

MONITORING EQUIPMENT USED: Honeywell BTX II

MONITORING CONDUCTED BY: Wes Williams

WEATHER CONDITIONS (General): Clear, 92°F

Monitoring Point	Performance Criteria	% LEL Methane	O2 Level	Time
Barhole 1	100% LEL	0%	18.8	1338
Barhole 2	100% LEL	0%	18.6	1345
Barhole 3	100% LEL	0%	20.3	1357
Barhole 4	100% LEL	0%	20.3	1408
Barhole 5	100% LEL	0%	20.1	1418
Barhole 6	100% LEL	0%	20.6	1432
Barhole 7	100% LEL	>100%	7.6	1448
Barhole 8	100% LEL	>100%	17.8	1455
Barhole 9	100% LEL	>100%	15.1	1506
Barhole 10	100% LEL	0%	20.9	1516
Barhole 11	100% LEL	0%	20.9	1527

*Values in **BOLD** exceed Lower Explosive Limit (LEL)

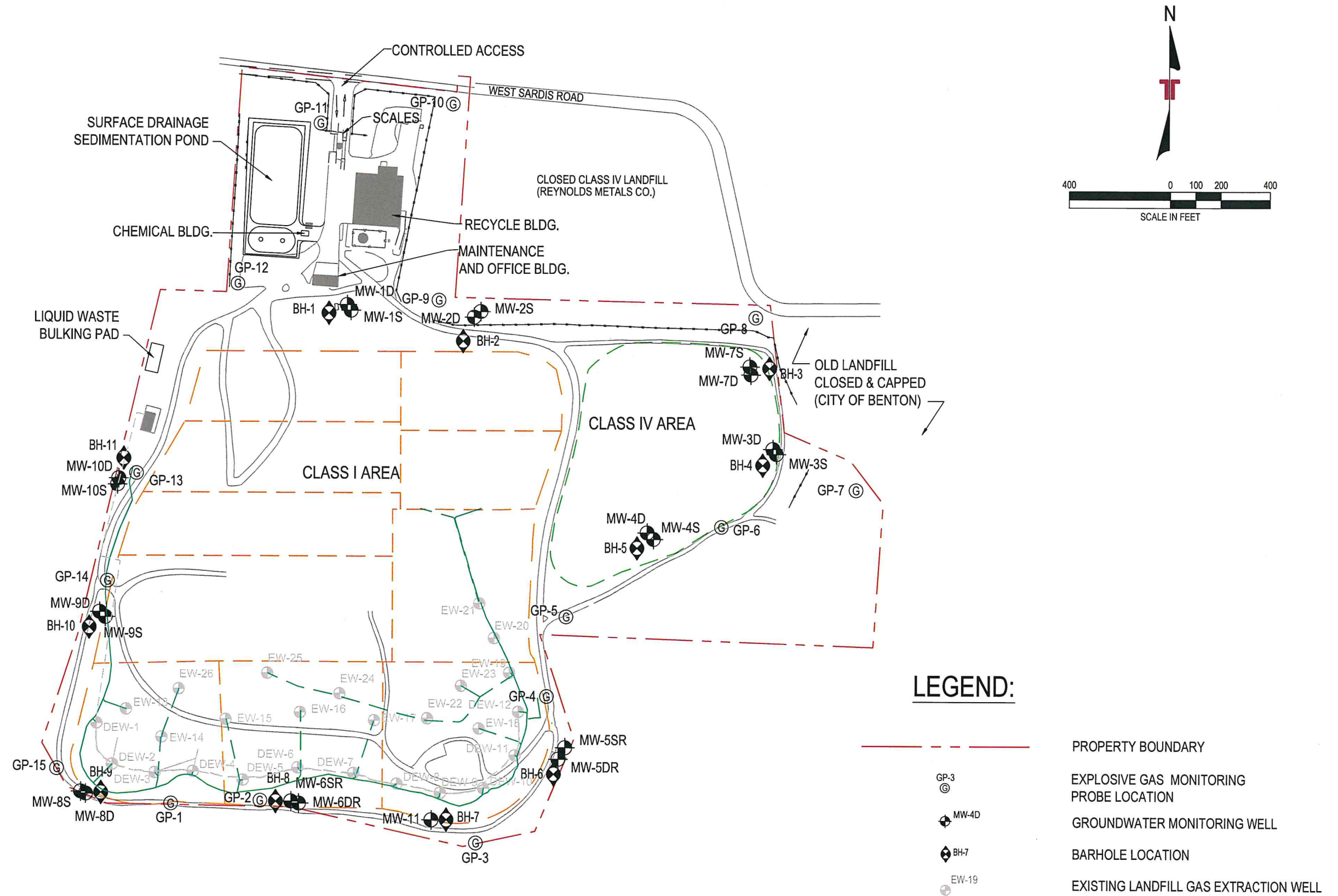

REV.	DATE	BY	DESCRIPTION

Terracon
Consulting Engineers and Scientists

25809 Interstate 30
PH. (501) 847-9292

BRYANT, AR 72022
FAX. (501) 847-9210

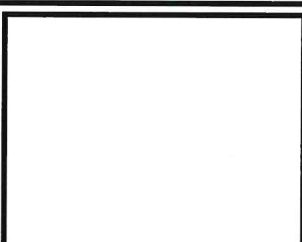

EXPLOSIVE GAS MONITORING PROBE LOCATIONS

BFI WASTE SYSTEMS OF ARKANSAS
SALINE COUNTY LANDFILL

BAUXITE

ARKANSAS

FIGURE 1	
DESIGNED BY:	DGJ
DRAWN BY:	SRE
APPVD. BY:	DGJ
SCALE:	1" = 400'
DATE:	2/08/2018
JOB NO.	055-001-35097141
ACAD NO.	034
SHEET NO.:	OF