

ARG500000 Notice of Intent for Aggregate Facilities

version 1.25

(Submission #: HP7-EZZ7-Y1VM2, version 2)

Details

Submitted	5/24/2021 (1 days ago) by Chet Hiatt
AFIN	66-01779
Reference #	ARG500104
Submission ID	HP7-EZZ7-Y1VM2
Description	Recertification ARG500104- Backbone Quarry
Submission Reason	Renewal
Submission Assigned Staff	Zachary Carroll
Status	In Review

Fees

Annual Permit Fee	\$200.00
Payments/Adjustments	\$0.00
Balance Due	\$200.00 (Due)

Form Input

Common Information

Facility Information

Please provide the following information about the Facility.

Facility Name
Backbone Quarry

North American Industry Classification System (NAICS)

Please provide the NAICS codes and descriptions for your facility.

[Click here to search for and review the NAICS Codes via the Census Bureau NAICS Lookup](#)

Primary NAICS Code and Description

212312

Secondary NAICS Code and Description

NA

Tertiary NAICS Code and Description

NONE PROVIDED

Facility Physical Address**Contact****Prefix**

NONE PROVIDED

First Name

James

Last Name

Kemp

Title

President

Organization Name

River Valley Quarries LLC

Phone Type

Business

Number

9188253370

Extension**Email**

jkemp@kempquarries.com

Fax

NONE PROVIDED

Physical Address

5600 S HIGHWAY 253

HUNTINGTON, AR 72940

Sebastian, United States

Facility Physical Location Latitude and Longitude

35.13226251882263,-94.33185584635565

Facility Mailing Address**Contact****Prefix***NONE PROVIDED***First Name**

James

Last Name*Kemp***Title***President***Organization Name***River Valley Quarries LLC***Phone Type**

Business

Number

9188253370

Extension**Email**

jkemp@kempquarries.com

Fax*NONE PROVIDED***Mailing Address**

PO Box 988

Pryor, OK 74362

United States

Owner Information

Please provide the following information for the owner. If the owner is a corporation it must exactly match the name registered with the Secretary of State. Please use the following link to reference the Secretary of State registered name listing.

[Click here to view the Secretary of State registered name listing](#)

Secretary of State's Filing Number

811007081

Legal Organization

Limited Liability Company

Owner Type

Private Industry

Owner Information**Contact****Prefix***NONE PROVIDED***First Name**

James

Last Name*Kemp***Title***President***Organization Name***River Valley Quarries LLC***Phone Type**

Business

Number

9188253370

Extension**Email**

jkemp@kempquarries.com

Fax*NONE PROVIDED***Owner Address**

PO Box 988

Pryor, OK 74362

United States

Billing Information

Please provide the following information for the Billing contact for this permit application.

Billing Information**Billing Contact****Prefix***NONE PROVIDED***First Name**

Shelia

Last Name*Pilant***Title***Accounts Receiving***Organization Name***River Valley Quarries LLC***Phone Type**

Business

Number

9188253370

Extension**Email**

ar@bentoncountystone.com

Fax*NONE PROVIDED***Billing Address**

PO Box 988

Pryor, OK 74362

United States

Other Information**Permittee (Legal Name)**

River Valley Quarries LLC

State of Incorporation

Arkansas

Facility SIC Code

1422

Current Facility Permit Information

ARG500104; ARR001495; 0098-MQ'; 1916-AGP-135

Consultant Information**Prefix***NONE PROVIDED***First Name**

Chet

Last Name*Hiatt***Title***NONE PROVIDED***Organization Name***NONE PROVIDED***Phone Type**

Business

Number

6202315660

Extension**Email**

triad@triad-es.com

Fax

6202315661

Address

PO Box 1507

Pittsburg, KS 66762

United States

Additional Information*NONE PROVIDED***Geological Description of the Site**

Hilly to mountainous with shallow soils

Driving Directions to Facility

From intersection of Hwy 253 & 45 in Midland, go 3.5 miles on Hwy 253 to the quarry road on the east.

Does this facility intend to dredge or remove sand or gravel from within the submerged portions of a stream or drainage?

No

Is the facility a producer of industrial sand?

No

Discharge Information (1 of 1)**Outfall Number**

001

Estimated Flow (MGD)

<0.10

Map showing Stream Segments and Hydrologic Basin Codes

If you need assistance determining the Stream Segment and/or Hydrologic Basin Code for this location, please use the map at the link provided below.

The Stream Segment is a number followed by a letter.

The Hydrologic Basin Code is a seven or eight digit number.

[Map showing Stream Segments and Hydrologic Basin Codes](#)

Stream Segment

3H

Hydrologic Basin Code

1110201

Outfall Latitude and Longitude

35.134941670793914,-94.32967577889181

Receiving Stream

Unnamed tributary of MacKenay Creek

Effluent Description

Stormwater and small amount of process water from rock washing

Treatment System

Settling in pit

Required Attachments**Topographic Map Attachment**

[Backbone Quarry Rev 2018-SW3P Plan \(2019\).pdf](#) - 03/25/2021 01:44 PM

Comment

NONE PROVIDED

Disclosure Statement (or both 10Q and 10K) Attachment

[disclosure-statement Mar21.pdf](#) - 03/25/2021 02:19 PM

Comment

NONE PROVIDED

Proof of Good Standing

[Arkansas SOS_Proof_Standing.pdf](#) - 04/02/2021 12:52 PM

Comment

NONE PROVIDED

Responsible and Cognizant Official Information

Responsible Official Signatory Requirements

The information contained in this form must be certified by a RESPONSIBLE OFFICIAL as defined below:

Corporation: principal officer at least the level of vice president

Partnership: a general partner

Sole Proprietorship: the proprietor/owner

Municipal, State, Federal, or other public facility: principal executive officer, or ranking elected official

Responsible Official First Name

James

Responsible Official Last Name

Kemp

Responsible Official Job Title

President

Responsible Official Email Address

jkemp@kempquarries.com

Cognizant Official Requirements

A COGNIZANT OFFICIAL is an individual that is given signature authority from the Responsible Official.

Cognizant Official First Name

Chet

Cognizant Official Last Name

Hiatt

Cognizant Official Email Address

triad@triad-es.com

Attachments

Date	Attachment Name	Context	User
5/24/2021 11:53 AM	ARG500104.txt	Submission	Zachary Carroll
5/24/2021 11:53 AM	ARG500104_enforcement.pdf	Submission	Zachary Carroll

Date	Attachment Name	Context	User
5/24/2021 11:50 AM	ePortal cert.PDF	Submission	Zachary Carroll
4/8/2021 9:54 AM	ARG500104_invoice.pdf	Submission	Zachary Carroll
4/2/2021 12:52 PM	Arkansas SOS_Proof_Standing.pdf	Attachment	Chet Hiatt
3/25/2021 2:19 PM	disclosure-statement Mar21.pdf	Attachment	Chet Hiatt
3/25/2021 1:44 PM	Backbone Quarry Rev 2018-SW3P Plan (2019).pdf	Attachment	Chet Hiatt

ARKANSAS DEPARTMENT OF ENVIRONMENTAL QUALITY DISCLOSURE STATEMENT

Instructions for the Completion of this Document:

- A. Individuals, firms or other legal entities with no changes to an ADEQ Disclosure Statement, complete items 1 through 5 and 18.
- B. Individuals who never submitted an ADEQ Disclosure Statement, complete items 1 through 4, 6, 7, and 16 through 18.
- C. Firms or other legal entities who never submitted an ADEQ Disclosure Statement, complete 1 through 4, and 6 through 18.

If Not Submitting by ePortal, Mail Original to:

ADEQ

DISCLOSURE STATEMENT

[List Proper Division(s)]

5301 Northshore Drive

North Little Rock, AR 72118-5317

1. APPLICANT: (Full Name)

River Valley Quarries, LLC

2. MAILING ADDRESS: (Number and Street, P.O.Box Or Rural Route)

3. CITY, STATE, AND ZIPCODE:

P.O. Box 988, Pryor, Oklahoma 74362

4a. Applicant Type:

☐ Individual ☒ Corporate or Other Entity

4b. Reason for Submission:

☒ Permit ☐ License ☐ Certification ☐ Operational Authority

☐ New Application ☐ Modification ☒ Renewal Application (If no changes from previous disclosure statement, complete number 5 and 18.)

4c. Programs:

☐ Air ☒ Water ☐ Hazardous Waste ☐ Regulated Storage Tank ☐ Mining ☐ Solid Waste ☐ Used Tire Program

5. Declaration of No Changes:

The violation history, experience and credentials, involvement in current or pending environmental lawsuits, civil and criminal, have not changed since the last Disclosure Statement that was filed with ADEQ on 1/22/2011

18. VERIFICATION AND ACKNOWLEDGEMENT

The Applicant agrees to provide any other information the director of the Arkansas Department of Environmental Quality may require at any time to comply with the provisions of the Disclosure Law and any regulations promulgated thereto. The Applicant further agrees to provide the Arkansas Department of Environmental Quality with any changes, modifications, deletions, additions or amendments to any part of this Disclosure Statement as they occur by filing an amended Disclosure Statement.

DELIBERATE FALSIFICATION OR OMISSION OF RELEVANT INFORMATION FROM DISCLOSURE STATEMENTS SHALL BE GROUNDS FOR CIVIL OR CRIMINAL ENFORCEMENT ACTION OR ADMINISTRATIVE DENIAL OF A PERMIT, LICENSE, CERTIFICATION OR OPERATIONAL AUTHORIZATION.

COMPLETE THIS SECTION ONLY IF SUBMITTING OTHER THAN BY EPORTAL:

I, James A. Kemp, certify under penalty of law that this document and all attachments were prepared under my direction or supervision in accordance with a system designed to assure that qualified personnel properly gather and evaluate the information submitted. Based on my inquiry of the person or persons who manage the system, or those persons directly responsible for gathering the information, the information submitted is, to the best of my knowledge and belief, true, accurate, and complete. I am aware that there are significant penalties for submitting false information, including the possibility of fines and imprisonment for knowing violation.

APPLICANT
SIGNATURE:

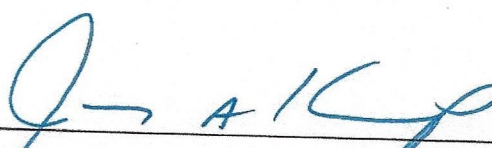

TITLE: President

DATE: 3/24/21

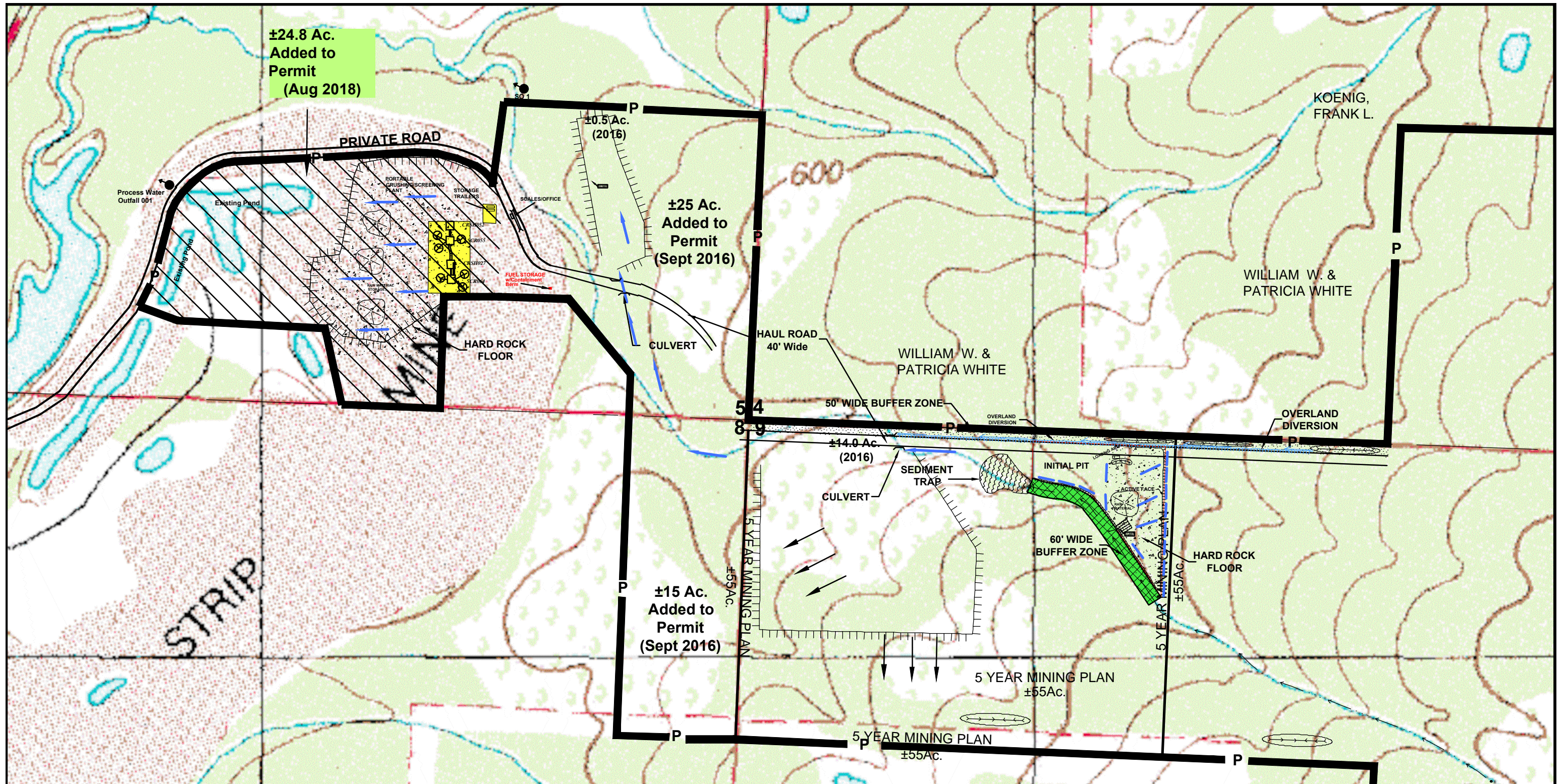

Portions of the Greenwood Quadrangle and Huntington Quadrangle
7.5 Minute Series (Topographical)
Sebastian County, Arkansas

Portions of
Sections 4, 5, 8,
and 9, T5N R31W

E:\Triad Projects\37-03\Backbone Quarry.dwg(SW3P Plan)

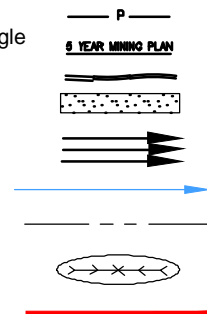

PERMIT BOUNDARY ±245 AC.
5 YEAR MINING PLAN (55 AC.)
HAUL ROAD 40' WIDE
40' WIDE BUFFER ZONE
DIRECTION OF MINING
DIRECTION OF FLOW
SECTION BOUNDARY
STOCKPILES
INITIAL DISTURBANCE AREA (±3.5 AC.)

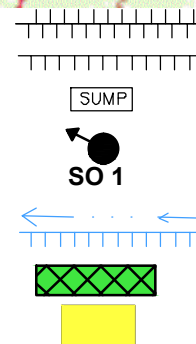

BERM
HIGHWALL
SUMP LOCATION
STORM WATER OUTFALL OR
PROCESS WATER OUTFALL LOCATION
OVERLAND DIVERSION
60' WIDE BUFFER ZONE
EQUIPMENT PARKING/MAINTENANCE AREA

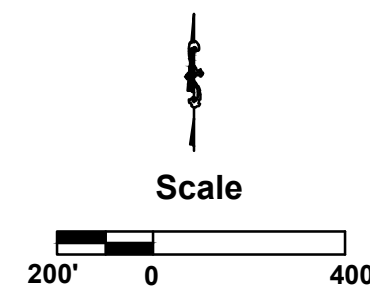

River Valley Quarries, LLC

BACKBONE QUARRY

SWPPP (SITE) MAP

Drawn by
MG

date
3/27/2019

Triad Environmental Services
P.O. Box 1507
Pittsburg, KS 66762
(620) 231-5660 V
(620) 231-5661 F

