

**ARKANSAS DEPARTMENT OF ENVIRONMENTAL QUALITY
NOTICE OF INTENT
INDIVIDUAL TREATMENT FACILITIES
NPDES GENERAL PERMIT ARG550000**

Application Type: New ☒ Renewal ☐ (Permit # ARG55_____)

I. PERMITTEE/OPERATOR INFORMATION

Permittee (Legal Name): Caitlyn Shipley Operator Type:
Permittee Mailing Address: 718 Woody Drive ☐ State ☐ Partnership
Permittee City: Alexander ☐ Federal ☐ Corporation*
Permittee State: AR Zip: 72002 ☒ Sole Proprietorship/Private
Permittee Telephone Number: 479-650-3036 *State of Incorporation: _____
Permittee Fax Number: _____ The legal name of the Permittee must be
Permittee E-mail Address: cmshipley01@gmail.com identical to the name listed with the
Arkansas Secretary of State.

II. INVOICE MAILING INFORMATION (Home owners are exempt.)

Invoice Contact Person: N/A City: _____
Invoice Mailing Company: _____ State: _____ Zip: _____
Invoice Mailing Address: _____ Telephone: _____

III. FACILITY INFORMATION

Facility Name: Shipley Residence Facility Contact Person: Caitlyn Shipley
Facility Address: 718 Woody Drive Telephone Number: 479-650-3036
Facility County: Saline Facility City, State & Zip: Alexander, AR 72002
Facility Latitude: 34°38'7.04"N Facility Longitude: 92°29'18.42"W
Datum
Accuracy: _____ Method: _____ : _____ Scale: _____ Description: _____

IV. DISCHARGE INFORMATION

Outfall Number: 001 Flow: 370 gpd (Gallons per Day)
Stream Segment: 2C Hydrologic Basin Code: 8040203
Outfall Latitude: 34°38'7.04"N Outfall Longitude: 92°29'18.99"W
Datum
Accuracy: _____ Method: _____ : _____ Scale: _____ Description: _____
Type of Treatment: Bio Microbics Microfasst 0.5 with UV and Post Aeration
Receiving Stream: Ouachita River

V. FACILITY PERMIT INFORMATION

NPDES Individual Permit Number (If Applicable): AR00
NPDES General Permit Number (If Applicable): ARG
State Construction Permit Number: _____
NPDES General Construction Stormwater Permit Number (If Applicable): ARR15

WATER DIVISION
5301 NORTHSORE DRIVE / NORTH LITTLE ROCK, ARKANSAS 72118
PHONE 501-682-0623 / FAX 501-682-0880
www.adeq.state.ar.us

VI. OTHER INFORMATION:

Operator Name: David Meints
Operator License Number: 009055 License Class: III

Consultant Contact Name: David Meints
Consultant Email Address: david@meincowastewater.com
Consultant Address: PO Box 1001 City: Bryant State: AR Zip: 72089
Consultant Phone Number: 501-804-0837 Consultant Fax Number: 501-821-4048

Has this treatment system been approved by AHD? Yes ☒ No ☐

Disclosure Statements:

Arkansas Code Annotated Section 8-1-106 requires that all applicants for the issuance or transfer of any permit, license, certification or operational authority issued by the Arkansas Department of Environmental Quality (ADEQ) file a disclosure statement with their applications. The filing of a disclosure statement is mandatory. No application can be considered complete without one. You must submit a new disclosure statement even if you have one on file with the Department. The form may be obtained from ADEQ web site at: http://www.adeq.state.ar.us/disclosure_stmt.pdf.

VII. CERTIFICATION OF OPERATOR

DA (Initial) "I certify that, if this facility is a corporation, it is registered with the Secretary of the State of Arkansas."
DA (Initial) "I certify that the cognizant official designated in this Application is qualified to act as a duly authorized representative under the provisions of 40 CFR 122.22(b). If no cognizant official has been designated, I understand that the Department will accept reports signed only by the Applicant."
DA (Initial) "I certify under penalty of law that this document and all attachments were prepared under my direction or supervision in accordance with a system designed to assure that qualified personnel properly gather and evaluate the information submitted. Based on my inquiry of the person or persons directly responsible for gathering the information, the information submitted is, to the best of my knowledge and belief, true, accurate, and complete. I am aware that there are significant penalties for submitting false information, including the possibility of fine and imprisonment for knowing violations."

Responsible Official Printed Name: Caitlyn Shipley Title: Owner
Responsible Official Signature: [Signature] Date: 3/17/2021
Responsible Official Email: cmshipley01@gmail.com
Cognizant Official Printed Name: David Meints Title: Class III Operator
Cognizant Official Signature: [Signature] Telephone: 501-804-0837
Cognizant Official Email: david@meincowastewater.com

X. PERMIT REQUIREMENT VERIFICATION

Please check the following to verify completion of permit requirements.

	Yes	No	* If No is answered for any of the questions, then a permit can not be issued!
Submittal of Complete NOI?	<input checked="" type="checkbox"/>	<input type="checkbox"/>	
Submittal of Required Permit Fee?	<input type="checkbox"/>	<input checked="" type="checkbox"/>	Check Number: _____
Submittal of AHD Form EHP-19?	<input checked="" type="checkbox"/>	<input type="checkbox"/>	
Submittal of Site Map?	<input checked="" type="checkbox"/>	<input type="checkbox"/>	

WATER DIVISION
5301 NORTHSORE DRIVE / NORTH LITTLE ROCK, ARKANSAS 72118
PHONE 501-682-0623 / FAX 501-682-0880
www.adeq.state.ar.us



Arkansas Department of Health
Environmental Health Protection

Receipt Number

JUN 10 2019

22890280

Individual Onsite Wastewater System Permit Application

Permit Type

- ☐ New Installation
☒ Alteration / Repair

DR Environmental ID #

A D H 1 0 9 7 7 4 9 8

Fee Schedule for Structures		✓
Structures 1500 sq ft or less	\$ 30.00	<input type="checkbox"/>
Structures more than 1500 sq ft and up to 2000 sq ft	\$ 45.00	<input type="checkbox"/>
Structures more than 2000 sq ft and up to 3000 sq ft	\$ 90.00	<input type="checkbox"/>
Structures more than 3000 sq ft and up to 4000 sq ft	\$120.00	<input type="checkbox"/>
Structures more than 4000 sq ft	\$150.00	<input type="checkbox"/>
Alteration and Repair	\$ 30.00	<input checked="" type="checkbox"/>

Part 1 Application

Treatment Type (check one)

Disposal Method (check one)

- ☐ STD = Standard Septic Tank
☐ ISF = Intermittent Sand Filter
☐ PMF = Proprietary Media Filter
☐ OTH = Other (Describe)

- ☒ ATU = Aerobic Treatment Plant
☐ RSF = Re-circulating Sand Filter
☐ RGF = Re-circulating Gravel Filter
☐ HLD = Holding Tank

- ☐ STD = Standard Absorption Field
☒ SUR = Surface Discharge
☐ CPF = Capping Fill
☐ OTH = Other

- ☐ LPD = Low Pressure Distribution
☐ HLD = Holding Tank
☐ SRL = Serial Distribution
☐ DRP = Drip Irrigation

1. Owner's/Applicant's Name

Elder Berganza - *Cartlyn Shipley*

2. Phone Number

501-231-3410

3. Mailing Address

6315 Park Rd. Alexander, AR 72002

4. County

Saline

5. Address of Proposed System (If a 911 address is not available, attach detailed directions or map)
718 Woody Dr. Bryant, AR 72022

6. Subdivision Name

Wood Forest

7. Approval Date

8. Date Recorded

9. Lot Number

Lot 12 & W 15' of 13

10. Lot Dimensions

100x200

11. Total Area (Acres)

.43

12. # Bedrooms # People

3

13. Daily Flow (GPD)

370

14. Brief Legal Description of Property (Attach a separate sheet of paper, if necessary)
Section 12, Township 01-S, Range 14W

15. Water Supply (Specify supplier, if Public Water)
Bryant Water

16. GPS Coordinates

34.635593 / -92.488771

17. Loading Rates

(gpd/ft²)

18. System Specifications

Primary Area	N/A	a. Size of Septic Tank	1000	gal	f. Trench Depth	N/A	inches
Secondary Area	N/A	b. Size of Dose Tank	N/A	gal	g. Trench Spacing	N/A	feet
Percolation Test	(min/in)	c. Absorption Area	N/A	ft ²	h. Trench Media (List Below)	i. Trench Width	
Primary Area Avg	N/A	d. Number of Field Lines	N/A		N/A	N/A	in
Secondary Area	N/A	e. Length of Field Lines	N/A	ft	N/A	N/A	in

TO THE OWNER

The permit for construction may be deemed invalid by the local Environmental Health Specialist before the start of construction, if the site and/or soil conditions have changed after approval of this permit, or if the information within this permit is inaccurate or has been found to be misrepresented. Approval for operation does not constitute a guarantee that the system will function properly. The approval states that the system was designed and installed according to the Arkansas Department of Health, Rules and Regulations Pertaining to Onsite Wastewater Systems, unless there are exceptions or deviations noted in the comments. A Permit for Construction is valid for one (1) year from the date of approval. The authorized agent must revalidate a permit more than one (1) year old prior to the start of any construction.

19. Utilization Verification

I hereby attest that item 12, the number of bedrooms (number of persons for commercial) and square footage of the structure that will utilize the designed individual onsite wastewater system in this permit application, is accurate. I have reviewed the permit application and understand the layout, installation, maintenance, operation and expense(s) that may be associated with this system.

Owner/Applicant Signature

Date

20. I certify that I have conducted the above tests and that the above listed information is in accordance with the latest requirements of the Arkansas Department of Health Rules and Regulations Pertaining to Onsite Wastewater Systems.

Designated Representative Signature

D.R.

Soil Certified ☒ Yes ☐ No

Title

Jason D. Reaves

6.6.19

501-772-4527

Print Name

Date

Phone Number

21. Approval of Health Authority

The information and specifications in the application has been reviewed and found to meet the requirements of the Arkansas Department of Health Rules and Regulations Pertaining to Onsite Wastewater Systems. A PERMIT FOR CONSTRUCTION is hereby issued.

Environmental Specialist Signature

NOTE TO INSTALLER

EHS Number

Date

NOTE TO INSTALLER:
CONTACT EHS AT 501-303-5650
24 HOURS PRIOR TO
BEGINNING INSTALLATION

$1'' = 30'$

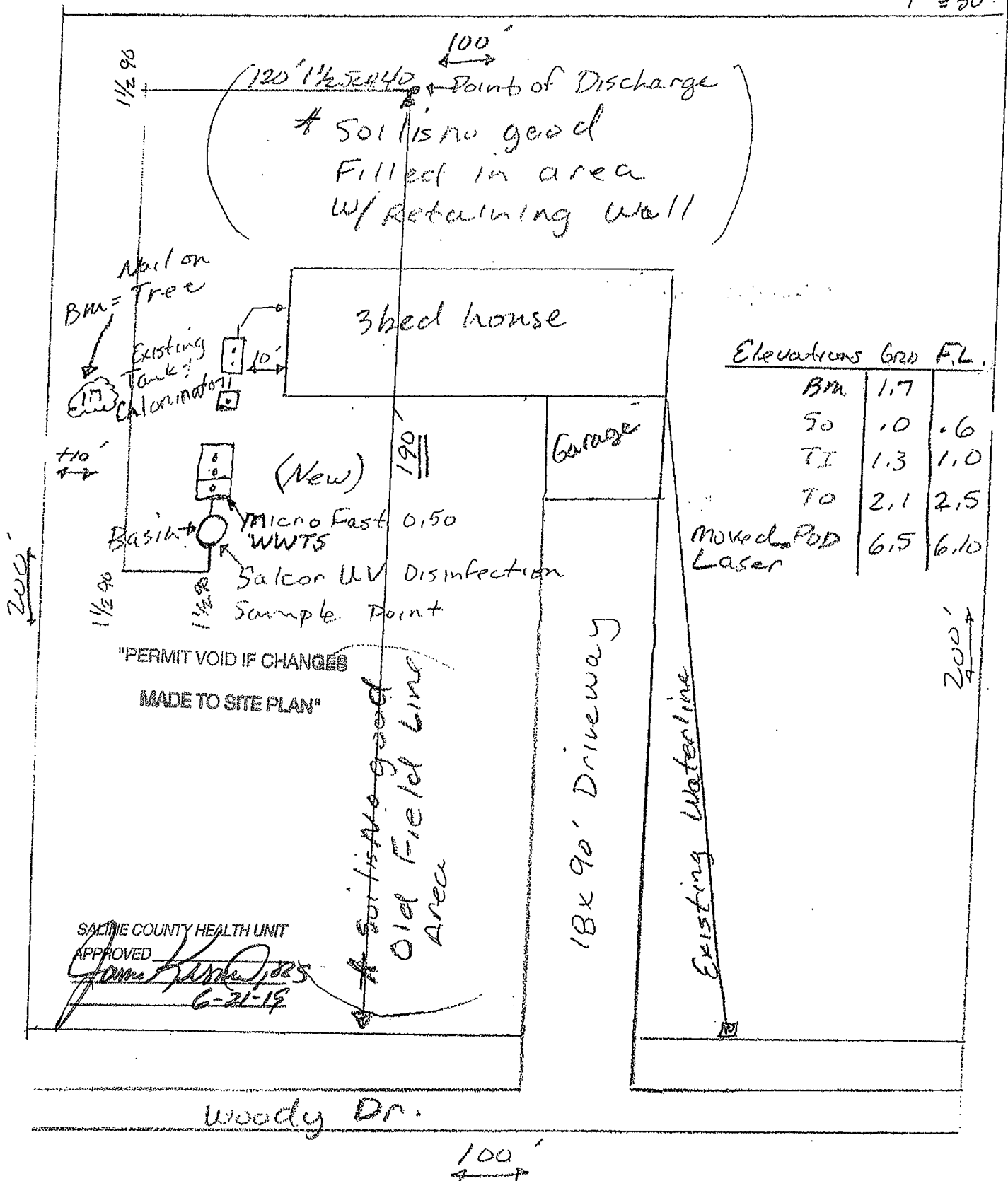

Trusted. Tested. Tough.™

Product information presented here reflects conditions at time of publication. Consult factory regarding discrepancies or inconsistencies.



SECTION: 2.15.080
FM2784
1017
Supersedes
0315

TECHNICAL DATA SHEET DOSE-MATE SERIES Models 151, 152, 153 Effluent Pumps

PRODUCT SPECIFICATIONS

MOTOR	Horse Power	1/3 (151), 4/10 (152), 1/2 (153)
	Voltage	115 or 230
	Phase	1 Ph
	Hertz	60 Hz
	RPM	3450
	Type	Permanent split capacitor
	Insulation	Class B
	Amps	3.0 - 10.5
PUMP	Operation	Automatic or nonautomatic
	Discharge Size	1-1/2" NPT
	Solids Handling	1/2" (12 mm), 3/4" (19 mm) spherical solids
	Cord Length	20' (6 m)
	Cord Type	UL listed power cord
	Max. Head	44' (13.4 m)
	Max. Flow Rate	77 GPM (291 LPM)
	Max. Operating Temp.	130 °F (54 °C)
MATERIALS	Cooling	Oil filled
	Motor Protection	Auto reset thermal overload
	Cap	Cast iron
	Motor Housing	Cast iron
	Pump Housing	Cast iron
	Base	Plastic or cast iron
	Upper Bearing	Sleeve bearing
	Lower Bearing	Ball bearing
	Mechanical Seals	Carbon and ceramic
	Impeller Type	Non-clogging vortex
	Impeller	Engineered thermoplastic
	Hardware	Stainless steel
	Motor Shaft	AISI 1215 steel
	Gasket	Neoprene

NOTE: The sizing of effluent systems normally requires variable level float(s) controls and properly sized basins to achieve required pumping cycles or dosing timers with nonautomatic pumps.

NOTE: See model comparison chart for specific details.

MODEL 151

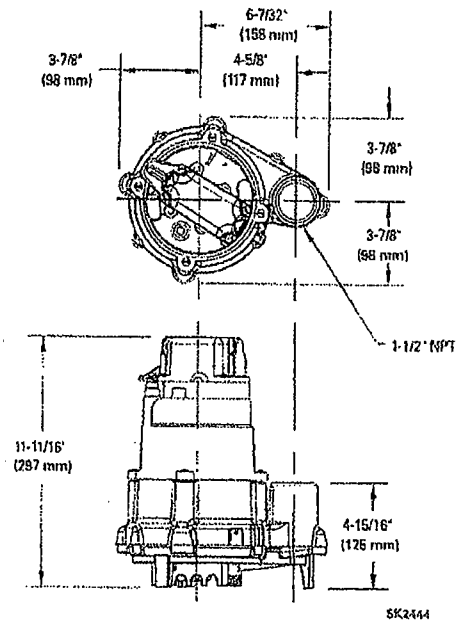

MODELS 152 & 153

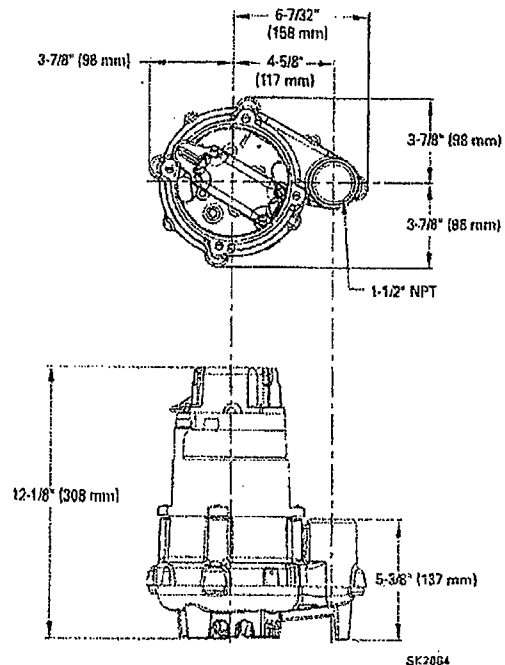

UL
Tested to UL Standard UL 719
and Certified to CSA
Standard CSA22.2 No. 136



© Copyright 2017 Zoeller® Co. All rights reserved.

502-778-2731 | 800-928-7867 | 3649 Cane Run Road | Louisville, KY 40211-1961 | zoellerpumps.com

TOTAL DYNAMIC HEAD FLOW PER MINUTE

MODEL		151		152		153	
Feet	Meters	Gal.	Liters	Gal.	Liters	Gal.	Liters
5	1.5	50	189	69	261	77	291
10	3.0	45	170	61	231	70	265
15	4.6	38	144	53	201	61	231
20	6.1	29	110	44	167	52	197
25	7.6	16	61	34	129	42	159
30	9.1	--	--	23	87	33	125
35	10.7	--	--	--	--	22	85
40	12.2	--	--	--	--	11	42
Shut-off Head:		30 ft. (9.1m)		38 ft. (11.6m)		44 ft. (13.4m)	

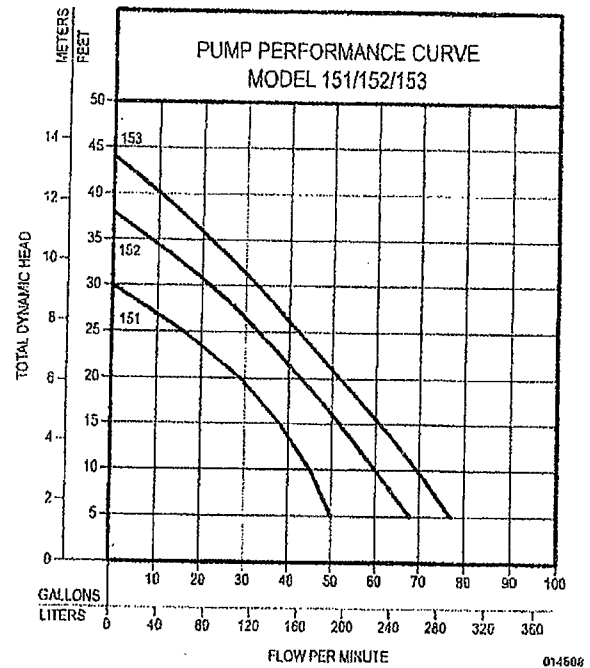

Model	MODEL COMPARISON										
	Seal	Mode	Volts	Ph	Amps	HP	Hz	Lbs	Kg	Simplex	Duplex
N151	Single	Non	115	1	6.0	1/3	60	32	15	1	2 or 3
E151	Single	Non	230	1	3.0	1/3	60	32	15	1	2 or 3
BN151	Single	Auto	115	1	6.0	1/3	60	33	15	*	2 or 3
BE151	Single	Auto	230	1	3.0	1/3	60	33	15	*	2 or 3
N152	Single	Non	115	1	8.5	4/10	60	37	17	1	2 or 3
E152	Single	Non	230	1	4.3	4/10	60	37	17	1	2 or 3
BN152	Single	Auto	115	1	8.5	4/10	60	39	18	*	2 or 3
BE152	Single	Non	230	1	4.3	4/10	60	39	18	*	2 or 3
N153	Single	Non	115	1	10.5	1/2	60	37	17		
BN153	Single	Auto	115	1	10.5	1/2	60	39	18	*	2 or 3
E153	Single	Non	230	1	5.3	1/2	60	37	17	1	2 or 3
BE153	Single	Non	230	1	5.3	1/2	60	39	18	*	2 or 3

*BN and BE models include a 20' (6 m) piggyback variable level pump switch. Additional cord lengths are available in 25' (8 m) and 35' (11 m). 50' (15 m) cords are available for 230V units only.

NOTE: Model 151 has a plastic base. Models 152 & 153 have a cast iron base.

SELECTION GUIDE

- For automatic, use single piggyback variable level float switch or double piggyback variable level float switch. Refer to FM0477.
- See FM1228 for correct model of simplex control panel.
- See FM0712 for correct model of duplex control panel.

OPTIONAL PUMP STAND P/N 10-2421

- Reduces potential clogging by debris
 - Replaces rocks or bricks under the pump
 - Made of durable, noncorrosive ABS
 - Raises pump 2" (5 cm) off bottom of basin
 - Provides the ability to raise intake by adding sections of 1½" or 2" (DN40 or DN50) PVC piping
 - Attaches securely to pump
 - Accommodates sump, dewatering and effluent applications
- NOTE: Make sure float is free from obstruction.

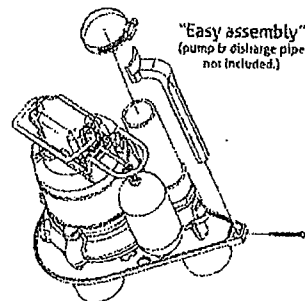

CAUTION

All installation of controls, protection devices and wiring should be done by a qualified licensed electrician. All electrical and safety codes should be followed including the most recent National Electrical Code (NEC) and the Occupational Safety and Health Act (OSHA).

© Copyright 2017 Zoeller® Co. All rights reserved.

502-778-2731 | 800-928-7867 | 3649 Cane Run Road | Louisville, KY 40211-1961 | zoellerpumps.com

A-Series Simplex Alarm Panels

Applications

A-Series Simplex Alarm Panels are used to control pump motors and alarm functions in simplex pumping systems. They are intended as a low-cost option for pump controls into gravity or pressurized drain-fields or for Effluent Sewers (aka STEP sewers or Septic Tank Effluent Pumping Systems), especially where cost is the critical factor.

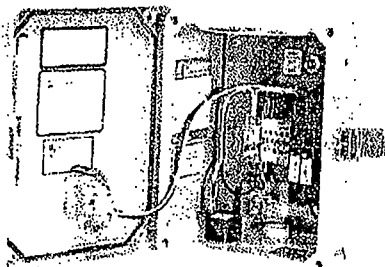

General

Standard features for A-Series Simplex Alarm Panels include circuit breakers, an automatic/manual/off toggle switch, and an audible/visible high water alarm with auto reset. Other standard features and options are listed on page 2. Orenco panels are designed for use with mechanical and/or mercury float switches. Listed per UL 508; a UL-Canada listing is available.

Standard Models

A1, A2.

Product Code Diagram

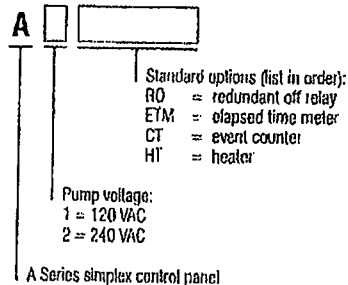

Materials of Construction

Component	Material
Enclosure	UV-resistant fiberglass, Type 4X (IP 66)
Hinge	Stainless steel
Latch	Stainless steel

Specifications

Height, in. (mm)	9.5 (241)
Width, in. (mm)	7.3 (185)
Depth, in. (mm)	5.0 (127)
A1 panel ratings	120 VAC, 1 hp (0.75 kW), 16 A, 1-phase, 60 Hz
A2 panel ratings	240 VAC, 1 hp (0.75 kW), 10 A, 1-phase, 60 Hz

Standard Features

Feature	Specifications*
Controls Circuit Breaker	10 A, OFF/ON switch, single pole, DIN rail mounting with thermal magnetic tripping characteristics
Pump Circuit Breaker	20 A, OFF/ON switch, single pole (120 VAC) or double pole (240 VAC), DIN rail mounting with thermal magnetic tripping characteristics
Auto/Off/Man toggle switch	Single-pole, double-throw HOA switch
Audible alarm	95 dB at 24 in. (610 mm), warble-tone sound; gasketed, UL Type 4X (IP66)
Audible alarm silence relay	Automatic reset, DIN rail mount
Visible alarms	7/8-in. (22-mm) diameter red lens, "Push-to-silence," UL Type 4X (IP66), 1 W bulb, 120 VAC

Optional Features

Feature	Specifications*	Product Code Adder
Redundant off relay(s)	DIN rail mount; provides a secondary off; sounds alarm upon low level condition	RO
Elapsed time meter(s)	120 or 240 VAC (model-dependent), 7-digit, non-resettable; limit of 99,999 hours; accurate to 0.01 hours	ETM
Event counter(s)	120 or 240 VAC (model-dependent), 6-digit, non-resettable	CT
Heater	Anti-condensation heater; self-adjusting; radiates additional wattage as temperature drops	HT

* all voltages are 120 VAC unless otherwise noted

Elder Berganza
 718 Woody Dr.
 Bryant, AR 72022

N
 1" = 30'

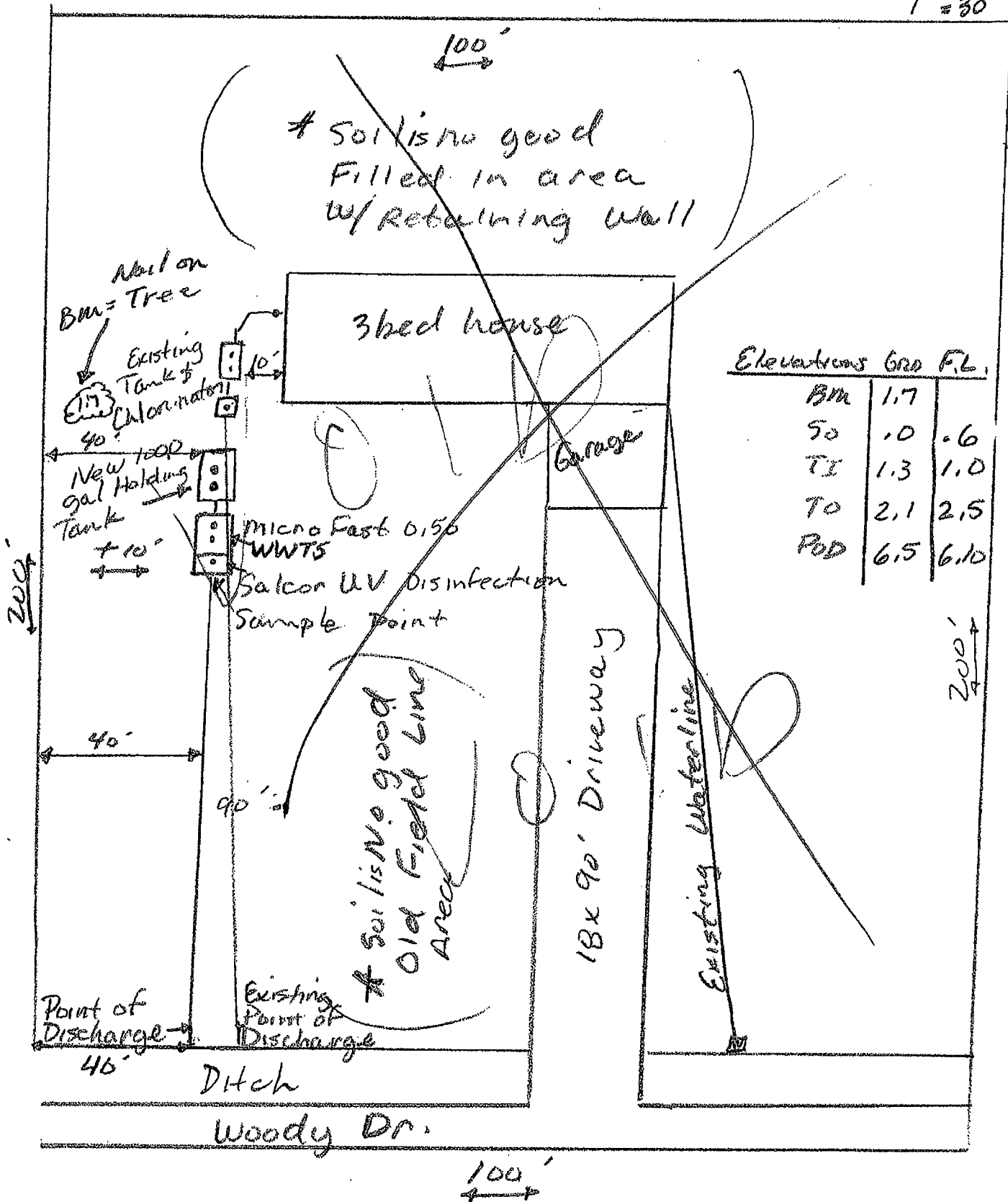

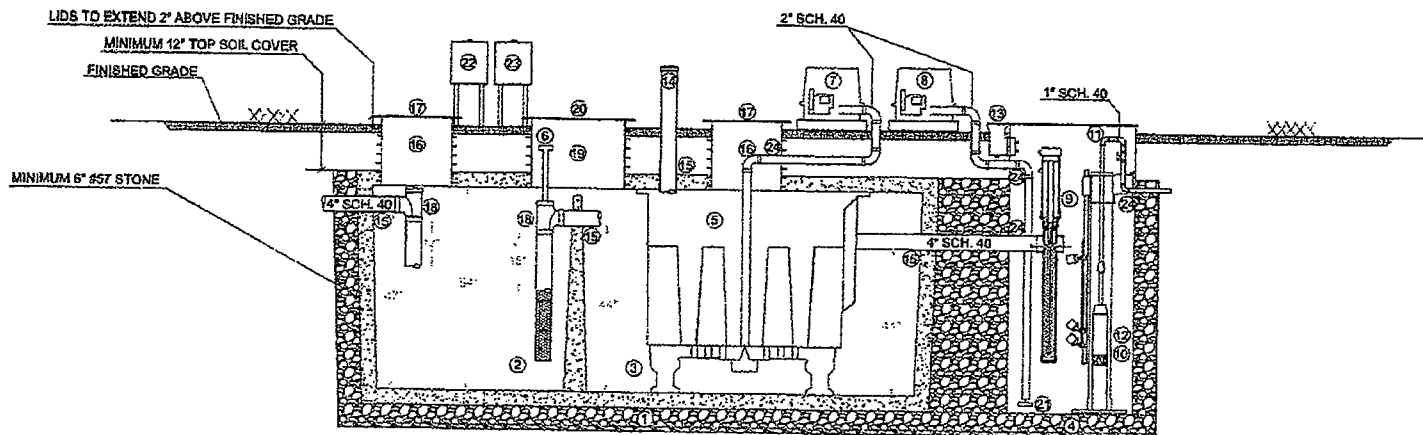

SECTION VIEW

EQUIPMENT AND PARTS LIST

1. WHITTEN CONCRETE TANK OR EQUIVALENT, VOLUME 1500 GALLONS
2. SETTLING TANK, 500 GALLONS
3. TREATMENT TANK VOLUME, 1000 GALLONS
4. STEEL PLASTICS PUMP BASIN, 30" X 72" (STEEL PLASTICS BA30X072TA & CVF30SLDRT) OR EQUIVALENT
5. MICROFAST TREATMENT UNIT, (BIOMICROBICS MFC 0.5)
6. EFFLUENT FILTER, (BIOMICROBICS SANITEE-418)
7. BLOWER, (BIOMICROBICS FUJI 1/2 HP 1PH VCF30) & HOUSING, (BIOMICROBICS 250-BBHSFL)
8. BLOWER, (BIOMICROBICS FUJI 1/2 HP 1PH VCF20) & HOUSING, (BIOMICROBICS 250-BBHSFL)
9. UV DISINFECTION UNIT, (SALCOR 3G)
10. DISCHARGE PUMP, (ORENCO PF100S11) OR EQUIVALENT
11. DISCHARGE ASSEMBLY, 1"
12. UNIVERSAL FLOW INDICER, (ORENCO FIT D 60) OR EQUIVALENT
13. EXTERNAL SPLICE BOX, (ORENCO SB4EX) OR EQUIVALENT
14. VENT CAP, 4", (GIZMO ENGINEERING) OR EQUIVALENT
15. BOOT SEAL, (POLYLOK 3005-CE)
16. RISER, ULTRA-RIB, 18"
17. FIBERGLASS LID, 18", (ORENCO FLD18G) OR EQUIVALENT
18. SANITARY "T", 4" SCHEDULE 40
19. RISER, ULTRA-RIB, 24"
20. FIBERGLASS LID, 24", (ORENCO FLD24G) OR EQUIVALENT
21. DIFFUSER, (FINE BUBBLE, 10 SCFM, 304 SS) OR EQUIVALENT
22. CONTROL PANEL, (BIOMICROBICS 110V AMI)
23. CONTROL PANEL, POST AIR
24. GROMMET, MATCH DIAMETER OF PIPE

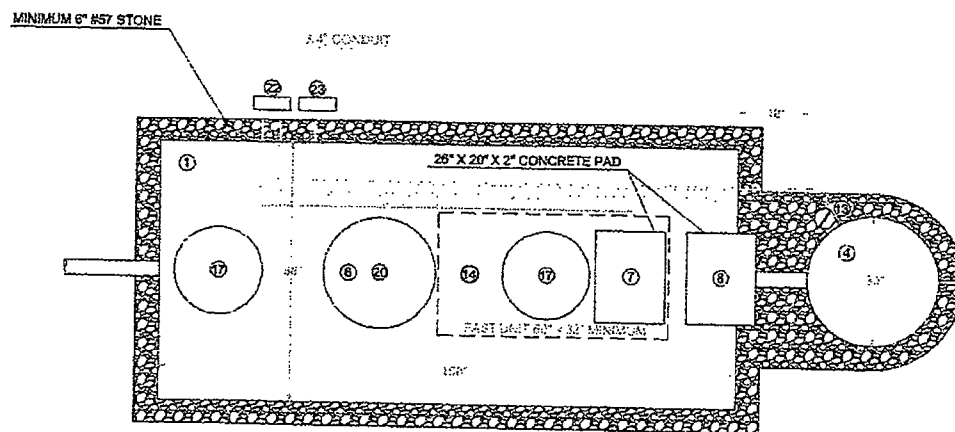

PLAN VIEW

ETS
EPA-90 TECH
SOLUTIONS LLC
PUMP-OUT CONCRETE TANK
TREATMENT SYSTEM
201 404 1174



BIOMICROBICS WASTEWATER
TREATMENT SYSTEM
ADVANCED

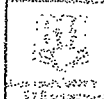

ORENCO
BIOMICROBICS WASTEWATER
TREATMENT SYSTEM
MICRO FAST
FLOW=500 GPD

BIOMICROBICS
WASTEWATER
TREATMENT
SYSTEM
MICRO FAST
FLOW=500 GPD

10-M131

Specifications for MicroFAST 0.50 Wastewater Treatment System

1. GENERAL

The contractor shall furnish and install (1) MicroFAST® 0.50 treatment system as manufactured by Bio-Microbics, Inc. The treatment system shall be complete with all needed equipment as shown on the drawings and specified herein.

The principal items of equipment shall include the FAST® system insert, blower assembly, blower controls and leg extensions or lid. All other items will be provided by others. The MicroFAST 0.50 unit shall be situated within a 450 Gallon [1700L] minimum compartment as shown on the drawings. Suggested maximum settling zone is (1) X the daily flow. Tank must provide adequate pump out access and conform to local, state, and all other applicable codes. The contractor shall coordinate the proper fabrication of the tank between the FAST system and tank supplier with regard to fabrication of the tank, installation of the FAST unit, and delivery to the job site.

2. OPERATING CONDITIONS

The MicroFAST 0.50 treatment system shall be capable of treating the wastewater produced by typical family activities (bath, laundry, kitchen, etc.) ranging from (1) one to (8) eight people and not to exceed 500 US Gallons per day (1800 LPD) provided the waste contains nothing that will interfere with biological treatment. The FAST system is a biological treatment system not meant for non-biodegradable or industrial wastewater.

3. MEDIA

The FAST® media shall be manufactured of rigid PVC, polyethylene, or polypropylene and it shall be supported by the polyethylene insert. The media shall be fixed in position and contain no moving or wearing parts and shall not corrode. The media shall be designed and installed to ensure that sloughed solids descend through the media to the bottom of the septic tank.

4. BLOWER

The MicroFAST 0.50 unit shall come equipped with a regenerative type blower capable of delivering 17-25 CFM [31-46 m3/hr]. The blower assembly shall include an inlet filter with metal filter element. The blower shall be mounted outside the tank on a contractor supplied concrete base. Blower piping to the tank shall use non-corrosive material (PVC, Galvanized, or stainless Steel). Do not run galvanized pipe inside the treatment tank. Refer to Installation Manual for further details.

5. REMOTE MOUNTED BLOWER

The blower shall be placed on a contractor supplied concrete base. The blower must not sit in standing water and its elevation must be higher than the tank and normal flood level. A two-piece, rectangular housing shall be provided. The discharge air line from the blower to the MicroFAST® System shall be provided and installed by the contractor.

6. ELECTRICAL

The electrical source should be within 150 feet [45 meters] of the blower consult local codes for longer wiring distances. All wiring must conform to all applicable codes (IEC, NEC, etc.). Wiring distances must prevent significant voltage loss. Input power on 60Hz electrical systems 110/220VAC, 1Ø, 3.5/1.7 FLA, on 50 Hz electrical systems 220VAC, 1Ø, 1.9 FLA. Other voltages and phase are also available. Actual power consumption varies with site conditions. All conduit and wiring shall be supplied by contractor.

7. CONTROLS

The control panel provides power to the blower and contains an alarm system consisting of a visual and audible alarm capable of signaling blower circuit failure and high water conditions. The control panel is equipped with SFR® (Sequencing Fixed Reactor) timed control feature. A manual alarm silence button is included.

8. INSTALLATION AND OPERATING INSTRUCTIONS

All work must be done in accordance with local codes and regulations. Installation of the FAST 0.50 shall be done in accordance with the written instructions provided by the manufacturer. Manuals shall be furnished, which will include a description of system installation, operation, and maintenance procedures.

9. FLOW AND DOSING

FAST® systems have been successfully designed, tested and certified receiving gravity, demand-based influent flow. When influent flow is controlled by pump or other means to help with highly variable flow conditions, then multiple dosing events should be used to maximize performance. The flow rate shall not exceed 5 gpm (19 Lpm) with a maximum hourly flow not to exceed 10% of the design daily flow (50 gph [190 LPH]).

10. WARRANTY

Bio-Microbics, Inc. warrants all new residential FAST® models (MicroFAST® 0.50, 0.625, 0.75, 0.90, and 1.5) against defects in materials and workmanship for a period of two years after installation or three years from date of shipment which ever occurs first. All other FAST® system models are warranted for a period of one year after installation or eighteen months from date of shipment, whichever occurs first. All are subject to the following terms and conditions below:

During the warranty period, if any part is defective or fails to perform as specified when operating at design conditions, and if the equipment has been installed and is being operated and maintained in accordance with the written instructions provided by Bio-Microbics, Inc., Bio-Microbics, Inc. will repair or replace at its discretion such defective parts free of charge. Defective parts must be returned by owner to Bio-Microbics, Inc.'s factory postage paid, if so requested. The cost of labor and all other expenses resulting from replacement of the defective parts and from installation of parts furnished under this warranty and regular maintenance items such as filters or bulbs shall be borne by the owner. This warranty does not cover general system misuse, aerator components which have been damaged by flooding or any components that have been disassembled by unauthorized persons, improperly installed or damaged due to altered or improper wiring or overload protection. This warranty applies only to the treatment plant and does not include any of the structure wiring, plumbing, drainage, septic tank or disposal system. Bio-Microbics, Inc. reserves the right to revise, change or modify the construction and/or design of the FAST system, or any component part or parts thereof, without incurring any obligation to make such changes or modifications in present equipment. Bio-Microbics, Inc. is not responsible for consequential or incidental damages of any nature resulting from such things as, but not limited to, defect in design, material, or workmanship, or delays in delivery, replacements or repairs.

THIS WARRANTY IS IN LIEU OF ALL OTHER WARRANTIES EXPRESS OR IMPLIED. BIO-MICROBICS SPECIFICALLY DISCLAIMS ANY IMPLIED WARRANTY OF MERCHANTABILITY OR FITNESS FOR A PARTICULAR PURPOSE. NO REPRESENTATIVE OR PERSON IS AUTHORIZED TO GIVE ANY OTHER WARRANTY OR TO ASSUME FOR BIO-MICROBICS, INC., ANY OTHER LIABILITY IN CONNECTION WITH THE SALE OF ITS PRODUCTS. Contact your local distributor for parts and service.

THE INFORMATION CONTAINED IN THIS DRAWING IS THE SOLE PROPERTY OF BIO-MICROBICS INC. ANY REPRODUCTION IN PART OR AS A WHOLE WITHOUT THE WRITTEN PERMISSION OF BIO-MICROBICS INC. IS PROHIBITED. DESIGN AND INVENTION RIGHTS ARE RESERVED. IN THE INTEREST OF TECHNOLOGICAL ADVANCEMENT, ALL PRODUCTS ARE SUBJECT TO DESIGN AND OR MATERIAL CHANGE WITHOUT NOTICE.

BIO-MICROBICS © 2014

DO NOT SCALE

UNLESS NOTED
DIMENSIONS
ARE IN INCHES
[CENTIMETERS]
TOLERANCES
± 0.02 IN/IN
[± 0.05 CM/CM]

BIO-MICROBICS

BETTER WATER. BETTER WORLD™

MicroFAST 0.50 FAST Unit

WEIGHT	lb	SIZE	DRAWING NUMBER	SHEET 3 OF 4
NAME	DATE	A	MicroFAST® 0.50 Specifications	
DRAWN	CTC 12/18/2006			
CHECKED	PF 9/18/2013		REVISED 9/18/2013	
			REV. INI-05-V	

Salcor 3G UV Disinfection Unit

NOTE: Not all dimensions to scale

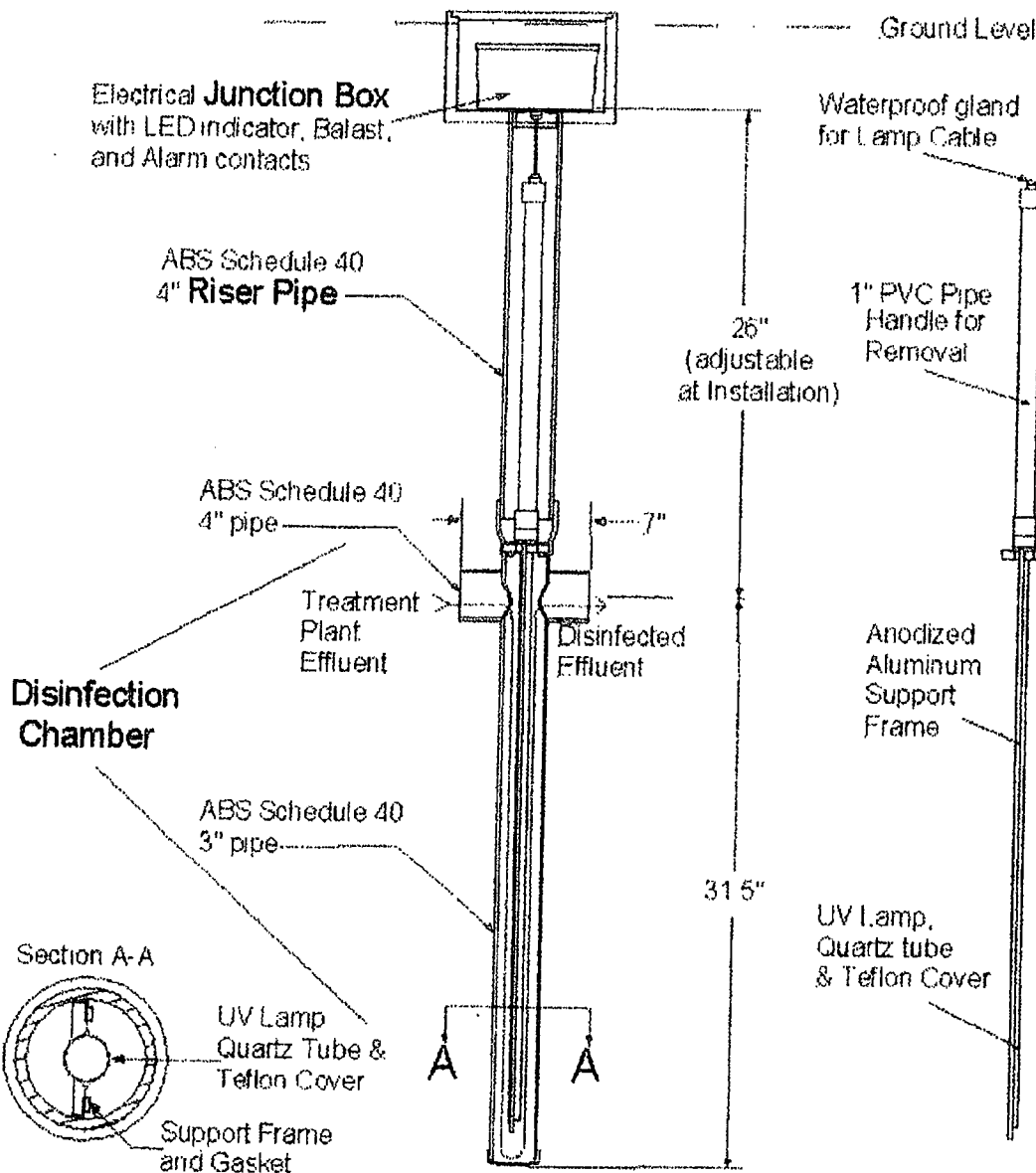

Figure 1

In Ground Installation

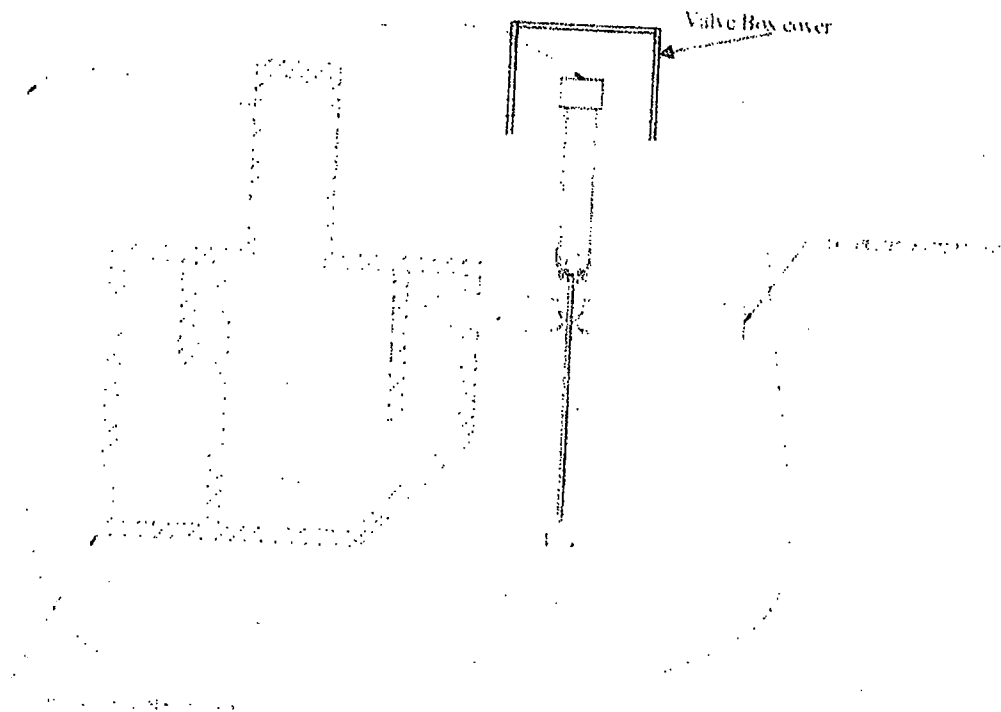

Figure 2

In Tank Installation

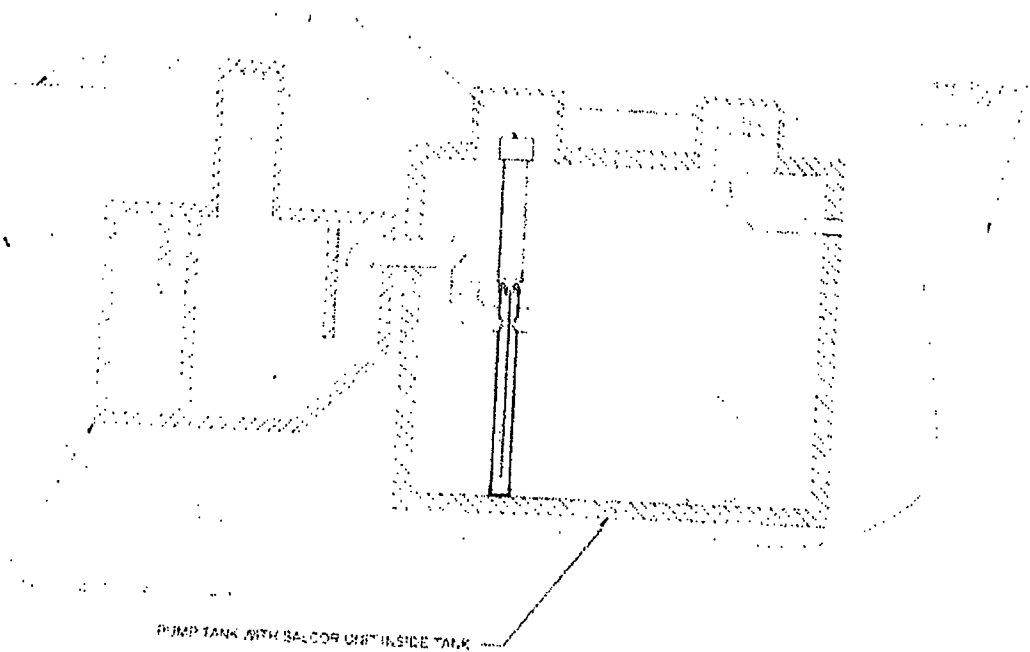

Figure 3

SALCOR INC.

P.O Box 1090
Fallbrook, Ca. 92088
Telephone: 760 731 0745

V. ELECTRICAL JUNCTION BOX LID

The Ballast and terminal strips are now mounted on the Alarm Board, mounted to the Junction Box Lid.

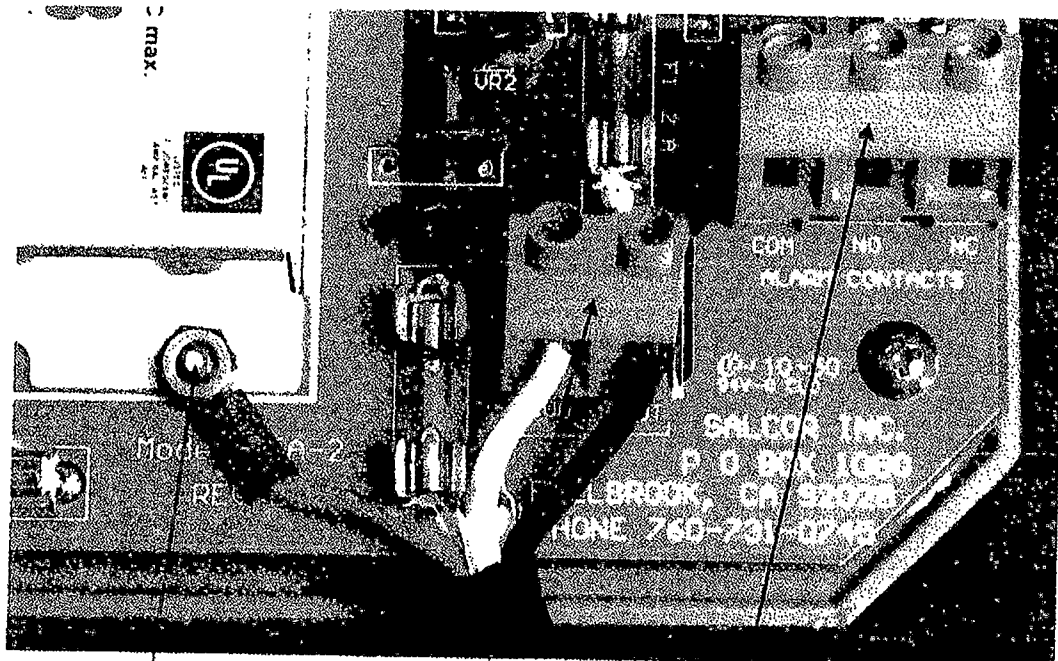

Grounding Post

Power Inlet Terminal

Alarm Wire terminal block.
Connect alarm wires as needed
for your specific circuit.
N O and N-C describes the contact
configuration when the
relay has **NO POWER** applied,
or it is **NOT** energized.

Figure 4

SERVICE AND MAINTENANCE CONTRACT

1. **Parties.** This contract ("Agreement" or "Contract") is between Meinco Septic Systems, Inc., ("Meinco") and Elder Berganza, ("Client"), referred to individually as a "Party" and collectively as the "Parties."
2. **Service Location.** This is a Contract for septic system service and maintenance services provided by Meinco for Client located at 718 Woody Drive, Bryant, Arkansas 72022 hereinafter referred to as the "Service Site."
3. **Service Fees.** Client agrees to pay Meinco Ninety Dollars (\$ 90.00) for septic system service and maintenance specifically work performed every Three Months (Quarterly) and described more specifically below (hereinafter referred to as "Service Work"). Meinco and Client agree that the invoiced amount is good consideration for this Contract and the services set forth below and reflects the bargained for terms of this agreement.
4. **Materials Charges.** During regular maintenance Meinco will replace materials necessary to keep the septic system operating efficiently (chlorine tablets, UV light bulbs, floats, filters, etc.). Meinco and Client agree that Meinco shall submit to client the costs of maintenance parts and materials and Client will promptly pay the same.
5. **Laboratory Fees.**
 - A) ☐ This paragraph is inapplicable.
 - B) ☒ Client agrees that Meinco will use a third party laboratory, Environmental Services, Inc. for any sampling that is required under this Contract. In such event, Meinco shall submit to Client a laboratory fee of \$ 125.00 and Client will promptly pay the same.
6. **Services Provided.** Meinco agrees to provide the following Service Work to the Client and the Service Site:
 - A) Maintenance requirements, including review of system components and their working condition, monitoring of solid levels to determine system efficiency, and periodic cleaning of system filters or media.
 - B) I. ☒ This paragraph is inapplicable.
 II. ☐ Necessary sampling and submission of paperwork every month(s) or as required to comply with the Arkansas Department of Health Onsite Maintenance Program.
 - C) Necessary paperwork every 6 month(s) as required to comply with the Arkansas Department of Health and/or the Arkansas Department of Environmental Quality.
 - D) I. ☐ This paragraph is inapplicable.
 II. ☒ Sampling of discharge every 6 month(s) in coordination with a 3rd party laboratory for required laboratory tests.
7. **Contract Duration.** This contract shall be for a period of 24 month(s) from the date this Contract is executed by the parties on page 2
8. **Flow Requirements.** This contract shall be null and void if septic system flow exceeds 370 gallons per day.
9. **Modification to System.** If the septic system is modified, abused, mis-used, or altered, then Meinco's responsibility to service or maintain the septic system is terminated. Meinco may remedy such conditions by replacing parts or correcting defects. If Meinco makes such changes to the septic system, then it may charge to client the costs of repairs, modifications, parts, and labor. Meinco may, at its discretion, seek payment in advance of making any repairs or modifications to the septic system. In such event, Meinco shall not be responsible for any damage or adverse effects for its delay in making repairs or modifications to the septic system.
10. **Access to System.** Client agrees to provide Meinco access to the septic system as well as its parts and components.
11. **Termination by Client.** Client may terminate this contract by providing thirty (30) days written notice to Meinco.
12. **Termination by Meinco.** Notwithstanding, and in addition to, any other provision or term in this Contract, **MEINCO MAY TERMINATE THIS CONTRACT AT ANY TIME AND WITHOUT PREVIOUS NOTICE TO CLIENT.**
13. **Solid Removal.** Solid removal is not a covered service and shall incur an additional fee. If Meinco removes solids from the septic system, then it may charge to client the costs of solid removal. In any event, Meinco shall not be responsible for any damage or adverse effects for any delay in removing solids.
14. **Indemnity.** To the fullest extent permitted by law, Client shall indemnify, hold harmless, and defend Meinco and any agent or employees of Meinco from and against all injuries, claims, damages, losses, and expenses, including, but not limited to, attorneys' fees, arising directly or indirectly out of the obligations herein undertaken or resulting out of operations related to the Service Work or Service Site conducted by Meinco, Meinco's agents, anyone directly or indirectly employed by them or anyone for whose acts they may be liable, regardless of whether or not such injury, claim damage, losses, or expenses is caused in part by a party indemnified. Such obligation shall not negate, abridge, or otherwise reduce the rights or obligations of indemnity which would otherwise exist to a party or person described in this paragraph.

15. **Assignment.** Client agrees that even though this is a contract for services, Meinco may assign this Contract to any third party without written notice to Client.
16. **Bilateral Contract.** Meinco and client specifically agree that Client is seeking Meinco's promise to perform and not its performance.
17. **Claims Against Meinco.** Client shall give Meinco written notice of all claims within five (5) days of Client's knowledge of facts giving rise to the event for which claim is made. Otherwise, such claims shall be deemed waived by Client. All unresolved claims, disputes, and other matters in question between Meinco and Client shall be resolved in the manner provided for in this Agreement.
18. **Rights Upon Breach.** If Client breaches this Agreement with Meinco, Meinco may stop all work, including all Service Work. Additionally, Client will be liable to Meinco for consequential, incidental, and reliance damages as well as attorneys' fees and court costs. Such liability upon Client shall extend to petitions for and orders of contempt as well as any attempts by Meinco to collect upon any debt or damages owed to it by Client, including those entered by court of law or other dispute resolution proceeding.
19. **Direct Discussion.** If a dispute arises out of or relates to this Agreement, the Parties shall endeavor to settle the dispute through direct discussion before advancing to any dispute resolution proceeding.
20. **Joint Drafting.** The Parties expressly agree that this Agreement was jointly drafted and that this Agreement shall be construed neither against nor in favor of either Party. Instead, this Agreement shall be construed in a neutral manner.
21. **Choice of Law.** The Parties expressly agree that any dispute or claim filed or heard in any jurisdiction concerning or relating to this Agreement or worked performed as a result of this Agreement shall be governed by the laws of the State of Arkansas.
22. **Forum Selection and Choice of Venue.** The Parties expressly agree that any dispute or claim arising from, filed, or heard concerning or relating to this Agreement or work performed as a result of this Agreement shall be heard in Saline County, Arkansas, and no other forum. If this clause is penetrated and the hearing

concerning the dispute removed to the United States federal court system, then the Parties expressly agree that the dispute shall be heard in the United States District Court for the Eastern District of Arkansas, Western Division, at the Richard Sheppard Arnold United States Courthouse in Little Rock, Arkansas.

23. **Waiver of Agreement Terms.** Meinco, at its sole discretion and leisure, may waive any term in this Agreement. Such waiver shall not, under any conditions or circumstances, constitute a modification of this Agreement. Additionally, such waiver shall not, under any conditions or circumstances, constitute a course of performance, course of dealings, or trade usage between Meinco and Client. Any waiver by Meinco shall be limited to a single incident or event. No waiver of any term of this Agreement is valid unless it is in writing, signed by Meinco, and attached to this Agreement as an addendum. It is the responsibility and duty of Client to draft any written waiver and to present it to Meinco for Meinco's approval and signature.
24. **Force Majeure.** Neither Party shall be in breach of its obligations under this Agreement (other than payment obligations) or incur any liability to the other Party for any losses or damages of any nature whatsoever incurred or suffered if and to the extent that the other party it is prevented from carrying out its obligations by, or such losses or damages are caused by, a *force majeure* event. For purposes of this paragraph, the failure of the state of Arkansas or the United States of America to act according to current practices, procedure, or law at the time of the making of this Contract shall be considered a *force majeure* event. Such event by the government shall be in addition to any current or commonly accepted definition of *force majeure* event.
25. **Merger and Integration.** Meinco and Client agree that this Agreement represents a full, final, and complete memorial of their Agreement for the Service Work and that this Agreement does not rely upon any term or promise not otherwise specified within the four corners of this Agreement.
26. **No Oral Modification.** Meinco and Client agree that this Agreement shall not be subject to oral modification. The Parties agree that any modification made or agreed to by the Parties shall be in writing, signed by both Parties, and attached to this Agreement as an Addendum.

By signing this Agreement below, I indicate that I have read this Agreement and its terms, consisting of two (2) pages, excluding any Addendum or Addenda, and that these express terms are both acceptable and agreeable to me. I further declare that these terms do not represent an undue hardship, are not illusory, and are not unconscionable as I have expressly bargained for these terms in consideration of entering into this Contract for the value specified in paragraph three (3).

Meinco Septic Systems, Inc.

6/7/2019

Date

Client

Date



Arkansas Department of Health
4815 West Markham, Slot 46
Little Rock, Arkansas 72205-3867

MEMORANDUM OF AGREEMENT

SUBJECT: ONSITE WASTEWATER SYSTEM APPLICATION

This is an agreement that the onsite wastewater system installed on this property has been permitted under authority of Act 402 of 1977 and by the Arkansas Department of Health with the understanding that the following provisions are met:

1. Onsite Wastewater Systems requiring a Monitoring Contract with a Certified Monitoring Personnel are Holding Tanks, Experimental Systems (i.e. Reduced Absorption Areas, *ABGs), and Drip Dispersal Systems. *Aerobic Biological Generators – Commercial applications only, residential applications must follow manufacturers' service contract requirements.
2. The property owner assumes all responsibility for the proper operation of the onsite wastewater system.
3. The property owner must maintain a monitoring contract with a licensed Certified Monitoring Personnel for the life of the system and retain Onsite Wastewater System Assessments (EHP-71), on file, for at least five (5) years.
4. The Arkansas Department of Health has no responsibility in the operation and maintenance of such systems.
5. That the Arkansas Department of Health may monitor the system as to its operation capabilities.
6. That the Arkansas Department of Health is granted permission to make such inspections as deemed necessary.
7. Subsurface systems with flows ≥ 3000 gpd and all surface discharging systems require the owner to file an additional permit application with the Arkansas Department of Environmental Quality (ADEQ).
8. That, on the sale of the property, the owner of the property must disclose to the perspective buyer notice of this agreement and any permit requirements. The buyer is to sign memoranda, contracts or permit name change forms and submit these documents to the appropriate regulatory agency.

SIGNED: _____

(Property Owner)

SIGNED: _____

(Health Department)

DATE: _____

DATE: _____

6-21-19

7. At the traffic circle, take the 2nd exit and stay on Alcoa Rd

0.5 mi

8. At the traffic circle, take the 2nd exit and stay on Alcoa Rd

0.2 mi

9. Continue onto Alcoa Rd

0.2 mi

10. At the traffic circle, continue straight to stay on Alcoa Rd

0.2 mi

11. Slight right toward I-30 Frontage Rd (signs for I-30 E/Little Rock)

499 ft

12. Turn right onto I-30 Frontage Rd

2.1 mi

13. Use the right lane to take the ramp to AR-183 N/N Reynolds Rd

0.1 mi

14. Keep left at the fork, follow signs for AR-183 N

66 ft

15. Use any lane to turn left onto AR-183 N/N Reynolds Rd

Pass by Burger King (on the left in 0.4 mi)

0.5 mi

16. Turn right onto AR-5 N

1.4 mi

17. Turn left onto Woody Dr

Destination will be on the right

53 s (0.5 mi)

718 Woody Dr

Alexander, AR 72002

These directions are for planning purposes only. You may find that construction projects, traffic, weather, or other events may cause conditions to differ from the map results, and you should plan your route accordingly. You must obey all signs or notices regarding your route.

