

ARKANSAS DEPARTMENT OF ENVIRONMENTAL QUALITY
NOTICE OF INTENT
INDIVIDUAL TREATMENT FACILITIES
NPDES GENERAL PERMIT ARG550000

Application Type: New ☒ Renewal ☐ (Permit # ARG55 _____)

I. PERMITTEE/OPERATOR INFORMATION

Permittee (Legal Name): Joseph & Emily Perrone Operator Type:
Permittee Mailing Address: 9008 Pinnacles Cove ☐ State ☐ Partnership
Permittee City: Roland ☐ Federal ☐ Corporation*
Permittee State: Arkansas Zip: 72135 ☒ Sole Proprietorship/Private
Permittee Telephone Number: 501-352-1188 *State of Incorporation: _____
Permittee Fax Number: NA The legal name of the Permittee must be
Permittee E-mail Address: eperrone@gmail.com identical to the name listed with the
Arkansas Secretary of State.

II. INVOICE MAILING INFORMATION (Home owners are exempt.)

Invoice Contact Person: N/A City: _____
Invoice Mailing Company: _____ State: _____ Zip: _____
Invoice Mailing Address: _____ Telephone: _____

III. FACILITY INFORMATION

Facility Name: Perrone Residence Facility Contact Person: Joseph Perrone
Facility Address: 9008 Pinnacles Cove Telephone Number: 501-352-1188
Facility County: Pulaski Facility City, State & Zip: Roland, AR, 72135
Facility Latitude: 34 Deg 50 Min 32.23 Sec Facility Longitude: 92 Deg 32 Min 39.06 Sec
Datum
Accuracy: _____ Method: _____ : _____ Scale: _____ Description: _____

IV. DISCHARGE INFORMATION

Outfall Number: 001 Flow: 450 gpd (Gallons per Day)
Stream Segment: 3C Hydrologic Basin Code: 111 102 07
Outfall Latitude: 34 Deg 50 Min 29.52 Sec Outfall Longitude: 92 Deg 32 Min 40.04
Datum
Accuracy: _____ Method: _____ : _____ Scale: _____ Description: _____
Type of Treatment: Norweco Single line 960 w/ Chlorine
Receiving Stream: Arkansas River

V. FACILITY PERMIT INFORMATION

NPDES Individual Permit Number (If Applicable): AR00
NPDES General Permit Number (If Applicable): ARG
State Construction Permit Number: _____
NPDES General Construction Stormwater Permit Number (If Applicable): ARR15

WATER DIVISION
5301 NORTHSHORE DRIVE / NORTH LITTLE ROCK, ARKANSAS 72118
PHONE 501-682-0623 / FAX 501-682-0880
www.adeq.state.ar.us

SPANNED
APR 18 2024
MAILROOM

OTHER INFORMATION:

Operator Name: David Meints
Operator License Number: 009055 License Class: III
Consultant Contact Name: David Meints
Consultant Email Address: david@meincowastewater.com
Consultant Address: PO Box 1001 City: Bryant State: AR Zip: 72089
Consultant Phone Number: 501-804-0837 Consultant Fax Number: 501-821-4048

Has this treatment system been approved by AHD? Yes ☒ No ☐

Disclosure Statements:

Arkansas Code Annotated Section 8-1-106 requires that all applicants for the issuance or transfer of any permit, license, certification or operational authority issued by the Arkansas Department of Environmental Quality (ADEQ) file a disclosure statement with their applications. The filing of a disclosure statement is mandatory. No application can be considered complete without one. You must submit a new disclosure statement even if you have one on file with the Department. The form may be obtained from ADEQ web site at: http://www.adeq.state.ar.us/disclosure_stmt.pdf.

VII. CERTIFICATION OF OPERATOR

JP (Initial) "I certify that, if this facility is a corporation, it is registered with the Secretary of the State of Arkansas."
JP (Initial) "I certify that the cognizant official designated in this Application is qualified to act as a duly authorized representative under the provisions of 40 CFR 122.22(b). If no cognizant official has been designated, I understand that the Department will accept reports signed only by the Applicant."
JP (Initial) "I certify under penalty of law that this document and all attachments were prepared under my direction or supervision in accordance with a system designed to assure that qualified personnel properly gather and evaluate the information submitted. Based on my inquiry of the person or persons directly responsible for gathering the information, the information submitted is, to the best of my knowledge and belief, true, accurate, and complete. I am aware that there are significant penalties for submitting false information, including the possibility of fine and imprisonment for knowing violations."

Responsible Official Printed Name: Joseph Perrone Title: Owner
Responsible Official Signature: [Signature] Date: 8/7/23
Responsible Official Email: eperrone@gmail.com
Cognizant Official Printed Name: David Meints Title: Class III Operator
Cognizant Official Signature: [Signature] Telephone: 501-804-0837
Cognizant Official Email: david@meincowastewater.com

X. PERMIT REQUIREMENT VERIFICATION

Please check the following to verify completion of permit requirements.

Yes No * If No is answered for any of the questions, then a permit can not be issued!

Submittal of Complete NOI? ☒ ☐
Submittal of Required Permit Fee? ☐ ☒ Check Number: _____
Submittal of AHD Form EHP-19? ☒ ☐
Submittal of Site Map? ☒ ☐
Disclosure Statement ☐ ☒

WATER DIVISION
5301 NORTSHORE DRIVE / NORTH LITTLE ROCK, ARKANSAS 72118
PHONE 501-682-0623 / FAX 501-682-0880
www.adeq.state.ar.us





Arkansas Department of Health
Environmental Health Protection

Receipt Number
22673131

Individual Onsite Wastewater System Permit Application

Permit Type ☒ New Installation
☐ Alteration / Repair

DR Environmental ID #

7 6 0 1 0 5 5 4 7

Fee Schedule for Structures		✓
Structures 1500 sq ft or less	\$ 30.00	<input type="checkbox"/>
Structures more than 1500 sq ft and up to 2000 sq ft	\$ 45.00	<input type="checkbox"/>
Structures more than 2000 sq ft and up to 3000 sq ft	\$ 90.00	<input checked="" type="checkbox"/>
Structures more than 3000 sq ft and up to 4000 sq ft	\$120.00	<input type="checkbox"/>
Structures more than 4000 sq ft	\$150.00	<input type="checkbox"/>
Alteration and Repair	\$ 30.00	<input type="checkbox"/>

Part 1 Application

Treatment Type (check one)

Disposal Method (check one)

<input type="checkbox"/> STD = Standard Septic Tank	<input checked="" type="checkbox"/> ATU = Aerobic Treatment Plant	<input type="checkbox"/> STD = Standard Absorption Field	<input type="checkbox"/> LPD = Low Pressure Distribution
<input type="checkbox"/> ISF = Intermittent Sand Filter	<input type="checkbox"/> RSF = Re-circulating Sand Filter	<input checked="" type="checkbox"/> SUR = Surface Discharge	<input type="checkbox"/> HLD = Holding Tank
<input type="checkbox"/> PMF = Proprietary Media Filter	<input type="checkbox"/> RGF = Re-circulating Gravel Filter	<input type="checkbox"/> CPF = Capping Fill	<input type="checkbox"/> SRL = Serial Distribution
<input type="checkbox"/> OTH = Other (Describe)	<input type="checkbox"/> HLD = Holding Tank	<input type="checkbox"/> OTH = Other	<input type="checkbox"/> DRP = Drip Irrigation

1. Owner's/Applicant's Name Todd Kuhn		2. Phone Number (501) 912-2259	
3. Mailing Address 106 Jacob Court, Little Rock, AR 72211		4. County Pulaski	
5. Address of Proposed System (If a 911 address is not available, attach detailed directions or map) Lot 9, Pinnacles Cove, Roland, AR 72135			
6. Subdivision Name Pinnacles Subdivision	7. Approval Date n/a	8. Date Recorded n/a	9. Lot Number 9
10. Lot Dimensions 461' x 712' x 198' x 548'	11. Total Area (Acres) 5.01	12. # Bedrooms # People 4	13. Daily Flow (GPD) 450
14. Brief Legal Description of Property (Attach a separate sheet of paper, if necessary) Section 6, Township 2 North, Range 14 West, Pulaski County			
15. Water Supply (Specify supplier, if Public Water) Central Arkansas Water		16. GPS Coordinates Hm 34.84223, -92.54429 POD 34.84214, -92.54461	

17. Loading Rates (gpd/ft ²)	18. System Specifications		
Primary Area n/a	a. Size of Septic Tank	ATU gal	f. Trench Depth n/a inches
Secondary Area n/a	b. Size of Dose Tank	250 gal	g. Trench Spacing n/a feet
Percolation Test (min/in)	c. Absorption Area	n/a ft ²	h. Trench Media (List Below)
Primary Area Avg n/a	d. Number of Field Lines	n/a	i. Trench Width n/a in
Secondary Area n/a	e. Length of Field Lines	n/a ft	n/a in

TO THE OWNER

The permit for construction may be deemed invalid by the local Environmental Health Specialist before the start of construction, if the site and/or soil conditions have changed after approval of this permit, or if the information within this permit is inaccurate or has been found to be misrepresented. Approval for operation does not constitute a guarantee that the system will function properly. The approval states that the system was designed and installed according to the Arkansas Department of Health, Rules and Regulations Pertaining to Onsite Wastewater Systems, unless there are exceptions or deviations noted in the comments. A Permit for Construction is valid for one (1) year from the date of approval. The authorized agent must revalidate a permit more than one (1) year old prior to the start of any construction.

19. Utilization Verification

I hereby attest that item 12, the number of bedrooms (number of persons for commercial) and square footage of the structure that will utilize the designed individual onsite wastewater system in this permit application, is accurate. I have reviewed the permit application and understand the layout, installation, maintenance, operation and expense(s) that may be associated with this system.

Owner/Applicant Signature See Opt A Date _____

20. I certify that I have conducted the above tests and that the above listed information is in accordance with the latest requirements of the Arkansas Department of Health Rules and Regulations Pertaining to Onsite Wastewater Systems.

David A. Meints

Designated Representative

Soil Certified ☒ Yes ☐ No

Designated Representative Signature

Title

David A. Meints

02/18/2019

501-821-3837/501-804-0837

Print Name

Date

Phone Number

21. Approval of Health Authority

The information and specifications in the application has been reviewed and found to meet the requirements of the Arkansas Department of Health Rules and Regulations Pertaining to Onsite Wastewater Systems. A PERMIT FOR CONSTRUCTION is hereby issued.

[Signature]
Environmental Specialist Signature

864
EHS Number

2-28-19
Date

Individual Onsite Wastewater System Permit Application

Receipt Number

Continue Part 1

22. Soil Criteria (Primary Area)								Indicate the depth to items a-f, if observed in the soil (designate in inches)
a. Bedrock	b. BSWT	c. MSWT	d. LSWT	e. Adj. MSWT	f. Adj. LSWT	g. H.C./Depth	h. Loading Rate (gpd/ft ²)	
>48"	n/a	Surface	n/a	n/a	n/a	n/a	Unsuitable	
23. Soil Criteria (Secondary Area)								Indicate the depth to items a-f, if observed in the soil (designate inches)
a. Bedrock	b. BSWT	c. MSWT	d. LSWT	e. Adj. MSWT	f. Adj. LSWT	g. H.C./Depth	h. Loading Rate (gpd/ft ²)	
>48"	n/a	Surface	n/a	n/a	n/a	n/a	Unsuitable	
24. Seasonal Water Table (SWT) Classes Detail								
Primary Area		List Redoximorphic Features and/or Clay Content Restrictions						
Brief	in	n/a						
Moderate	in	Depletions noted on less than 50% of ped surface or interior. Depletion <= chroma 2.						
Long	in	Not Observed						
Secondary Area		List Redoximorphic Features and/or Clay Content Restrictions						
Brief	in	n/a						
Moderate	in	Depletions noted on less than 50% of ped surface or interior. Depletion <= chroma 2.						
Long	in	Not Observed						
Comments								
Site requires an ATU (BioMicrobics Fast 0.5) with UV disinfection and surface discharge. NPDES Permit required. If system is not installed within a year of the date approved, a revalidation fee may be required. Slope < 3%. Revised with new owner name and re-validated 05/26/2021 DAM								

Part 2 Installation Inspection

Septic tank manufacturer	Pump information
Septic tank material	Trench media and width
Dose tank manufacturer	Depth of interceptor drain
Dose tank material	Depth of settled fill
Name of Installer	License Number
Installation Inspected by <input type="checkbox"/> Environmental Health Specialist <input type="checkbox"/> Designated Representative (check one or installer signs System Installation Verification below)	
Signature	EHS / License Number Date
System Installation Verification I have installed this system as designed and in compliance with all Rules and Regulations Pertaining to Onsite Wastewater Systems.	
Installer Signature	License Number Date

Part 3 Permit for Operation

The information contained in Part 1 and 2 of this form has been reviewed and found to meet the requirements of the Arkansas Department of Health. THE PERMIT FOR OPERATION of this system is hereby issued.		
Environmental Health Specialist	Signature	EHS Number Date
Comments		
Site Revalidation conducted by <input type="checkbox"/> Environmental Health Specialist <input type="checkbox"/> Designated Representative (check one)		
Signature	0198	05/26/2021
	EHS / License Number	Date

712'

PIANACLES COVE

461'

LOT

A=5.01



SOIL PIT - NOT SUITABLE

SOIL PIT - NOT SUITABLE

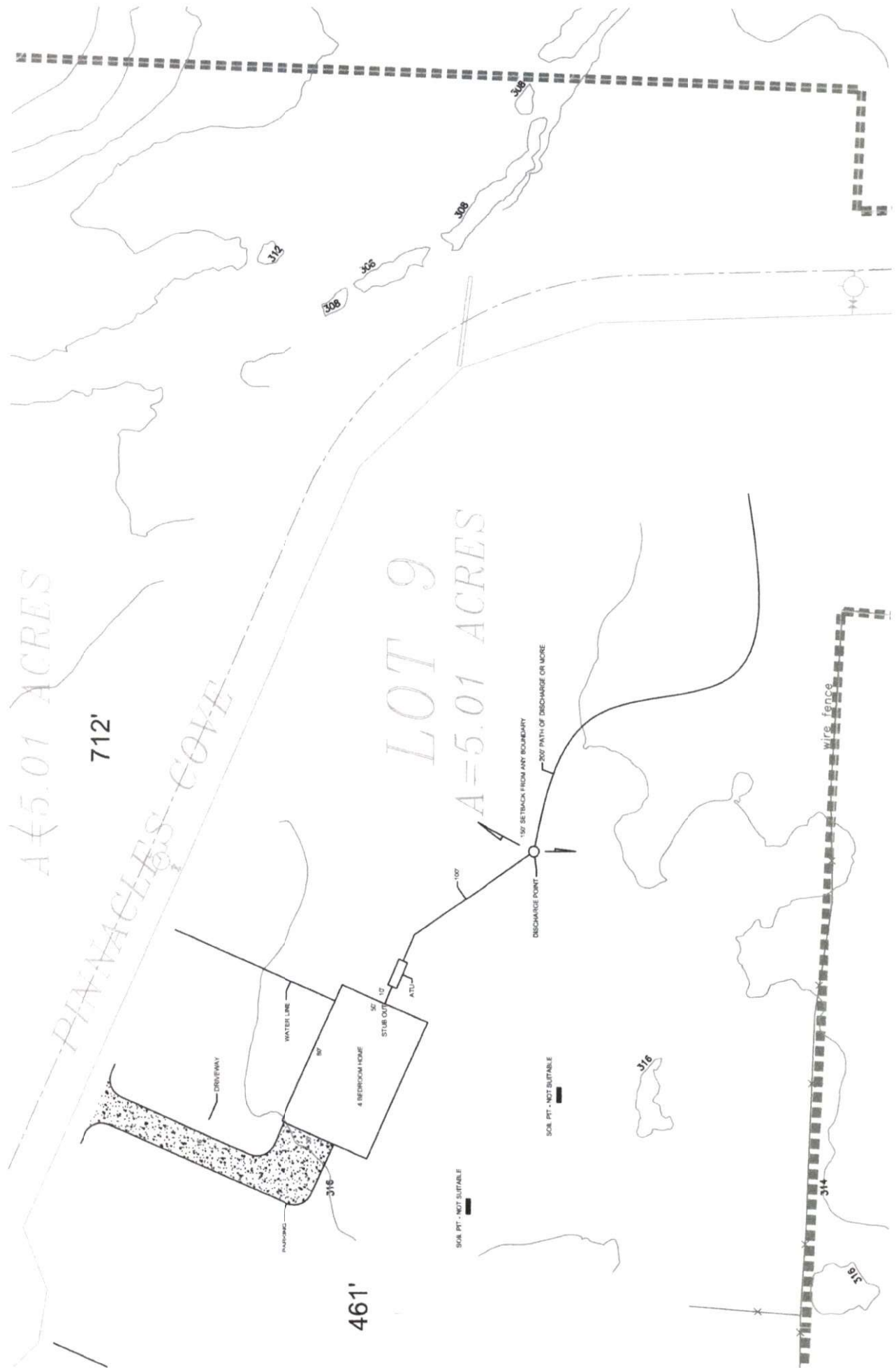

NOTES

1. Airline piping to FAST® may not exceed 100 FT [30m] total length and have a maximum of 4 elbows in the piping system. For distances greater than 100 FT [30m] consult factory. Blower must be located above flood levels on a concrete base 26" X 20" X 2" [65 X 50 X 5cm] min.
2. Vent to desired location and cover opening with a vent grate with at least 7 sq in. [45 sq. cm] open surface area. Secure with stainless steel screws. Vent piping must not allow condensate build up or create back pressure. Vent must be above finished grade or higher (see sheet 4 of 4).
3. All appurtenances to FAST® (e.g. tanks, access ports, electrical, etc.) must conform to all applicable country, state, province, and local plumbing and electrical codes. Pump out access shall be adequate to thoroughly clean out both zones.
4. All inspection, viewing and pump out ports must be secured to prevent accidental or unauthorized access.
5. Tank, piping, conduit, etc. are provided by others. Blower control system by Bio-Microbics, Inc. See Installation Manual.
6. If less than the specified minimums are considered necessary, consult factory for guidance.
7. All piping and ancillary equipment installed after FAST must not impede or restrict free flow of effluent.
8. The tank(s) shall be designed to prevent air passage between the settling zone/tank and the treatment zone and preventing an air lock. Examples include a baffle wall sealed to the lid or treatment zone inlet line with a pipe cap. Consult factory for guidance.
9. The air supply line into the FAST® unit must be secured to prevent vibration induced damage. The air supply line should be secured with a non-corrosive clamp every 2' min [60 cm]. See alternate air supply option on sheet 4 of 4.
10. Specialized treatment levels may require specific features to be incorporated into the design. Consult factory for guidance.
11. Min. height may be reduced, consult factor and reference "Low Profile Module Procedure.pdf"
12. Refer to sheet 4 of 4 for leg extensions requirements.

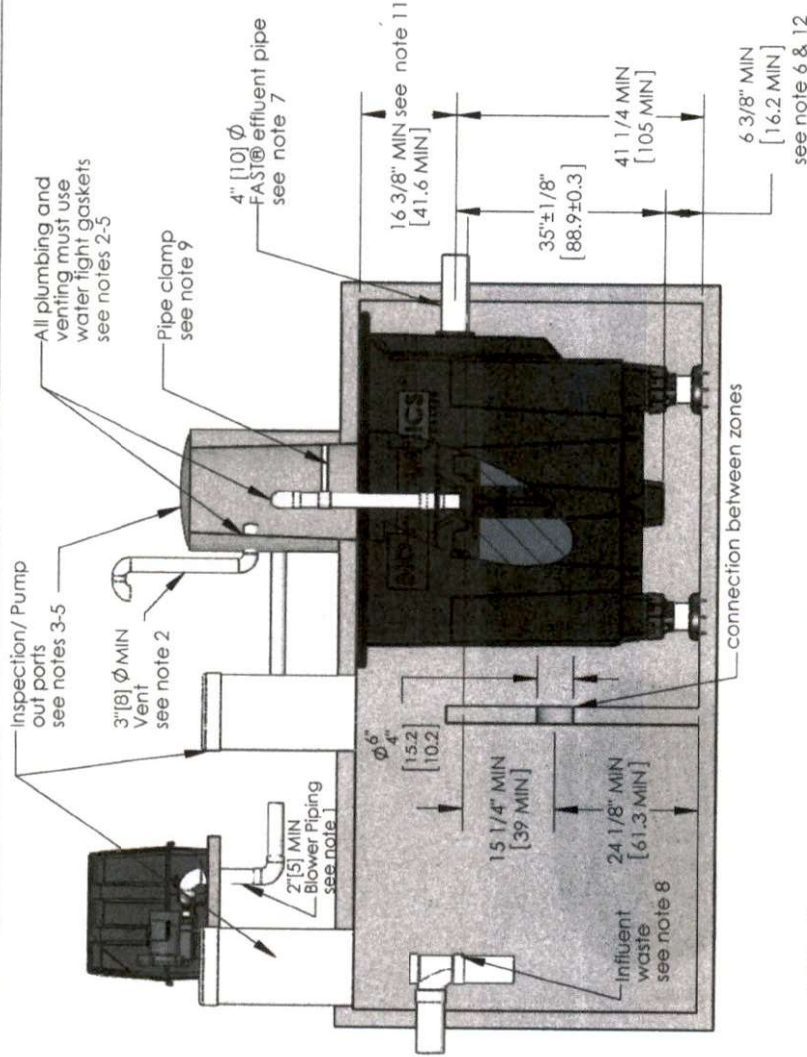

Settling Zone
350 Gallon MIN [1300 L MIN]

Treatment Zone
450 Gallon MIN [1700 L MIN]

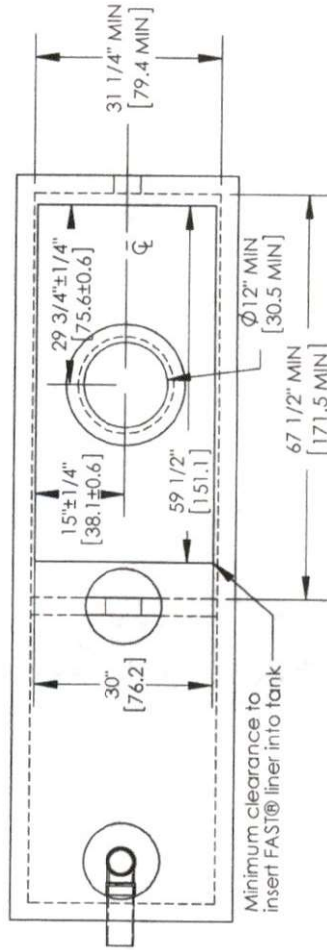

DO NOT SCALE
UNLESS NOTED
DIMENSIONS
ARE IN INCHES
[CENTIMETERS]
TOLERANCES
± 0.02 IN/IN
[± 0.05 CM/CM]

BIO MICROBICS
BETTER WATER. BETTER WORLD.™

MicroFAST 0.50 FAST Unit

WEIGHT	SIZE	DRAWING NUMBER
	A	MicroFAST 0.50 with feet
DRAWN: CFC 12/18/2006	DATE	REV. IN-05-V
CHECKED: PF 9/18/2013		REVISED 9/18/2013

BIO-MICROBICS © 2014

THE INFORMATION CONTAINED IN THIS DRAWING IS THE SOLE PROPERTY OF BIO-MICROBICS, INC. ANY REPRODUCTION IN PART OR AS A WHOLE WITHOUT THE WRITTEN PERMISSION OF BIO-MICROBICS, INC. IS PROHIBITED. DESIGN AND INVENTION RIGHTS ARE RESERVED. IN THE INTEREST OF TECHNOLOGICAL ADVANCEMENT, ALL PRODUCTS ARE SUBJECT TO DESIGN AND OR MATERIAL CHANGE WITHOUT NOTICE.

SHEET
2 OF 4

Minimum leg extension assembly
see note 1-4

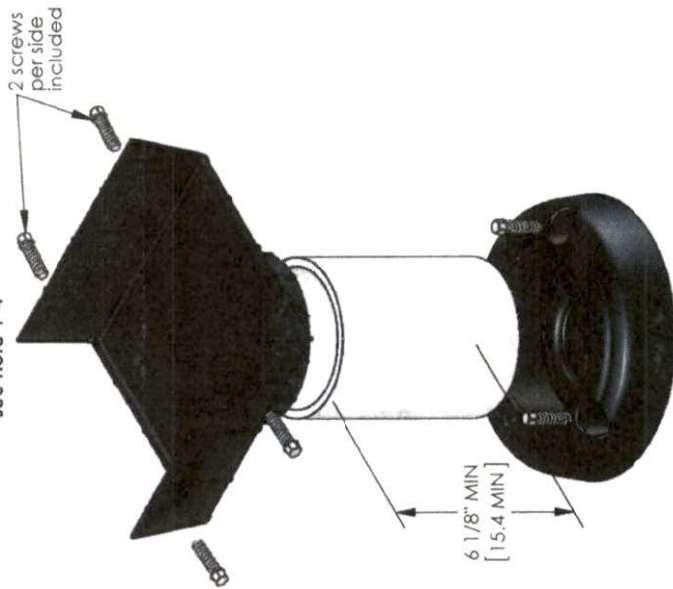

DETAIL
SCALE 1 : 5

FAST® Vent Option

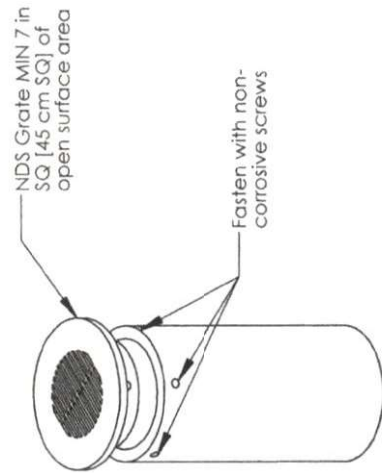

DETAIL
SCALE 1 : 4

Alternate Air Supply
Option

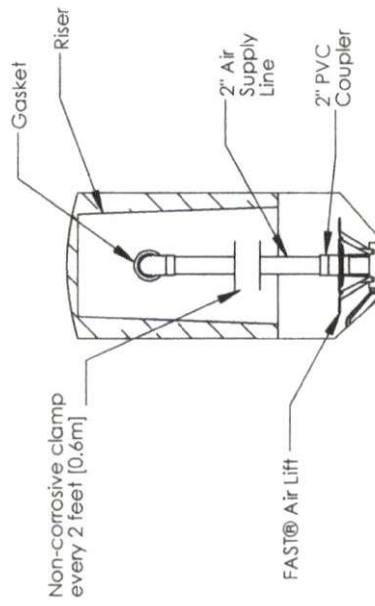
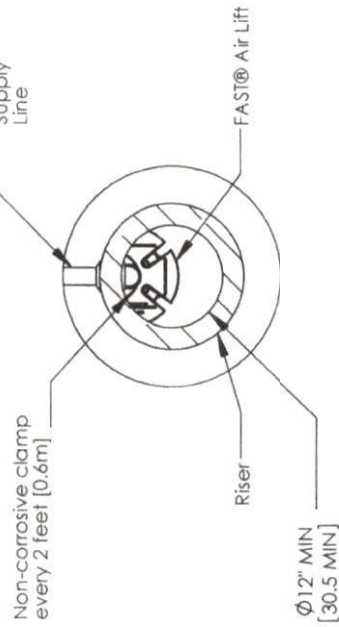

- Notes**
1. Secure leg extension to the FAST® unit by placing two screws on each side of the leg extension (4 screws per foot are included).
 2. Cut 4" schd. 40 PVC pipe (not included) to obtain the desired height. Minimum pipe length of 6 1/8" [15.56cm] will provide minimum clearance of 10". For heights greater than 18" [45.7cm] use schd. 80 PVC pipe (not included). Consult factory for extending leg beyond 36" [90 cm].
 3. Anchor the leg extensions to the tank with non-corrosive hardware (not included) at the provided mounting points.
 4. If less than the specified minimums are considered necessary, consult factory for guidance.
 5. The air supply line into the FAST® unit must be secured to prevent vibration induced damage. The air supply line should be secured with a non-corrosive clamp every 2ft [0.6m] minimum.
 6. Tank, anchors, piping conduit, blower, housing pad and vents are provided by others.

DO NOT SCALE
UNLESS NOTED
DIMENSIONS
ARE IN INCHES
[CENTIMETERS]
TOLERANCES
± 0.02 IN/IN
[± 0.05 CM/CM]

BIO MICROBICS
BETTER WATER. BETTER WORLD™

MicroFAST 0.50 FAST Unit

WEIGHT	DATE	DRAWING NUMBER	SHEET
NAME	DATE	A	4 OF 4
DRAWN: CFC 12/18/2006	9/18/2013	MicroFAST® 0.50 Details	REV. IN-05-V
CHECKED: PF			

BIO-MICROBICS © 2014

THE INFORMATION CONTAINED IN THIS DRAWING IS THE SOLE PROPERTY OF BIO-MICROBICS INC. ANY REPRODUCTION IN PART OR AS A WHOLE WITHOUT THE WRITTEN PERMISSION OF BIO-MICROBICS INC. IS PROHIBITED. DESIGN AND INVENTION RIGHTS ARE RESERVED. IN THE INTEREST OF TECHNOLOGICAL ADVANCEMENT, ALL PRODUCTS ARE SUBJECT TO DESIGN AND OR MATERIAL CHANGE WITHOUT NOTICE.

Specifications for MicroFAST 0.50 Wastewater Treatment System

1. GENERAL

The contractor shall furnish and install (1) MicroFAST@0.50 treatment system as manufactured by Bio-Microbics, Inc. The treatment system shall be complete with all needed equipment as shown on the drawings and specified herein.

The principal items of equipment shall include the FAST@ system insert, blower assembly, blower controls and leg extensions or lid. All other items will be provided by others. The MicroFAST 0.50 unit shall be situated within a 450 Gallon [1700L] minimum compartment as shown on the drawings. Suggested maximum settling zone is (1) X the daily flow. Tank must provide adequate pump out access and conform to local, state, and all other applicable codes. The contractor shall coordinate the proper fabrication of the tank between the FAST system and tank supplier with regard to fabrication of the tank, installation of the FAST unit, and delivery to the job site.

2. OPERATING CONDITIONS

The MicroFAST 0.50 treatment system shall be capable of treating the wastewater produced by typical family activities (bath, laundry, kitchen, etc.) ranging from (1) one to (8) eight people and not to exceed 500 US Gallons per day (1800 LPD) provided the waste contains nothing that will interfere with biological treatment. The FAST system is a biological treatment system not meant for non-biodegradable or industrial wastewater.

3. MEDIA

The FAST@ media shall be manufactured of rigid PVC, polyethylene, or polypropylene and it shall be supported by the polyethylene insert. The media shall be fixed in position and contain no moving or wearing parts and shall not corrode. The media shall be designed and installed to ensure that sloughed solids descend through the media to the bottom of the septic tank.

4. BLOWER

The MicroFAST 0.50 unit shall come equipped with a regenerative type blower capable of delivering 17-25 CFM [31-46 m3/hr]. The blower assembly shall include an inlet filter with metal filter element. The blower shall be mounted outside the tank on a contractor supplied concrete base. Blower piping to the tank shall use non-corrosive material (PVC, Galvanized, or stainless Steel). Do not run galvanized pipe inside the treatment tank. Refer to Installation Manual for further details.

5. REMOTE MOUNTED BLOWER

The blower shall be placed on a contractor supplied concrete base. The blower must not sit in standing water and its elevation must be higher than the tank and normal flood level. A two-piece, rectangular housing shall be provided. The discharge air line from the blower to the MicroFAST@ System shall be provided and installed by the contractor.

6. ELECTRICAL

The electrical source should be within 150 feet [45 meters] of the blower consult local codes for longer wiring distances. All wiring must conform to all applicable codes (IEC, NEC, etc.). Wiring distances must prevent significant voltage loss. Input power on 60Hz electrical systems 110/220VAC, 1Ø, 3.5/1.7 FLA, on 50 Hz electrical systems 220VAC, 1Ø, 1.9 FLA. Other voltages and phase are also available. Actual power consumption varies with site conditions. All conduit and wiring shall be supplied by contractor.

7. CONTROLS

The control panel provides power to the blower and contains an alarm system consisting of a visual and audible alarm capable of signaling blower circuit failure and high water conditions. The control panel is equipped with SFR@ (Sequencing Fixed Reactor) timed control feature. A manual alarm silence button is included.

8. INSTALLATION AND OPERATING INSTRUCTIONS

All work must be done in accordance with local codes and regulations. Installation of the FAST 0.50 shall be done in accordance with the written instructions provided by the manufacturer. Manuals shall be furnished, which will include a description of system installation, operation, and maintenance procedures.

9. FLOW AND DOSING

FAST@ systems have been successfully designed, tested and certified receiving gravity, demand-based influent flow. When influent flow is controlled by pump or other means to help with highly variable flow conditions, then multiple dosing events should be used to maximize performance. The flow rate shall not exceed 5 gpm (19 Lpm) with a maximum hourly flow not to exceed 10% of the design daily flow (50 gph [190 LPH]).

10. WARRANTY

Bio-Microbics, Inc. warrants all new residential FAST@ models (MicroFAST@ 0.50, 0.625, 0.75, 0.90, and 1.5) against defects in materials and workmanship for a period of two years after installation or three years from date of shipment which ever occurs first. All other FAST@ system models are warranted for a period of one year after installation or eighteen months from date of shipment, whichever occurs first. All are subject to the following terms and conditions below:

During the warranty period, if any part is defective or fails to perform as specified when operating at design conditions, and if the equipment has been installed and is being properly maintained in accordance with the written instructions provided by Bio-Microbics, Inc., Bio-Microbics, Inc. will repair or replace at its discretion such defective parts free of charge. Defective parts must be returned by owner to Bio-Microbics, Inc.'s factory postage paid, if so requested. The cost of labor and all other expenses resulting from repair of the defective parts and from installation of parts furnished under this warranty and regular maintenance items such as filters or bulbs shall be borne by the owner. This warranty does not cover general system misuse, aerator components which have been damaged by flooding or any components that have been disassembled by unauthorized persons, improperly installed or damaged due to altered or improper wiring or overload protection. This warranty applies only to the treatment plant and does not include any other structure wiring, plumbing, drainage, septic tank or disposal system. Bio-Microbics, Inc. reserves the right to revise, change or modify the construction and/or design of the FAST system, or any component part or parts thereof, without incurring any obligation to make such changes or modifications in present equipment. Bio-Microbics, Inc. is not responsible for consequential or incidental damages of any nature resulting from such things as, but not limited to, defect in design, material, or workmanship, or delays in delivery, replacements or repairs.

THIS WARRANTY IS IN LIEU OF ALL OTHER WARRANTIES EXPRESS OR IMPLIED. BIO-MICROBICS SPECIFICALLY DISCLAIMS ANY IMPLIED WARRANTY OF MERCHANTABILITY OR FITNESS FOR A PARTICULAR PURPOSE. NO REPRESENTATIVE OR PERSON IS AUTHORIZED TO GIVE ANY OTHER WARRANTY OR TO ASSUME FOR BIO-MICROBICS, INC., ANY OTHER LIABILITY IN CONNECTION WITH THE SALE OF ITS PRODUCTS. Contact your local distributor for parts and service.

THE INFORMATION CONTAINED IN THIS DRAWING IS THE SOLE PROPERTY OF BIO-MICROBICS, INC.. ANY REPRODUCTION IN PART OR AS A WHOLE WITHOUT THE WRITTEN PERMISSION OF BIO-MICROBICS, INC. IS PROHIBITED. DESIGN AND INVENTION RIGHTS ARE RESERVED. IN THE INTEREST OF TECHNOLOGICAL ADVANCEMENT, ALL PRODUCTS ARE SUBJECT TO DESIGN AND OR MATERIAL CHANGE WITHOUT NOTICE.

BIO-MICROBICS © 2014

DO NOT SCALE

UNLESS NOTED

DIMENSIONS

ARE IN INCHES

(CENTIMETERS)

TOLERANCES

± 0.02 IN/IN

(± 0.05 CM/CM)

WEIGHT

ID

DATE

NAME

CHECKED

PI

9/18/2013

DRAWN

CTC

12/18/2006

DRAWING NUMBER

A

MicroFAST@ 0.50 Specifications

REVISED 9/18/2013

REV

INI-05-V

MicroFAST 0.50 FAST Unit

BIO MICROBICS

BETTER WATER. BETTER WORLD.

SHEET
3 OF 4

BIO-MICROBICS MicroFAST 0.5 SPECIFICATIONS

DISTRIBUTOR - MEINCO, INC.

501-804-0837, DAVID MEINTS

POWER REQUIREMENTS

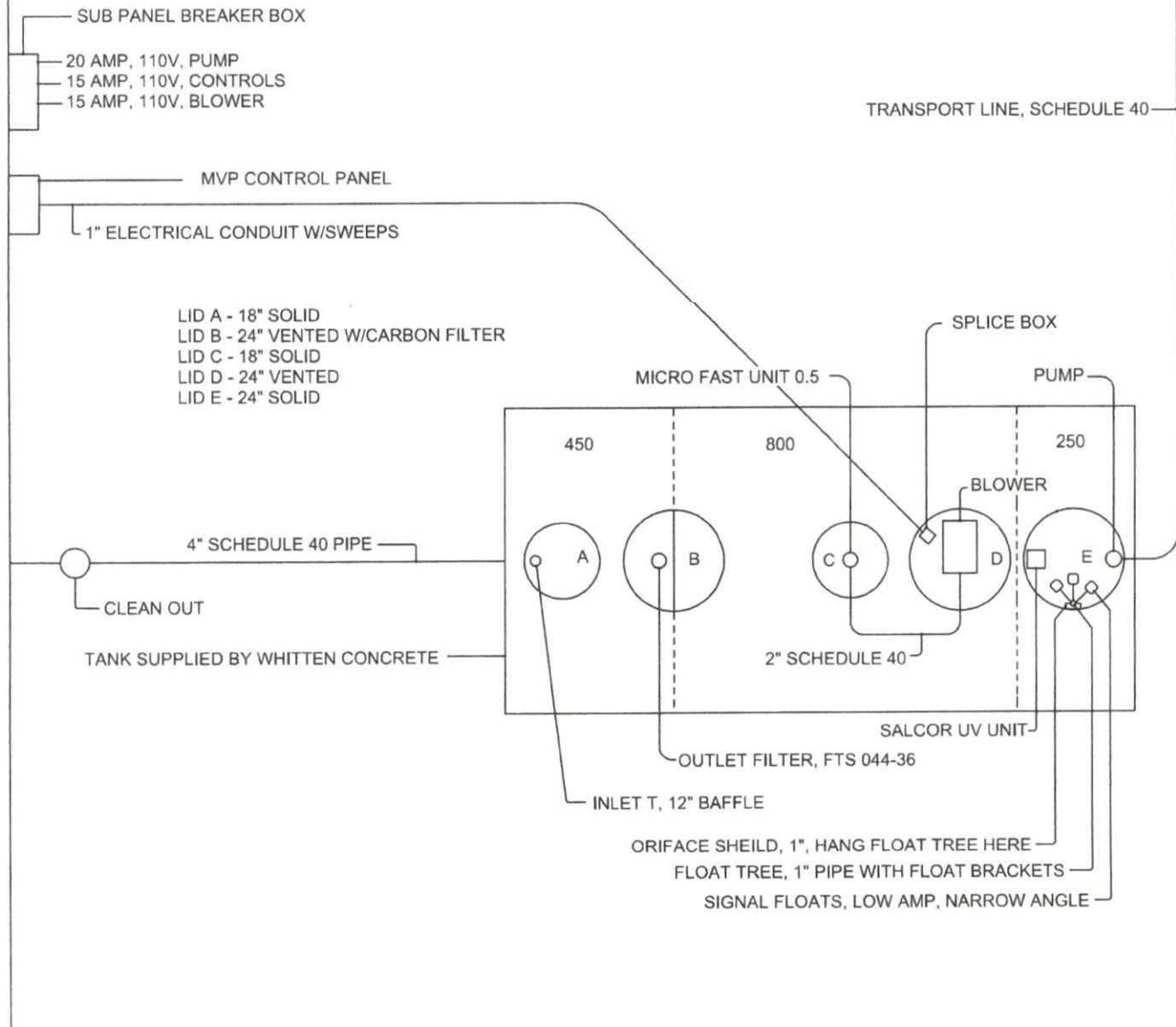

BIO-MICROBICS MicroFAST 0.5 WIRING SPECIFICATIONS

DISTRIBUTOR - MEINCO, INC.

501-804-0837, DAVID MEINTS

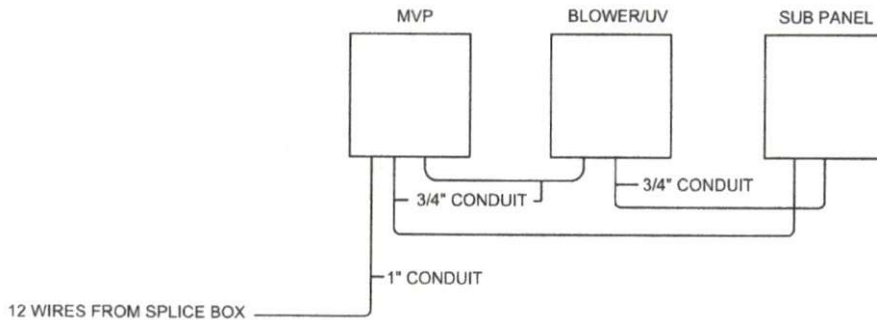

MVP PANEL WIRING REFERENCE

FROM SPLICE BOX

PUMP BLACK (BLACK)
PUMP WHITE (YELLOW)
PUMP GROUND (GREEN)
BOTTOM FLOAT BLACK (BLUE)
MIDDLE FLOAT BLACK (BLUE BLACK)
TOP FLOAT BLACK (RED)
FLOAT COMMONS WHITE (RED BLACK)

UV BLACK (ORANGE BLACK)
UV WHITE (ORANGE)

BLOWER BACK
BLOWER WHITE
BLOWER GROUND

MVP PANEL SETTINGS LOGO UNIT

TIMER ON	(SEC)	30:00
TIMER OFF	(MIN)	30:00
TIMER OVR ON	(SEC)	30:00
TIMER OVR OFF	(MIN)	03:00
TOTAL TIMER OVR	(MIN)	10:00
HLA DELAY	(HRS)	04:00

GOES TO

MVP TERMINAL 6
MVP TERMINAL 7
MVP GROUND TERMINAL
MVP TERMINAL 1
MVP TERMINAL 2
MVP TERMINAL 3
MVP TERMINAL 5

BLOWER PANEL UV
BLOWER PANEL UV

BLOWER PANEL BLOWER
BLOWER PANEL BLOWER
BLOWER PANEL BLOWER

BLOWER PANEL WIRING REFERENCE

FROM BLOWER

BLOWER BLACK (BLACK)
BLOWER WHITE (WHITE)
BLOWER GROUND (GREEN)

NOTE: CURRENT SENSOR JUMPER NEEDS TO BE MOVED TO "OFF"

GOES TO

BLOWER TERMINAL L1
BLOWER TERMINAL N/L2
BLOWER TERMINAL G

SUB PANEL WIRING REFERENCE

FROM SUB PANEL

20 AMP 110V, PUMP CIRCUIT
20 AMP 110V, NEUTRAL
GROUND

15 AMP 110V, CONTROL CIRCUIT
15 AMP 110V, NEUTRAL

15 AMP 110V, BLOWER CIRCUIT
15 AMP 110V, NEUTRAL
GROUND

GOES TO

MVP PANEL 20 AMP BREAKER
MVP PANEL 20 AMP BREAKER
MVP PANEL GROUND

MVP PANEL 10 AMP BREAKER
MVP PANEL TERMINAL N

BLOWER PANEL POWER L1
BLOWER PANEL N/L2
BLOWER GROUND

Salcor 3G UV Disinfection Unit

NOTE: Not all dimensions to scale

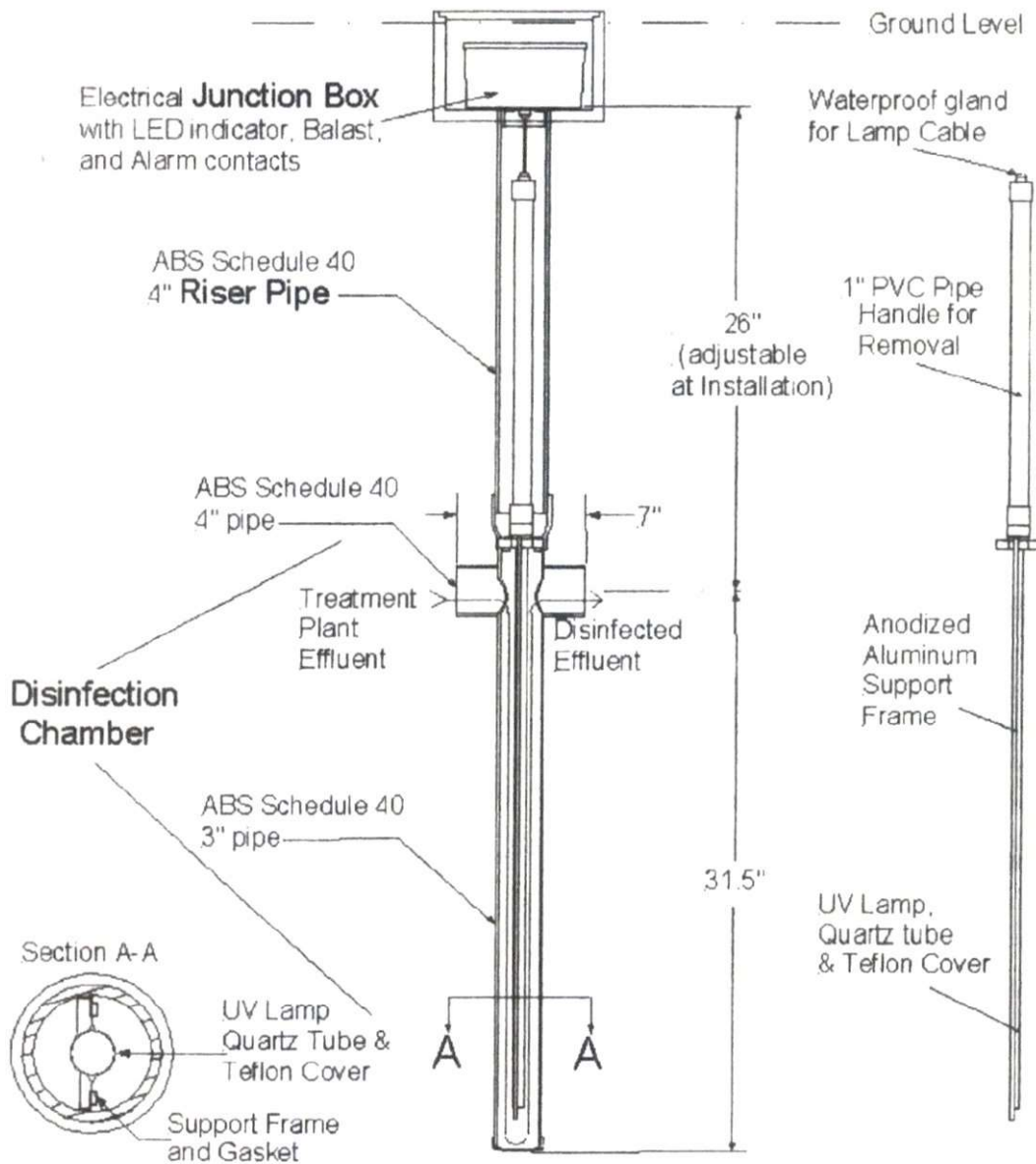

Figure 1

In Ground Installation

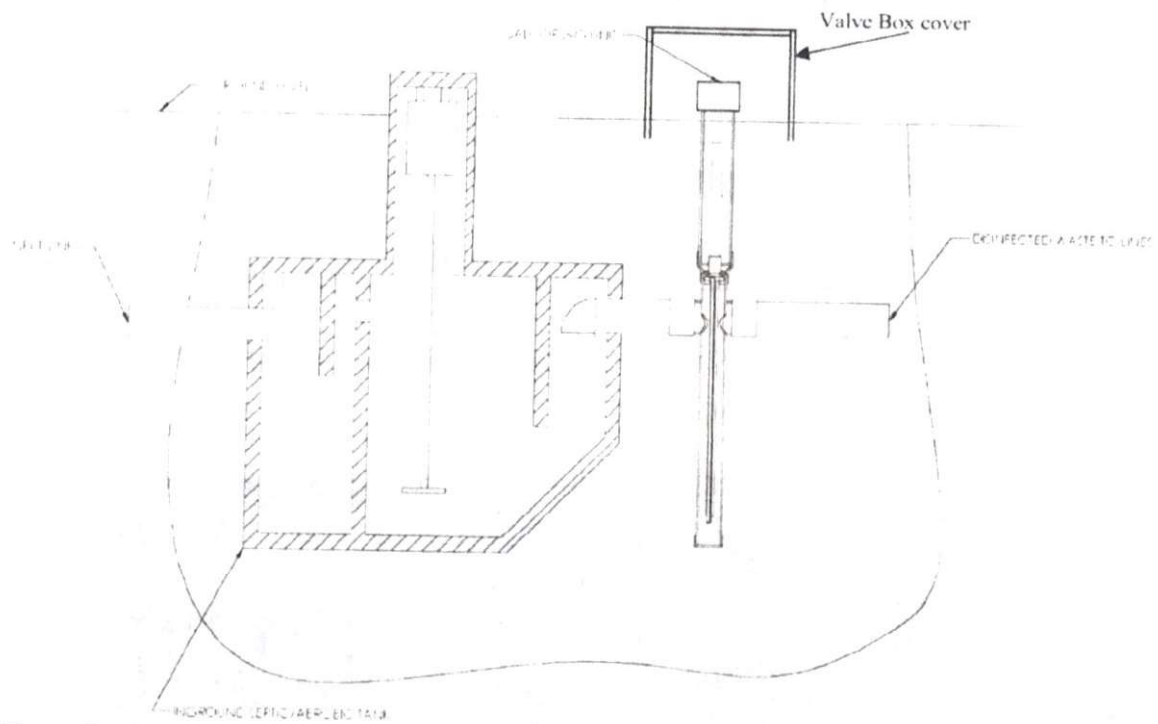

Figure 2

In Tank Installation

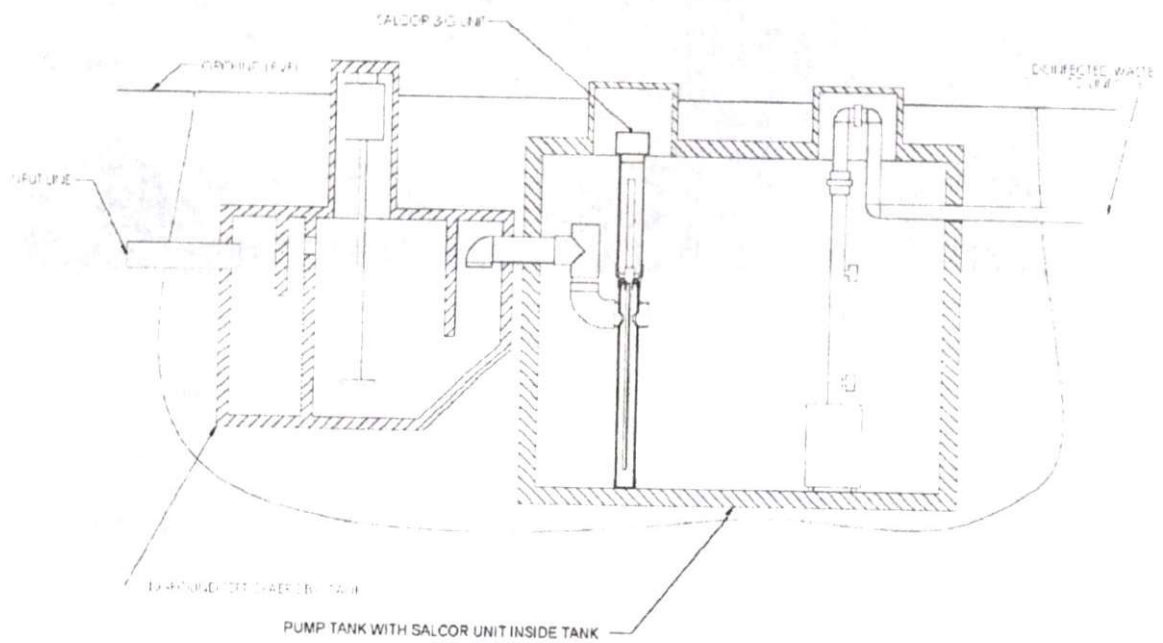

Figure 3

SALCOR INC.

P.O Box 1090
Fallbrook, Ca. 92088
Telephone: 760 731 0745

V. ELECTRICAL JUNCTION BOX LID

The Ballast and terminal strips are now mounted on the Alarm Board, mounted to the Junction Box Lid.

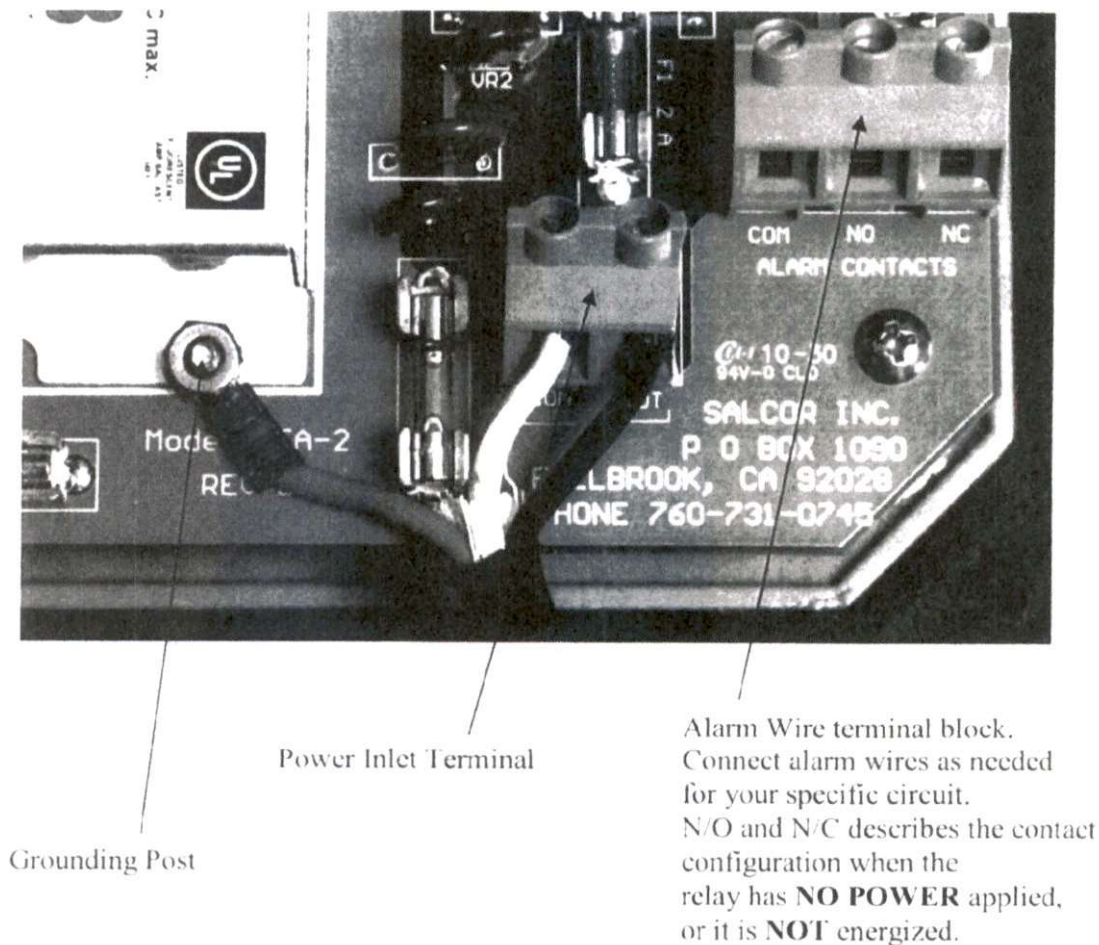

Figure 4



ENVIRONMENTAL

Zoeller Family of Water Solutions



PUMP COMPANY

Zoeller Family of Water Solutions

Zoeller Company

System Head Curve and Pump Selection Tool

Static Head Information		
Static Head - elevation difference from low water to outfall	7.0 feet	
System high point above outfall?	No	
Friction Head Information		
Pipe	1	
How many different pipes in the system (not counting laterals)?	1	
Pipe 1 Length	100 feet	
Pipe 1 Size	1 1/4 inches	
Pipe 1 Class	SCH 40	
Pipe 2 Size		
Pipe 2 Length		
Pipe 2 Class		
Pipe 3 Size		
Pipe 3 Length		
Pipe 3 Class		
Pressurized Laterals?	No	
How many are dosed at once?		
Length of one lateral		
Size of lateral		
Class of lateral		
Fittings & Discharge Assemblies		
Type	Size	Quantity
Discharge Assembly	1 1/4 inches	
Special Friction Considerations		
Weep Hole	Yes	1/8"
Add-In Friction	15% of Pipe Loss	
Automatic Multizone Valve?	No	
Pressure Filter?	No	
Operating Head Information		
System Type	Non-Pressurized	Specify Flow Requirement?
Number of Discharge Assemblies		Yes
Size of Discharge Assembly		
Spool Valve Control Style		
Control originates from Spool Valve		
Spring Type		
Factors and Coefficients		
Hazen-Williams C Factor	130	
Discharge Coefficient (Cd)	0.81	
Lateral Design Mode	Off	

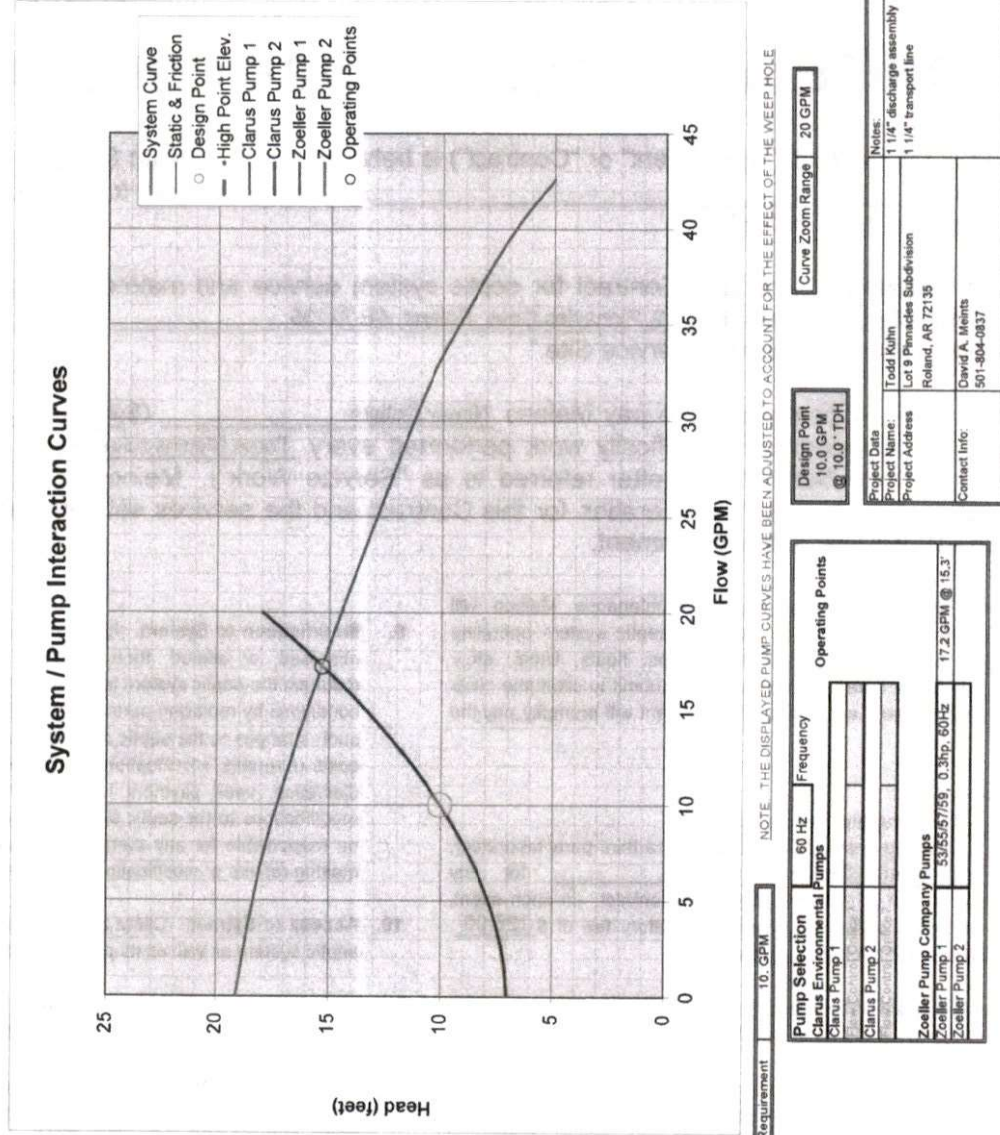

SERVICE AND MAINTENANCE CONTRACT

1. **Parties.** This contract ("Agreement" or "Contract") is between Meinco Septic Systems, Inc., ("Meinco") and Todd Kuhn, ("Client"), referred to individually as a "Party" and collectively as the "Parties."
2. **Service Location.** This is a Contract for septic system service and maintenance services provided by Meinco for Client located at Lot 9, Pinnacles Cove, Roland, AR 72135, hereinafter referred to as the "Service Site."
3. **Service Fees.** Client agrees to pay Meinco Ninety Dollars (\$90.00) for septic system service and maintenance specifically work performed every Three Months (Quarterly) and described more specifically below (hereinafter referred to as "Service Work"). Meinco and Client agree that the invoiced amount is good consideration for this Contract and the services set forth below and reflects the bargained for terms of this agreement.
4. **Materials Charges.** During regular maintenance Meinco will replace materials necessary to keep the septic system operating efficiently (chlorine tablets, UV light bulbs, floats, filters, etc.). Meinco and Client agree that Meinco shall submit to client the costs of maintenance parts and materials and Client will promptly pay the same.
5. **Laboratory Fees.**
 - A) ☐ This paragraph is inapplicable.
 - B) ☒ Client agrees that Meinco will use a third party laboratory, Environmental Services, Inc., for any sampling that is required under this Contract. In such event, Meinco shall submit to Client a laboratory fee of \$125.00 and Client will promptly pay the same.
6. **Services Provided.** Meinco agrees to provide the following Service Work to the Client and the Service Site:
 - A) Maintenance requirements, including review of system components and their working condition, monitoring of solid levels to determine system efficiency, and periodic cleaning of system filters or media.
 - B) I. ☒ This paragraph is inapplicable.
 II. ☐ Necessary sampling and submission of paperwork every month(s) or as required to comply with the Arkansas Department of Health Onsite Maintenance Program.
 - C) Necessary paperwork every 6 month(s) as required to comply with the Arkansas Department of Health and/or the Arkansas Department of Environmental Quality.
 - D) I. ☐ This paragraph is inapplicable.
 II. ☒ Sampling of discharge every 6 month(s) in coordination with a 3rd party laboratory for required laboratory tests.
7. **Contract Duration.** This contract shall be for a period of 24 month(s) from the date this Contract is executed by the parties on page 2
8. **Flow Requirements.** This contract shall be null and void if septic system flow exceeds 450 gallons per day.
9. **Modification to System.** If the septic system is modified, abused, mis-used, or altered, then Meinco's responsibility to service or maintain the septic system is terminated. Meinco may remedy such conditions by replacing parts or correcting defects. If Meinco makes such changes to the septic system, then it may charge to client the costs of repairs, modifications, parts, and labor. Meinco may, at its discretion, seek payment in advance of making any repairs or modifications to the septic system. In such event, Meinco shall not be responsible for any damage or adverse effects for its delay in making repairs or modifications to the septic system.
10. **Access to System.** Client agrees to provide Meinco access to the septic system as well as its parts and components.
11. **Termination by Client.** Client may terminate this contract by providing thirty (30) days written notice to Meinco.
12. **Termination by Meinco.** Notwithstanding, and in addition to, any other provision or term in this Contract, **MEINCO MAY TERMINATE THIS CONTRACT AT ANY TIME AND WITHOUT PREVIOUS NOTICE TO CLIENT.**
13. **Solid Removal.** Solid removal is not a covered service and shall incur an additional fee. If Meinco removes solids from the septic system, then it may charge to client the costs of solid removal. In any event, Meinco shall not be responsible for any damage or adverse effects for any delay in removing solids.
14. **Indemnity.** To the fullest extent permitted by law, Client shall indemnify, hold harmless, and defend Meinco and any agent or employees of Meinco from and against all injuries, claims, damages, losses, and expenses, including, but not limited to, attorneys' fees, arising directly or indirectly out of the obligations herein undertaken or resulting out of operations related to the Service Work or Service Site conducted by Meinco, Meinco's agents, anyone directly or indirectly employed by them or anyone for whose acts they may be liable, regardless of whether or not such injury, claim damage, losses, or expenses is caused in part by a party indemnified. Such obligation shall not negate, abridge, or otherwise reduce the rights or obligations of indemnity which would otherwise exist to a party or person described in this paragraph.

16. **Assignment.** Client agrees that even though this is a contract for services, Meinco may assign this Contract to any third party without written notice to Client.
16. **Bilateral Contract.** Meinco and client specifically agree that Client is seeking Meinco's promise to perform and not its performance.
17. **Claims Against Meinco.** Client shall give Meinco written notice of all claims within five (5) days of Client's knowledge of facts giving rise to the event for which claim is made. Otherwise, such claims shall be deemed waived by Client. All unresolved claims, disputes, and other matters in question between Meinco and Client shall be resolved in the manner provided for in this Agreement.
18. **Rights Upon Breach.** If Client breaches this Agreement with Meinco, Meinco may stop all work, including all Service Work. Additionally, Client will be liable to Meinco for consequential, incidental, and reliance damages as well as attorneys' fees and court costs. Such liability upon Client shall extend to petitions for and orders of contempt as well as any attempts by Meinco to collect upon any debt or damages owed to it by Client, including those entered by court of law or other dispute resolution proceeding.
19. **Direct Discussion.** If a dispute arises out of or relates to this Agreement, the Parties shall endeavor to settle the dispute through direct discussion before advancing to any dispute resolution proceeding.
20. **Joint Drafting.** The Parties expressly agree that this Agreement was jointly drafted and that this Agreement shall be construed neither against nor in favor of either Party. Instead, this Agreement shall be construed in a neutral manner.
21. **Choice of Law.** The Parties expressly agree that any dispute or claim filed or heard in any jurisdiction concerning or relating to this Agreement or worked performed as a result of this Agreement shall be governed by the laws of the State of Arkansas.
22. **Forum Selection and Choice of Venue.** The Parties expressly agree that any dispute or claim arising from, filed, or heard concerning or relating to this Agreement or work performed as a result of this Agreement shall be heard in Saline County, Arkansas, and no other forum. If this clause is penetrated and the hearing concerning the dispute removed to the United States federal court system, then the Parties expressly agree that the dispute shall be heard in the United States District Court for the Eastern District of Arkansas, Western Division, at the Richard Sheppard Arnold United States Courthouse in Little Rock, Arkansas.
23. **Waiver of Agreement Terms.** Meinco, at its sole discretion and leisure, may waive any term in this Agreement. Such waiver shall not, under any conditions or circumstances, constitute a modification of this Agreement. Additionally, such waiver shall not, under any conditions or circumstances, constitute a course of performance, course of dealings, or trade usage between Meinco and Client. Any waiver by Meinco shall be limited to a single incident or event. No waiver of any term of this Agreement is valid unless it is in writing, signed by Meinco, and attached to this Agreement as an addendum. It is the responsibility and duty of Client to draft any written waiver and to present it to Meinco for Meinco's approval and signature.
24. **Force Majeure.** Neither Party shall be in breach of its obligations under this Agreement (other than payment obligations) or incur any liability to the other Party for any losses or damages of any nature whatsoever incurred or suffered if and to the extent that the other party it is prevented from carrying out its obligations by, or such losses or damages are caused by, a *force majeure* event. For purposes of this paragraph, the failure of the state of Arkansas or the United States of America to act according to current practices, procedure, or law at the time of the making of this Contract shall be considered a *force majeure* event. Such event by the government shall be in addition to any current or commonly accepted definition of *force majeure* event.
25. **Merger and Integration.** Meinco and Client agree that this Agreement represents a full, final, and complete memorial of their Agreement for the Service Work and that this Agreement does not rely upon any term or promise not otherwise specified within the four corners of this Agreement.
26. **No Oral Modification.** Meinco and Client agree that this Agreement shall not be subject to oral modification. The Parties agree that any modification made or agreed to by the Parties shall be in writing, signed by both Parties, and attached to this Agreement as an Addendum.

By signing this Agreement below, I indicate that I have read this Agreement and its terms, consisting of two (2) pages, excluding any Addendum or Addenda, and that these express terms are both acceptable and agreeable to me. I further declare that these terms do not represent an undue hardship, are not illusory, and are not unconscionable as I have expressly bargained for these terms in consideration of entering into this Contract for the value specified in paragraph three (3).

Meinco Septic Systems, Inc.

02/18/2019

Date

Client



2/25/19
Date



Arkansas Department of Health

4815 West Markham, Slot 46
Little Rock, Arkansas 72205-3867

MEMORANDUM OF AGREEMENT

SUBJECT: ONSITE WASTEWATER SYSTEM APPLICATION

This is an agreement that the onsite wastewater system installed on this property has been permitted under authority of Act 402 of 1977 and by the Arkansas Department of Health with the understanding that the following provisions are met:

1. Onsite Wastewater Systems requiring a Monitoring Contract with a Certified Monitoring Personnel are Holding Tanks, Experimental Systems (i.e. Reduced Absorption Areas, *ABGs), and Drip Dispersal Systems. *Aerobic Biological Generators – Commercial applications only, residential applications must follow manufacturers' service contract requirements.
2. The property owner assumes all responsibility for the proper operation of the onsite wastewater system.
3. The property owner must maintain a monitoring contract with a licensed Certified Monitoring Personnel for the life of the system and retain Onsite Wastewater System Assessments (EHP-71), on file, for at least five (5) years.
4. The Arkansas Department of Health has no responsibility in the operation and maintenance of such systems.
5. That the Arkansas Department of Health may monitor the system as to its operation capabilities.
6. That the Arkansas Department of Health is granted permission to make such inspections as deemed necessary.
7. Subsurface systems with flows ≥ 3000 gpd and all surface discharging systems require the owner to file an additional permit application with the Arkansas Department of Environmental Quality (ADEQ).
8. **That, on the sale of the property, the owner of the property must disclose to the perspective buyer notice of this agreement and any permit requirements. The buyer is to sign memoranda, contracts or permit name change forms and submit these documents to the appropriate regulatory agency.**

SIGNED: _____

(Property Owner)

SIGNED: _____

(Health Department)

DATE: _____

2/25/19

DATE: _____

2-28-19

* Optional System Utilization Verification Form



Arkansas Department of Health
Environmental Health Protection

Receipt Number

Individual Onsite Wastewater System Permit Application

Permit Type

- ☒ New Installation
☐ Alteration / Repair

DR Environmental ID #

1601055547

☐ Homeowner

☒ Builder/Developer

Fee Schedule for Structures

Structures 1500 sq ft or less	<input type="checkbox"/>
\$ 30.00	
Structures more than 1500 sq ft and up to 2000 sq ft	<input type="checkbox"/>
\$ 45.00	
Structures more than 2000 sq ft and up to 3000 sq ft	<input type="checkbox"/>
\$ 90.00	
Structures more than 3000 sq ft and up to 4000 sq ft	<input checked="" type="checkbox"/>
\$ 120.00	
Structures more than 4000 sq ft	<input type="checkbox"/>
\$ 150.00	
Alteration and Repair	<input type="checkbox"/>
\$ 30.00	

TO THE PROPERTY OWNER

Onsite Wastewater System Utilization Verification

Property location: Pinnacles Subdivision Lot 9, Roland AR 72135
(Address of Proposed System, City, State, Zip)

I hereby attest there are 4 bedrooms (number of persons for commercial) and the square footage of the structure that will utilize the designed onsite wastewater system in this permit application is accurate. I have reviewed the permit application and understand the layout, installation, maintenance, operation and expense(s) that may be associated with this system.

As Developer/Builder, I hereby attest that the above information is correct and prior to the sale of the property, I will convey, to the buyer, all information associated with this system.

Owner/Applicant Signature

Date

2/25/19

This document must be submitted with the permit application, if the Owner/Applicant Signature Section (number 19 on the EHP-19) is not signed.



A Pulaski County Central Health, 3915 W 8th St, Little Rock, AR 72204

B 8300 Hood Rd, Roland, AR 72135

31 min , 18.0 mi

Light traffic (5 min delay)

Via AR-300, AR-10 · *Unpaved roads*

Pinnacles Subdivision

Lot 9, Pinnacles Cove

Roland, AR 72135

A Pulaski County Central Health

	1.	Depart W 8th St toward S Pine St	161 ft
	2.	Turn left onto S Pine St	305 ft
	3.	Turn left onto W 7th St	417 ft
	4.	Take ramp left for I-630 W	3.9 mi
	5.	At exit 8B , take ramp right and follow signs for I-430 North	2.6 mi
	6.	At exit 9 , take ramp right and follow signs for AR-10	0.3 mi
	7.	Bear right onto AR-10 E / Cantrell Rd	505 ft
	8.	Turn back on AR-10 W / Cantrell Rd	0.6 mi
	9.	Bear right onto AR-300 / AR-10 / Cantrell Rd Pass Wendy's in 4.4 mi	9.8 mi
	10.	Turn right onto Hood Rd • <i>Unpaved Road</i>	0.5 mi
		Arrive at Hood Rd	
	11.	The last intersection is AR-10 If you reach Twin Mountain Ln, you've gone too far	

B 8300 Hood Rd, Roland, AR 72135

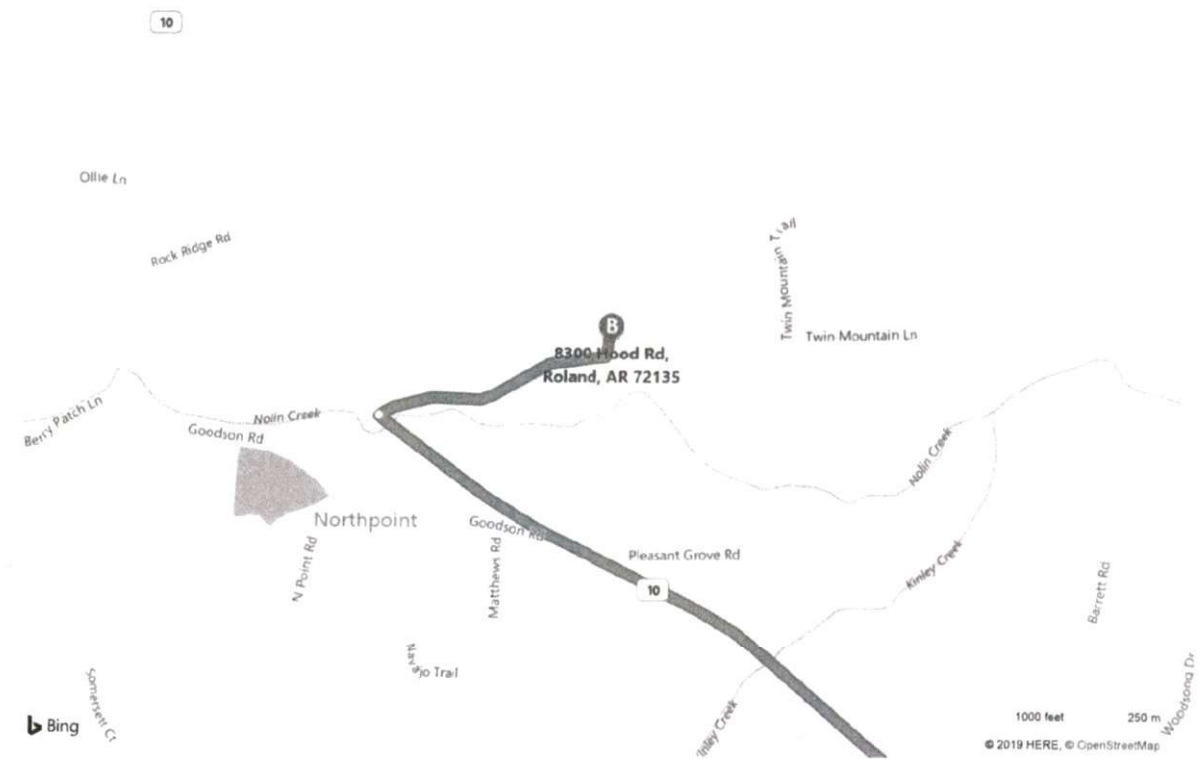

A Pulaski County Central Health, 3915 W 8t...



B 8300 Hood Rd, Roland, AR 72135

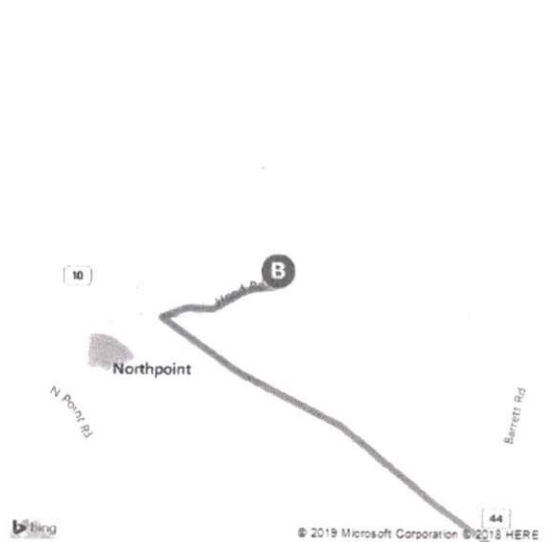

These directions are subject to the Microsoft® Service Agreement and are for informational purposes only. No guarantee is made regarding their completeness or accuracy. Construction projects, traffic, or other events may cause actual conditions to differ from these results. Map and traffic data © 2019 HERE™