

**ARKANSAS DEPARTMENT OF ENVIRONMENTAL QUALITY
NOTICE OF INTENT
INDIVIDUAL TREATMENT FACILITIES
NPDES GENERAL PERMIT ARG550000**

Application Type: New ☒ **Renewal** ☐ (Permit # ARG55 _____)

I. PERMITTEE/OPERATOR INFORMATION

Permittee (Legal Name): New Life Assembly of God, Monticello, Arkansas Operator Type:
Permittee Mailing Address: 1664 Highway 425 S ☐ State ☐ Partnership
Permittee City: Monticello ☐ Federal ☒ Corporation*
Permittee State: Arkansas Zip: 71655 ☐ Sole Proprietorship/Private
Permittee Telephone Number: 870-224-2288 *State of Incorporation: AR
Permittee Fax Number: NA The legal name of the Permittee must be
Permittee E-mail Address: aparke@newlifeforthecity.com identical to the name listed with the
Arkansas Secretary of State.

II. INVOICE MAILING INFORMATION (Home owners are exempt.)

Invoice Contact Person: Addie Parke City: Monticello
Invoice Mailing Company: 1664 Highway 425 S State: Arkansas Zip: 71655
Invoice Mailing Address: aparke@newlifeforthecity.com Telephone: 870-224-2288

III. FACILITY INFORMATION

Facility Name: New Life Assembly of God Facility Contact Person: Addie Parke
Facility Address: 1664 US 425 Telephone Number: 870-224-2288
Facility County: Drew Facility City, State & Zip: Monticello, Arkansas 71665
Facility Latitude: 33 Deg 34 Min 44.7 Sec Facility Longitude: 91 Deg 48 Min 2.8 Sec
Datum
Accuracy: _____ Method: _____ : _____ Scale: _____ Description: _____

IV. DISCHARGE INFORMATION

Outfall Number: 001 Flow: 1400 gpd (Gallons per Day)
Stream Segment: 2B Hydrologic Basin Code: 8040205
Outfall Latitude: 33 Deg 34 Min 43.9 Sec Outfall Longitude: 91 Deg 47 Min 57.4 Sec
Datum
Accuracy: _____ Method: _____ : _____ Scale: _____ Description: _____
Type of Treatment: Bio Microbics Microfast 0.9 with UV and Post Aeration (2)
Receiving Stream: Ouachita River

V. FACILITY PERMIT INFORMATION

NPDES Individual Permit Number (If Applicable): AR00
NPDES General Permit Number (If Applicable): ARG
State Construction Permit Number: _____
NPDES General Construction Stormwater Permit Number (If Applicable): ARR15

WATER DIVISION
5301 NORTHSHORE DRIVE / NORTH LITTLE ROCK, ARKANSAS 72118
PHONE 501-682-0623 / FAX 501-682-0880
www.adeq.state.ar.us

VI. OTHER INFORMATION:

Operator Name: David Meints

Operator License Number: 009055

License Class: III

Consultant Contact Name: David Meints

Consultant Email Address: david@meincowastewater.com

Consultant Address: PO Box 1001

City: Bryant

State: AR

Zip: 72089

Consultant Phone Number: 501-804-0837

Consultant Fax Number: 501-821-4048

Has this treatment system been approved by AHD? Yes ☒ No ☐

Disclosure Statements:

Arkansas Code Annotated Section 8-1-106 requires that all applicants for the issuance or transfer of any permit, license, certification or operational authority issued by the Arkansas Department of Environmental Quality (ADEQ) file a disclosure statement with their applications. The filing of a disclosure statement is mandatory. No application can be considered complete without one. You must submit a new disclosure statement even if you have one on file with the Department. The form may be obtained from ADEQ web site at: http://www.adeq.state.ar.us/disclosure_stmt.pdf.

VII. CERTIFICATION OF OPERATOR (please initial by hand – not typed in)

(Initial) "I certify that, if this facility is a corporation, it is registered with the Secretary of the State of Arkansas."

(Initial) "I certify that the cognizant official designated in this Application is qualified to act as a duly authorized representative under the provisions of 40 CFR 122.22(b). If no cognizant official has been designated, I understand that the Department will accept reports signed only by the Applicant."

(Initial) "I certify under penalty of law that this document and all attachments were prepared under my direction or supervision in accordance with a system designed to assure that qualified personnel properly gather and evaluate the information submitted. Based on my inquiry of the person or persons directly responsible for gathering the information, the information submitted is, to the best of my knowledge and belief, true, accurate, and complete. I am aware that there are significant penalties for submitting false information, including the possibility of fine and imprisonment for knowing violations."

Responsible Official Printed Name: Timothy Parker

Title: Lead Pastor

Responsible Official Signature: Timothy Parker

Date: 4.8.24

Responsible Official Email: Parker.timothy@city.com

Cognizant Official Printed Name: David Meints

Title: Class III Operator

Cognizant Official Signature: David Meints

Telephone: 501-804-0837

Cognizant Official Email: david@meincowastewater.com

X. PERMIT REQUIREMENT VERIFICATION

Please check the following to verify completion of permit requirements.

Yes No

* If No is answered for any of the questions, then a permit can not be issued!

Submittal of Complete NOI?

☒ ☐

Submittal of Required Permit Fee?

☒ ☐

Check Number:

Meinco #8906

Submittal of AHD Form EHP-19?

☒ ☐

Submittal of Site Map?

☒ ☐

Submittal of Disclosure Statement?

☒ ☐

WATER DIVISION
5301 NORTHSORE DRIVE / NORTH LITTLE ROCK, ARKANSAS 72118
PHONE 501-682-0623 / FAX 501-682-0880
www.adeq.state.ar.us

ARKANSAS DEPARTMENT OF ENVIRONMENTAL QUALITY DISCLOSURE STATEMENT

Instructions for the Completion of this Document:

- A. Individuals, firms or other legal entities with no changes to an ADEQ Disclosure Statement, complete items 1 through 5 and 18.
- B. Individuals who never submitted an ADEQ Disclosure Statement, complete items 1 through 4, 6, 7, and 16 through 18.
- C. Firms or other legal entities who never submitted an ADEQ Disclosure Statement, complete 1 through 4, and 6 through 18.

If Not Submitting by ePortal, Mail Original to:

ADEQ

DISCLOSURE STATEMENT

[List Proper Division(s)]

5301 Northshore Drive

North Little Rock, AR 72118-5317

1. APPLICANT: (Full Name)

New Life Assembly of God, Monticello, Arkansas

2. MAILING ADDRESS (Number and Street, P.O.Box Or Rural Route) :

1664 Hwy 425 S

3. CITY, STATE, AND ZIPCODE:

Monticello, Arkansas 71655

4a. Applicant Type:

☒ Individual ☐ Corporate or Other Entity

4b. Reason for Submission:

☒ Permit ☐ License ☐ Certification ☐ Operational Authority

☐ New Application ☐ Modification ☐ Renewal Application (If no changes from previous disclosure statement, complete number 5 and 18.)

4c. Division:

☐ Air ☒ Water ☐ Hazardous Waste ☐ Regulated Storage Tank ☐ Mining ☐ Solid Waste

5. Declaration of No Changes:

The violation history, experience and credentials, involvement in current or pending environmental lawsuits, civil and criminal, have not changed since the last Disclosure Statement that was filed with ADEQ on N/A

6. Describe the experience and credentials of the Applicant, including the receipt of any past or present permits, licenses, certifications or operational authorization relating to environmental regulation. (Attach additional pages, if necessary.)

N/A

7. List and explain all civil or criminal legal actions by government agencies involving environmental protection laws or regulations against the Applicant * in the last ten (10) years including:

1. Administrative enforcement actions resulting in the imposition of sanctions;
2. Permit or license revocations or denials issued by any state or federal authority;
3. Actions that have resulted in a finding or a settlement of a violation; and
4. Pending actions.

(Attach additional pages, if necessary.)

N/A

8. List all officers of the Applicant. (Add additional pages, if necessary.)

NAME: Timothy Parke TITLE: Lead Pastor
STREET: 1664 Hwy 425 S
CITY, STATE, ZIP: Monticello, AR - 71655

NAME: Jamaal Jones TITLE: Secretary of Deacon Board
STREET: 1664 Hwy 425 S
CITY, STATE, ZIP: Monticello, AR - 71655

NAME: _____ TITLE: _____
STREET: _____
CITY, STATE, ZIP: _____

9. List all directors of the Applicant. (Add additional pages, if necessary.)

NAME: N/A TITLE: _____
STREET: _____
CITY, STATE, ZIP: _____

NAME: _____ TITLE: _____
STREET: _____
CITY, STATE, ZIP: _____

NAME: _____ TITLE: _____
STREET: _____
CITY, STATE, ZIP: _____

10. List all partners of the Applicant. (Add additional pages, if necessary.)

NAME: N/A TITLE: _____
STREET: _____
CITY, STATE, ZIP: _____

NAME: _____ TITLE: _____
STREET: _____
CITY, STATE, ZIP: _____

NAME: _____ TITLE: _____
STREET: _____
CITY, STATE, ZIP: _____

11. List all persons employed by the Applicant in a supervisory capacity or with authority over operations of the facility subject to this application.

NAME: Addie Parke TITLE: Director of Operations
STREET: 1664 Hwy 425 S
CITY, STATE, ZIP: Monticello, AR - 71655

NAME: _____ TITLE: _____
STREET: _____
CITY, STATE, ZIP: _____

NAME: _____ TITLE: _____
STREET: _____
CITY, STATE, ZIP: _____

12. List all persons or legal entities, who own or control more than five percent (5%) of the Applicant's debt or equity.

NAME: N/A TITLE: _____

STREET: _____

CITY, STATE, ZIP: _____

NAME: _____ TITLE: _____

STREET: _____

CITY, STATE, ZIP: _____

NAME: _____ TITLE: _____

STREET: _____

CITY, STATE, ZIP: _____

13. List all legal entities, in which the Applicant holds a debt or equity interest of more than five percent (5%).

NAME: N/A TITLE: _____

STREET: _____

CITY, STATE, ZIP: _____

NAME: _____ TITLE: _____

STREET: _____

CITY, STATE, ZIP: _____

NAME: _____ TITLE: _____

STREET: _____

CITY, STATE, ZIP: _____

14. List any parent company of the Applicant. Describe the parent company's ongoing organizational relationship with the Applicant.

NAME: N/A _____

STREET: _____

CITY, STATE, ZIP: _____

Organizational Relationship:

15. List any subsidiary of the Applicant. Describe the subsidiary's ongoing organizational relationship with the Applicant.

NAME: N/A _____

STREET: _____

CITY, STATE, ZIP: _____

Organizational Relationship:

16. List any person who is not now in compliance or has a history of noncompliance with the environmental laws or regulations of this state or any other jurisdiction and who through relationship by blood or marriage or through any other relationship could be reasonably expected to significantly influence the Applicant in a manner which could adversely affect the environment.

NAME: N/A TITLE: _____

STREET: _____

CITY, STATE, ZIP: _____

NAME: _____ TITLE: _____

STREET: _____

CITY, STATE, ZIP: _____

17. List all federal environmental agencies and any other environmental agencies outside this state that have or have had regulatory responsibility over the Applicant.

N/A

18. VERIFICATION AND ACKNOWLEDGEMENT

The Applicant agrees to provide any other information the director of the Arkansas Department of Environmental Quality may require at any time to comply with the provisions of the Disclosure Law and any regulations promulgated thereto. The Applicant further agrees to provide the Arkansas Department of Environmental Quality with any changes, modifications, deletions, additions or amendments to any part of this Disclosure Statement as they occur by filing an amended Disclosure Statement.

DELIBERATE FALSIFICATION OR OMISSION OF RELEVANT INFORMATION FROM DISCLOSURE STATEMENTS SHALL BE GROUNDS FOR CIVIL OR CRIMINAL ENFORCEMENT ACTION OR ADMINISTRATIVE DENIAL OF A PERMIT, LICENSE, CERTIFICATION OR OPERATIONAL AUTHORIZATION.

COMPLETE THIS SECTION ONLY IF SUBMITTING OTHER THAN BY EPORTAL:

I, Timothy Parke, certify under penalty of law that this document and all attachments were prepared under my direction or supervision in accordance with a system designed to assure that qualified personnel properly gather and evaluate the information submitted. Based on my inquiry of the person or persons who manage the system, or those persons directly responsible for gathering the information, the information submitted is, to the best of my knowledge and belief, true, accurate, and complete. I am aware that there are significant penalties for submitting false information, including the possibility of fines and imprisonment for knowing violation.

APPLICANT
SIGNATURE:



TITLE: Lead Pastor

DATE: 4-8-2024



Arkansas Department of Health
Environmental Health Protection

Receipt Number

24469642

Individual Onsite Wastewater System Permit Application

Permit Type

- ☒ New Installation
☐ Alteration / Repair

DR Environmental ID #

7602132090

Fee Schedule for Structures

Structures 1500 sq ft or less	\$ 30.00	<input type="checkbox"/>
Structures more than 1500 sq ft and up to 2000 sq ft	\$ 45.00	<input type="checkbox"/>
Structures more than 2000 sq ft and up to 3000 sq ft	\$ 90.00	<input type="checkbox"/>
Structures more than 3000 sq ft and up to 4000 sq ft	\$120.00	<input checked="" type="checkbox"/>
Structures more than 4000 sq ft	\$150.00	<input checked="" type="checkbox"/>
Alteration and Repair	\$ 30.00	<input type="checkbox"/>

Part 1 Application

Treatment Type (check one)

Disposal Method (check one)

- ☐ STD = Standard Septic Tank
☐ ISF = Intermittent Sand Filter
☐ PMF = Proprietary Media Filter
☐ OTH = Other (Describe)
- ☒ ATU = Aerobic Treatment Plant
☐ RSF = Re-circulating Sand Filter
☐ RGF = Re-circulating Gravel Filter
☐ HLD = Holding Tank

- ☒ STD = Standard Absorption Field
☒ SUR = Surface Discharge
☐ CPF = Capping Fill
☐ OTH = Other
- ☐ LPD = Low Pressure Distribution
☐ HLD = Holding Tank
☐ SRL = Serial Distribution
☐ DRP = Drip Irrigation

1. Owner's/Applicant's Name

New Life Assembly of God

2. Phone Number

Michael Scott 870-723-6409

3. Mailing Address

1664 Hwy 425 S. Monticello, AR. 71655

4. County

Drew

5. Address of Proposed System (If a 911 address is not available, attach detailed directions or map)

Same As Above

6. Subdivision Name

none

7. Approval Date

none

8. Date Recorded

none

9. Lot Number

none

10. Lot Dimensions

See legal

11. Total Area (Acres)

22.625

12. # Bedrooms # People

300

13. Daily Flow (GPD)

1500 / 3 = 500

14. Brief Legal Description of Property (Attach a separate sheet of paper, if necessary)

S-14 T-13-S R-2-W

15. Water Supply (Specify supplier, if Public Water)

Monticello

16. GPS Coordinates

33.578910 - 91.799826

17. Loading Rates

(gpd/ft²)

18. System Specifications

Primary Area

N/A

a. Size of Septic Tank

See

gal

f. Trench Depth

\

inches

Secondary Area

N/A

b. Size of Dose Tank

Notes

gal

g. Trench Spacing

\

feet

Percolation Test

(min/in)

c. Absorption Area

none

ft²

h. Trench Media (List Below)

i. Trench Width

Primary Area Avg

\

d. Number of Field Lines

none

in

Secondary Area

\

e. Length of Field Lines

none

ft

in

TO THE OWNER

The permit for construction may be deemed invalid by the local Environmental Health Specialist before the start of construction, if the site and/or soil conditions have changed after approval of this permit, or if the information within this permit is inaccurate or has been found to be misrepresented. Approval for operation does not constitute a guarantee that the system will function properly. The approval states that the system was designed and installed according to the Arkansas Department of Health, Rules and Regulations Pertaining to Onsite Wastewater Systems, unless there are exceptions or deviations noted in the comments. A Permit for Construction is valid for one (1) year from the date of approval. The authorized agent must revalidate a permit more than one (1) year old prior to the start of any construction.

19. Utilization Verification

I hereby attest that item 12, the number of bedrooms (number of persons for commercial) and square footage of the structure that will utilize the designed individual onsite wastewater system in this permit application, is accurate. I have reviewed the permit application and understand the layout, installation, maintenance, operation and expense(s) that may be associated with this system.

Owner/Applicant Signature

Date

20. I certify that I have conducted the above tests and that the above listed information is in accordance with the latest requirements of the Arkansas Department of Health Rules and Regulations Pertaining to Onsite Wastewater Systems.

Designated Representative Signature

Title

Soil Certified ☒ Yes ☐ No

Kevin Castleberry

7/1/21

870-692-5742

Print Name

Date

Phone Number

21. Approval of Health Authority

The information and specifications in the application has been reviewed and found to meet the requirements of the Arkansas Department of Health Rules and Regulations Pertaining To Onsite Wastewater Systems. A PERMIT FOR CONSTRUCTION is hereby issued.

Environmental Specialist Signature

EHS Number

Date

#828

7/13/21

Individual Onsite Wastewater System Permit Application

Receipt Number

Continue Part 1

22. Soil Criteria (Primary Area)				Indicate the depth to items a-f, if observed in the soil (designate in inches)			
a. Bedrock	b. BSWT	c. MSWT	d. LSWT	e. Adj. MSWT	f. Adj. LSWT	g. H.C./Depth	h. Loading Rate (gpd/ft ²)
1	0"	6"	20"	N/A	N/A	1	N/A
23. Soil Criteria (Secondary Area)				Indicate the depth to items a-f, if observed in the soil (designate inches)			
a. Bedrock	b. BSWT	c. MSWT	d. LSWT	e. Adj. MSWT	f. Adj. LSWT	g. H.C./Depth	h. Loading Rate (gpd/ft ²)
1	0"	6"	20"	N/A	N/A	1	N/A
24. Seasonal Water Table (SWT) Classes Detail							
Primary Area		List Redoximorphic Features and/or Clay Content Restrictions					
Brief	0"	in	2.5yr 5/8				
Moderate	6"	in	" " 10yr 6/2				
Long	20"	in	> 50% CL				
Secondary Area		List Redoximorphic Features and/or Clay Content Restrictions					
Brief	0"	in	2.5yr 5/8				
Moderate	6"	in	" " 10yr 6/2				
Long	20"	in	> 50% CL				
Comments							

Part 2 Installation Inspection

Septic tank manufacturer	Pump information
Septic tank material	Trench media and width
Dose tank manufacturer	Depth of interceptor drain
Dose tank material	Depth of settled fill
Name of Installer	License Number
Installation Inspected by <input type="checkbox"/> Environmental Health Specialist <input type="checkbox"/> Designated Representative (check one or installer signs System Installation Verification below)	
Signature	EHS / License Number Date
System Installation Verification I have installed this system as designed and in compliance with all Rules and Regulations Pertaining to Onsite Wastewater Systems.	
Installer Signature	License Number Date

Part 3 Permit for Operation

The information contained in Part 1 and 2 of this form has been reviewed and found to meet the requirements of the Arkansas Department of Health. THE PERMIT FOR OPERATION of this system is hereby issued.			
Environmental Health Specialist	Signature	EHS Number	Date
Comments			
Site Revalidation conducted by <input type="checkbox"/> Environmental Health Specialist <input type="checkbox"/> Designated Representative (check one)			
Signature	EHS / License Number	Date	

1664 Hwy 425

683'

Drive/Parking Area

Proposed Church Bldg

Wilson Mill Rd

1488'

1336'

135'

2000 gallon Tank

2000 gallon Tank

A

2-line Spider Valve

Bm.

60'

A

U.V. Basin w/ 2 Salco B.G. Units

Sample Basin

1250 gallon tank w/ 0.9 PAST Unit

Point of Discharge

483'

Direction of Flow

Flow

200'

proposed

154'

117'

54'

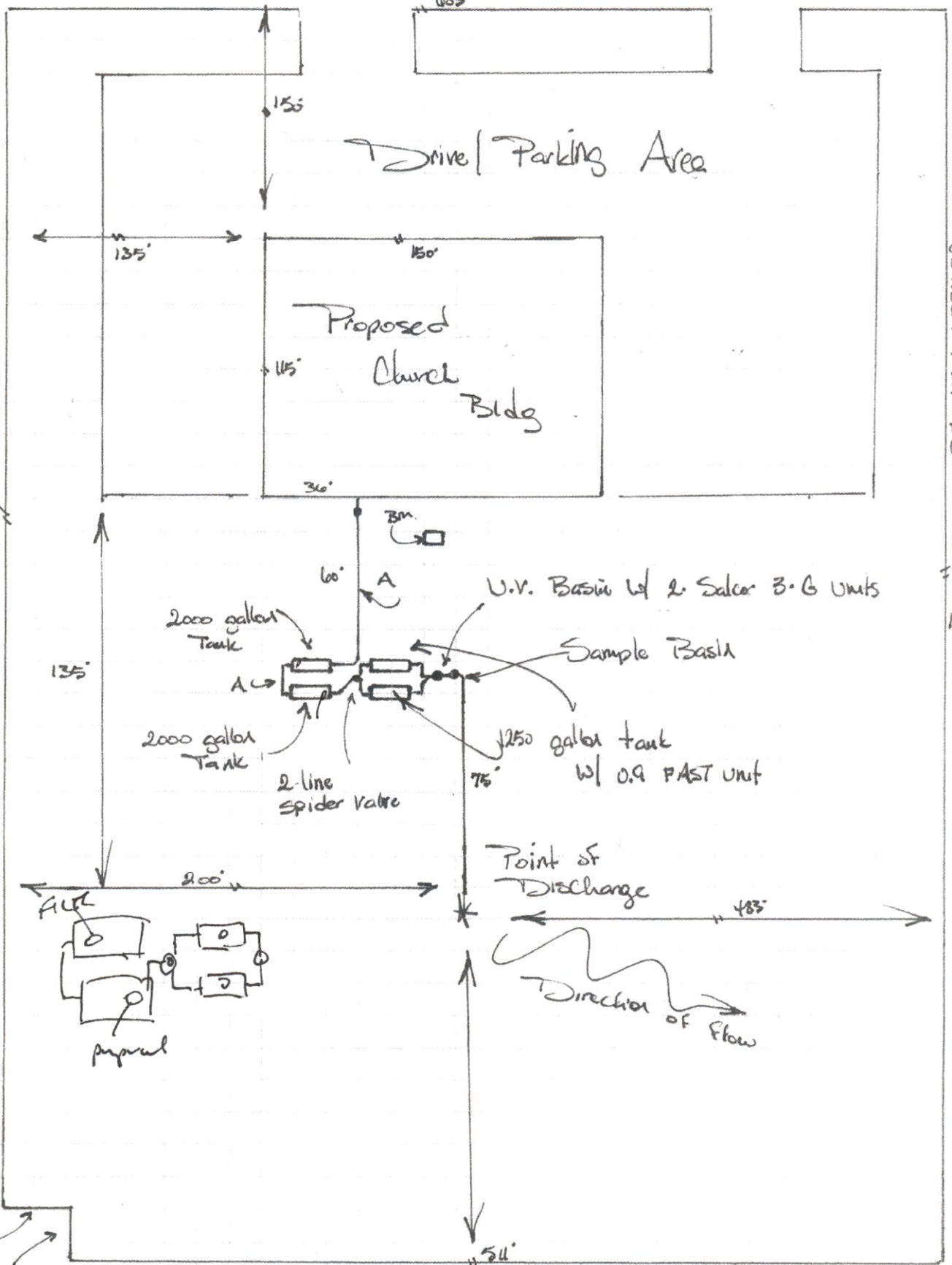

Elevations:

B.M. : 3.10"

	<u>G.E.</u>	<u>F.L.</u>
Stub Out:	4.4"	6.7"
Clear Out:	4.4"	6.7"

2000 gallon

IN : 5.9"
Out : 5.9"

7.8 1/2"
9.10"

Top of Tank

6.6"
6.6"

2000 gallon

IN : 6.0"
Out : 6.0"

9.10"
7.11"

6.6"
6.6"

Manifold : 5.10"

6.4"

1250 gallon w/FAST

IN : 5.9"
Out : 5.9"

7.5"
7.8"

6.6"
6.6"

1250 gallon w/FAST

IN : 6.0"
Out : 6.0"

7.5"
7.8"

6.6"
6.6"

U.V. Basin

IN : 6.0"
Out : 6.0"

7.10"
7.11"

Sample Port

IN : 6.0"
Out : 6.0"

8.0"
8.5"

P.O.D.

13.4"

13.4"

NOTES:

1. INSTALL (2) - 2000 GALLON TANKS. (SEE SPEC SHEETS) TANKS WILL BE SET AT THE SAME ELEVATION, AND BE CONNECTED AS FLOW LINE ELEVATIONS SHOW.
2. INSTALL A CLARUS DUPLEX PUMP VAULT ON THE OUTLET END OF THE SECOND TANK. SET PUMP OFF ELEVATION SO THAT THE SEPTIC TANKS WILL BOTH RETAIN A MINIMUM 1100 GALLONS OF BALLAST AT ALL TIMES.
3. INSTALL (2) - CLARUS 5030-0005 TURBINE PUMPS
4. INSTALL ZOELLER TIMED DOSE DUPLEX CONTROL PANEL. (10-0699) SEPTIC SYSTEM IS DESIGNED TO STORE UP TO 1500 GALLONS PER DAY FOR PEAK USAGE ON SUNDAYS AND WEDNESDAYS. THE EFFLUENT WILL BE TIME DOSED AT 500 GALLONS PER DAY OVER THE NEXT THREE DAYS WHILE THE CHURCH IS SITTING IDLE.
SET PUMP RUN TIME FOR 2 1/2 MINUTES AND OFF TIME FOR 27 1/2 MINUTES. THIS WILL DOSE APPROXIMATELY 24.5 GALLONS OF EFFLUENT PER DOSE 20 TIMES A DAY.
5. INSTALL A 2 LINE SPIDER VALVE TO EQUALLY DISTRIBUTE THE EFFLUENT BETWEEN BOTH .09 FAST UNITS.
6. INSTALL (2) - 1250 GALLON TANKS WITH 0.9 FAST UNITS AS SHOWN
7. INSTALL (2)- SALCOR 3G ULTRAVIOLENT LIGHTS AS SHOWN
8. INSTALL SAMPLE PORT WITH FLOW LINES AS SHOWN
9. DAYLIGHT TREATED EFFLUENT AS SHOWN.
10. BACKFILL AND BED ALL TANKS WITH CLEAN GRAVEL TO PREVENT SETTLING.
11. INSTALL ALL ELECTRICAL CONNECTIONS IN WATERTIGHT SPLICE BOXES.
12. EXTEND SEPTIC TANK RISERS ABOVE NATURAL GROUND ELEVATION.

LEGEND:

- (A) 4" SCH. 40 PIPE
- (B) 4" CLEAN OUT AND PLUG
- (C) SEPTIC TANK
- (D) DIST. BOX
- (E) 4" SDR 35 PIPE
- (F) FIELD LINE LATERALS

- (G) PIT #1
- (H) PIT #2
- (I) CURTAIN DRAIN
- (J)
- (K)
- (L)

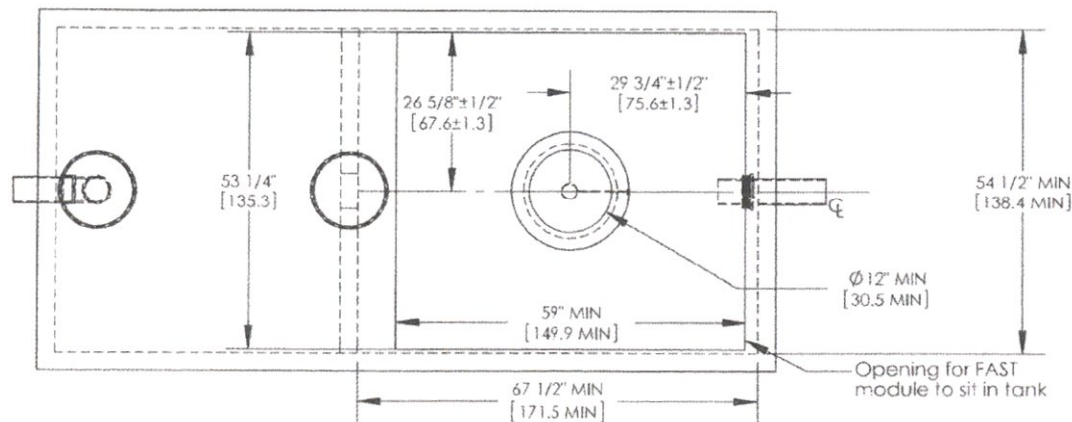
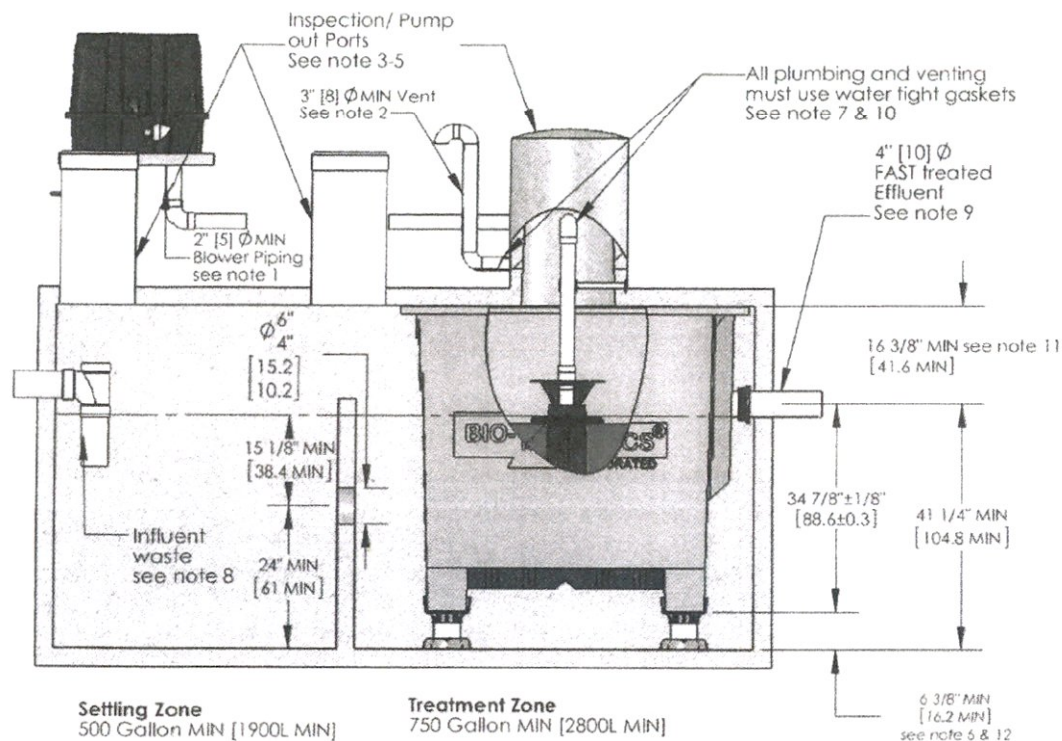

THE INFORMATION CONTAINED IN THIS DRAWING IS THE SOLE PROPERTY OF BIO-MICROBICS INC. ANY REPRODUCTION IN PART OR AS A WHOLE WITHOUT THE WRITTEN PERMISSION OF BIO-MICROBICS INC. IS PROHIBITED. DESIGN AND INVENTION RIGHTS ARE RESERVED. IN THE INTEREST OF TECHNOLOGICAL ADVANCEMENT, ALL PRODUCTS ARE SUBJECT TO DESIGN AND OR MATERIAL CHANGE WITHOUT NOTICE.

BIO-MICROBICS © 2014

NOTES

1. Airline piping to FAST® may not exceed 100 FT [30m] total length and have a maximum of 4 elbows in the piping system. For distances greater than 100 FT [30m] consult factory. Blower must be located above flood levels on a concrete base 26" X 20" X 2" [65 X 50 X 5cm] min.
2. Vent to desired location and cover opening with a vent grate with at least 7 sq.in.[45 sq. cm] open surface area. Secure with stainless steel screws. Vent piping must not allow condensate build up or create back pressure. Vent must be above finished grade or higher (see sheet 4 of 4).
3. All appurtenances to FAST® (e.g. tanks, access ports, electrical, etc.) must conform to all applicable country, state, province, and local plumbing and electrical codes. Pump out access shall be adequate to thoroughly clean out both zones.
4. All inspection, viewing and pump out ports must be secured to prevent accidental or unauthorized access.
5. Tank, piping, conduit, etc. are provided by others. Blower control system by Bio-Microbics, Inc. See Installation Manual.
6. If less than the specified minimums are considered necessary, consult factory for guidance.
7. All piping and ancillary equipment installed after FAST must not impede or restrict free flow of effluent.
8. The tank(s) shall be designed to prevent air passage between the settling zone/tank and the treatment zone and preventing an air lock. Examples include a baffle wall sealed to the lid or treatment zone inlet line with a pipe cap. Consult factory for guidance.
9. The air supply line into the FAST® unit must be secured to prevent vibration induced damage. The air supply line should be secured with a non-corrosive clamp every 2' min [60 cm]. See alternate air supply option on sheet 4 of 4.
10. Specialized treatment levels may require specific features to be incorporated into the tank design. Consult factory for guidance.
11. Min. height may be reduced, consult factory and reference "Low Profile Module Procedure.pdf"
12. Refer to sheet 4 of 4 for leg extensions requirements.

DO NOT SCALE		 BETTER WATER. BETTER WORLD.® MicroFAST 0.90 FAST Unit	
UNLESS NOTED			
DIMENSIONS			
ARE IN INCHES			
[CENTIMETERS]			
TOLERANCES			
± 0.02 IN/IN			
[± 0.05 CM/CM]			
WEIGHT	lb	SIZE	DRAWING NUMBER
NAME	DATE	A	MicroFAST® 0.90 with feet
DRAWN	CIC	12/18/2006	
CHECKED	IT	10/11/2013	
		REVISED	10/11/2013
		REV	INI-03-U

SHEET
2 OF 4

Specifications for MicroFAST 0.90 Wastewater Treatment System

1. GENERAL

The contractor shall furnish and install (1) MicroFAST@0.90 treatment system as manufactured by Bio-Microbics, Inc. The treatment system shall be complete with all needed equipment as shown on the drawings and specified herein.

The principal items of equipment shall include FAST@ system insert, leg extensions, or lid, blower assembly, blower controls and alarms. All other items will be provided by others. The MicroFAST 0.90 unit shall be situated within a 750 Gallon[2800L] minimum compartment as shown on the drawings. Suggested maximum settling zone is (1X) the daily flow. Tank must provide adequate pump out access and conform to local, state, and all other applicable codes. The contractor shall coordinate the proper fabrication of the tank between the tank and FAST system suppliers as well as the installation of the FAST unit, and delivery to the job site.

2. OPERATING CONDITIONS

The MicroFAST 0.90 treatment system shall be capable of treating the wastewater produced by typical family activities (bath, laundry, kitchen, etc.) ranging from (1) one to (11) eleven persons and not to exceed 900 US Gallons per day (3400LPD) provided the waste contains nothing that will interfere with biological treatment. The FAST system is a biological treatment system not meant for non-biodegradable or industrial wastewater.

3. MEDIA

The FAST media shall be manufactured of rigid PVC, polyethylene, or polypropylene and it shall be supported by the polyethylene insert. The media shall be fixed in position and contain no moving or wearing parts and shall not corrode. The media shall be designed and installed to ensure that sloughed solids descend through the media to the bottom of the septic tank.

4. BLOWER

The MicroFAST 0.90 unit shall come equipped with a regenerative type blower capable of delivering 17-25 CFM [31-46m3/hr]. The blower assembly shall include an inlet filter with metal filter element. The blower shall be mounted outside the tank on a contractor supplied concrete base. Blower piping to the tank shall use non-corrosive material (PVC, Galvanized, or Stainless Steel). Do not run galvanized pipe inside the treatment tank. Refer to Installation Manual for further details.

5. REMOTE MOUNTED BLOWER

The blower must not set in standing water and its elevation must be higher than the normal flood level. A two-piece, rectangular housing shall be provided. The discharge air line from the blower to the MicroFAST System, shall be provided and installed by the contractor.

6. ELECTRICAL

The electrical source should be within 150 feet [45 meters] of the blower, consult local codes for longer wiring distances. All wiring must conform to all applicable codes (IEC, NEC, etc.). Wiring distances must prevent significant voltage loss. Input power on 60Hz electrical systems 110/220VAC, 1Ø, 3.5/1.7 FLA, on 50 Hz electrical systems 220VAC, 1Ø, 1.9 FLA. Other voltages and phase are also available. Actual power consumption varies with site conditions. All conduit and wiring shall be supplied by contractor.

7. CONTROLS

The control panel provides power to the blower with an alarm system consisting of a visual and audible alarm capable of signaling blower circuit failure and high water conditions. The control panel is equipped with SFR® (Sequencing Fixed Reactor) timed control feature. A manual silence button is included.

8. INSTALLATION AND OPERATING INSTRUCTIONS

All work must be done in accordance with local codes and regulations. Installation of the FAST 0.90 shall be done in accordance with the written instructions provided by the manufacturer. Manuals shall be furnished, which will include a description of system installation, operation, and maintenance procedures.

9. FLOW AND DOSING

FAST systems have been successfully designed, tested and certified receiving gravity, demand-based influent flow. When influent flow is controlled by pump or other means to help with highly variable flow conditions, then multiple dosing events should be used to maximize performance. The flow rate shall not exceed 5 gpm (19 Lpm) with a maximum hourly flow not to exceed 10% of the design daily flow (90 gph (340 LPH)).

10. WARRANTY

Bio-Microbics, Inc. warrants all new residential FAST@ models (MicroFAST@0.50, 0.625, 0.75, 0.90, and 1.5) against defects in materials and workmanship for a period of two years after installation or three years from date of shipment whichever ever occurs first. All other FAST@ system models are warranted for a period of one year after installation or eighteen months from date of shipment, whichever occurs first. All are subject to the following terms and conditions below: During the warranty period, if any part is defective or fails to perform as specified when operating at design conditions, and if the equipment has been installed and is being operated and maintained in accordance with the written instructions provided by Bio-Microbics, Inc., Bio-Microbics, Inc. will repair or replace at its discretion such defective parts free of charge. Defective parts must be returned by owner to Bio-Microbics, Inc.'s factory postage paid, if so requested. The cost of labor and all other expenses resulting from replacement of the defective parts and from installation of parts furnished under this warranty and regular maintenance items such as filters or bulbs shall be borne by the owner. This warranty does not cover general system misuse, aerator components which have been damaged by flooding or any components that have been disassembled by unauthorized persons, improperly installed or damaged due to altered or improper wiring or overload protection. This warranty applies only to the treatment plant and does not include any of the structure wiring, plumbing, drainage, septic tank or disposal system. Bio-Microbics, Inc. reserves the right to revise, change or modify the construction and/or design of the FAST system, or any component part or parts thereof, without incurring any obligation to make such changes or modifications in present equipment. Bio-Microbics, Inc. is not responsible for consequential or incidental damages of any nature resulting from such things as, but not limited to, defect in design, material, or workmanship, or delays in delivery, replacements or repairs.

THIS WARRANTY IS IN LIEU OF ALL OTHER WARRANTIES EXPRESS OR IMPLIED. BIO-MICROBICS SPECIFICALLY DISCLAIMS ANY IMPLIED WARRANTY OF MERCHANTABILITY OR FITNESS FOR A PARTICULAR PURPOSE.

NO REPRESENTATIVE OR PERSON IS AUTHORIZED TO GIVE ANY OTHER WARRANTY OR TO ASSUME FOR BIO-MICROBICS, INC., ANY OTHER LIABILITY IN CONNECTION WITH THE SALE OF ITS PRODUCTS. Contact your local distributor for parts and service.

DO NOT SCALE

UNLESS NOTED
DIMENSIONS
ARE IN INCHES
[CENTIMETERS]
TOLERANCES
± 0.02 IN/IN
[± 0.05 CM/CM]

BIO MICROBICS

BETTER WATER. BETTER WORLD.™

MicroFAST 0.90 FAST Unit

WEIGHT	lb	SIZE	DRAWING NUMBER	SHEET 3 OF 4
NAME	DATE	A	MicroFAST@ 0.90 Specifications	
DRAWN CTC	12/18/2006			
CHECKED PF	10/11/2013	REVISED 10/11/2013	REV INH-07-T	

THE INFORMATION CONTAINED IN THIS DRAWING IS THE SOLE PROPERTY OF BIO-MICROBICS INC. ANY REPRODUCTION IN PART OR AS A WHOLE WITHOUT THE WRITTEN PERMISSION OF BIO-MICROBICS INC. IS PROHIBITED. DESIGN AND INVENTION RIGHTS ARE RESERVED. IN THE INTEREST OF TECHNOLOGICAL ADVANCEMENT, ALL PRODUCTS ARE SUBJECT TO DESIGN AND OR MATERIAL CHANGE WITHOUT NOTICE.

BIO-MICROBICS © 2014

Turbine STEP Vaults

Easily Add A Filtered Pump Chamber Without
Installing A New Tank



Features

- Vault heights from 51" to 120"
- All vaults fit in an 18" septic tank opening
- Preassembled packages with controls are available
- Accommodates 1/2 hp through 5 hp, 11 gpm through 85 gpm turbine pumps
- Vault inlet can be factory cut or field cut by the contractor
- Each turbine STEP vault includes a removable filter pack with a handle
- Incorporated filters screen solids to 1/16 inch.

ZOELLER 
PUMP COMPANY

Trusted. Tested. Tough.

zoellerpumps.com 800-928-7867
3649 Cane Run Road, Louisville, KY 40211 USA

CL0021
0121
SuperSedes
0119

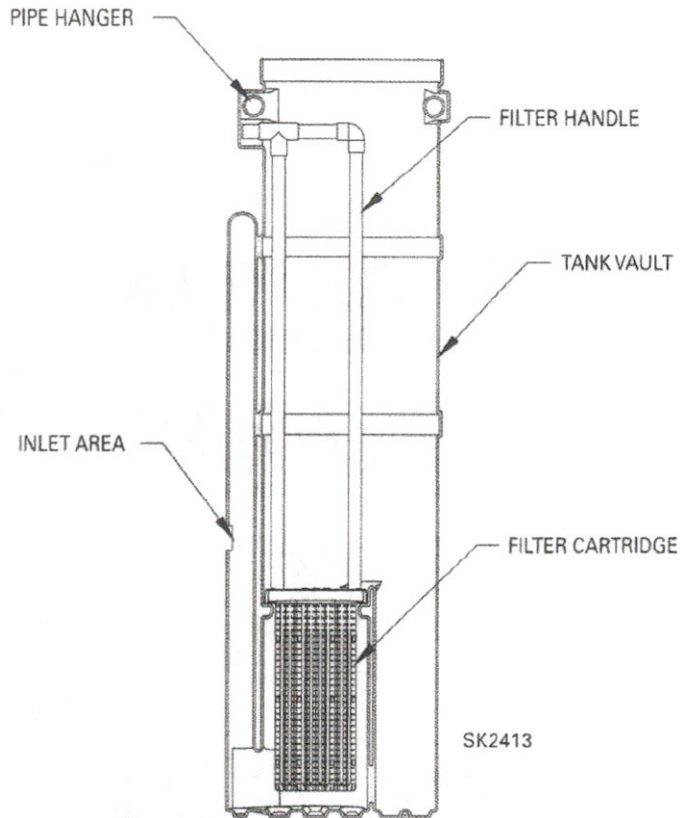

Zoeller Pump Company Turbine STEP Vaults include a filter pack with handle and are preassembled in the factory.

Filter Size: 1/16 Inch
Filter Slot length: 924 Linear Feet
Flow Rate: 7,000 GPD Max

Turbine STEP Vaults	
Part Number	Description
5041-0001	60" Factory cut, 2"x 5" inlet, 22.5" from bottom
5041-0002	60" Field cut
5041-0025	66" Field cut
5041-0026	72" Field cut
5041-0027	78" Field cut
5041-0028	84" Field cut
5041-0029	90" Field cut
5041-0030	96" Field cut
5041-0033	66" Factory cut, 2"x 5" inlet, 18" from bottom
5041-0034	51" Field cut
5041-0048	51" Factory cut, 2"x 5" inlet, 18" from bottom
5041-0049	120" Field cut
5041-0055	108" Factory cut, 2" x 5" inlet, 22.5" from bottom
5041-0056	108" Field cut

Product information presented here reflects conditions at time of publication. Consult factory regarding discrepancies or inconsistency. Copyright Zoeller Company. All rights reserved.



"QUALITY PUMPS SINCE 1939"

Product information presented here reflects conditions at time of publication. Consult factory regarding discrepancies or inconsistencies.

ZOELLER

PUMP CO.



SECTION: 3.20.140

FM1560

0106

Supersedes

0403

MAIL TO: P.O. BOX 16347 • Louisville, KY 40256-0347
SHIP TO: 3649 Cane Run Road • Louisville, KY 40211-1961
(502) 778-2731 • 1 (800) 928-PUMP • FAX (502) 774-3624

visit our web site:
www.zoeller.com

ZOELLER ON-SITE WASTEWATER PRODUCTS

INTRODUCING ZOELLER ON-SITE CONTROLS



Timed Dosing Dual Pump Control Panel

Motor Contactor Control Programmable Timed Dosing

Zoeller control panels provide residential and commercial customers with a reliable means of controlling both dosing chamber and media filter pumps in On-Site septic installations.

Dosing Chamber

A programmable timer activates a magnetic motor contactor to turn the dosing chamber pump on and off. A low or high water condition overrides the timer to prevent the pump from running dry or turns on the pump via the timer override float. A high water condition in the pump chamber activates the alarm.

Media Filter

A float in the media filter tank activates a magnetic contactor to turn the media filter pump on and off. A high water condition in the media filter basin activates the alarm and turns off the pump in the dosing chamber.

Common applications include media filter systems, pressure distribution systems, mound systems, or any application requiring a timed dose.

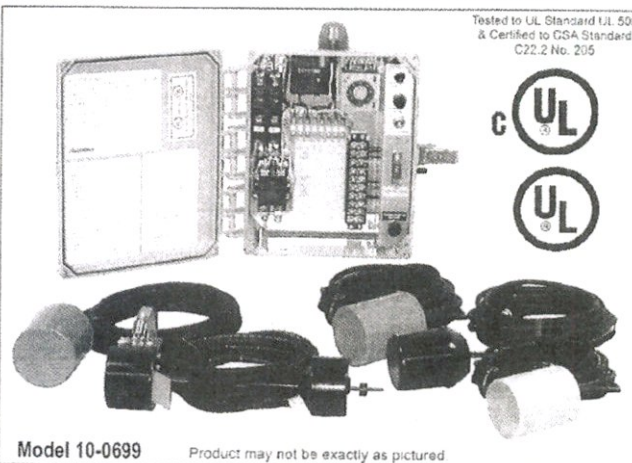

Model 10-0699

Product may not be exactly as pictured

Tested to UL Standard UL 509
& Certified to CSA Standard
C22.2 No. 205



1. **Programmable Timer** - features variable control to allow for dosing chamber on/off time settings from 0.5 seconds to 30 hours.
2. **Ratings Label.**
3. **Red Alarm Beacon** - provides 360° visual check of alarm condition.
4. **Schematic diagram** (loose in enclosure).
5. **Dosing Chamber Circuit Breaker** - provides dosing chamber pump disconnect.
6. **Media Filter Circuit Breaker** - provides media filter pump disconnect.
7. **Elapsed Time Meter** - for Media Filter pump monitoring.
8. **Power and Media Filter Pump Terminal Block** - includes terminals for separate pump and control power.
9. **Spare Fuse.**
10. **Exterior Horn Silence/Test Switch** - allows alarm horn to be silenced and allows alarm to be tested.
11. **Alarm Horn** - provides audio warning of alarm condition.
12. **Pump Specifications Label.**
13. **Tested Stamp.**
14. **Timer Instruction Label.**
15. **UL Label.**
16. **Ground Lug.**

17. **Float Switch Terminal Block.**
18. **Dosing Chamber Magnetic Motor Contactor** - controls the pump by switching both electrical lines.
19. **Backplate Hookup Diagram Label.**
20. **Media Filter HOA Switches** - provides manual control of the pumps.
21. **Control Fuse.**
22. **Dosing Chamber HOA Switch** - provides manual pump control.
23. **Alarm Fuse.**

Note: All variable level float switches in this section are mechanically activated and do not contain mercury.

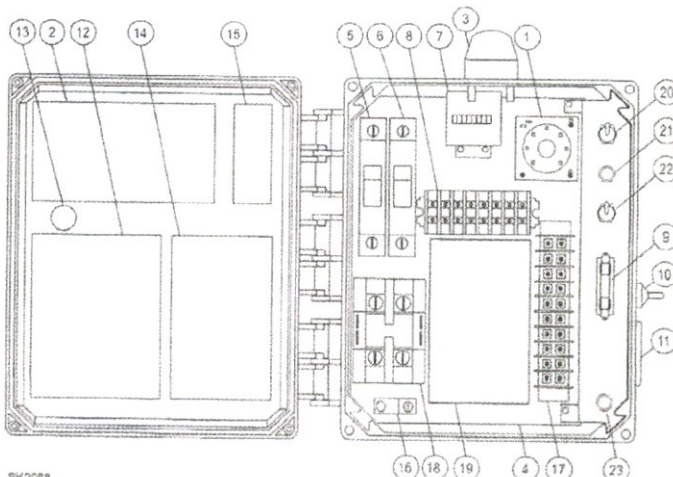

5K2058

Part Number	Voltage/Phase	Dosing Chamber FLA	Media Filter FLA
10-0699	120V/1 Ph	0-20 Amps	0 - 13 Amps
10-0701	230V/1 Ph	0-20 Amps	0 - 20 Amps

SPECIFICATIONS

Enclosure: NEMA 4X, ultraviolet stabilized, noncorrosive engineered thermoplastic for indoor and outdoor use with removable mounting flanges.
10"x 8"x 4" (120V); 12" x 10" x 6" (230V)

Alarm/Control Section Voltage: 120 VAC, 60 Hz, single phase, 40 watt maximum (alarm condition).

Pump Section:

- 120 Volt Models - 120 VAC, 60 Hz, single phase, 0-20 FLA (dosing chamber), 0-13 FLA (media filter).
- 230 Volt Models - 230 VAC, 60 Hz, single phase, 0-20 FLA (dosing chamber and media filter).

STANDARD FEATURES

- **UL Labeled** - entire control system (panel and switches) meets and/or exceeds industry safety standards.
- **Complete Package** - package includes the low level cutout, timer override and high water alarm variable level float switches for the dosing chamber, also the on/off and high water alarm switches for the media filter.
- **Installation Instructions** - complete step-by-step instructions allow for easy installation.
- **Lockable Latch** - Added security and protection for your system.
- **Two-Year Limited Warranty** - our commitment to customer satisfaction.
- **Redundant off circuit** (redundant off float sold separately) - protection against primary switch failure.
- **Elapsed Time Meter for Media Filter Pump** - allows monitoring of hours run.

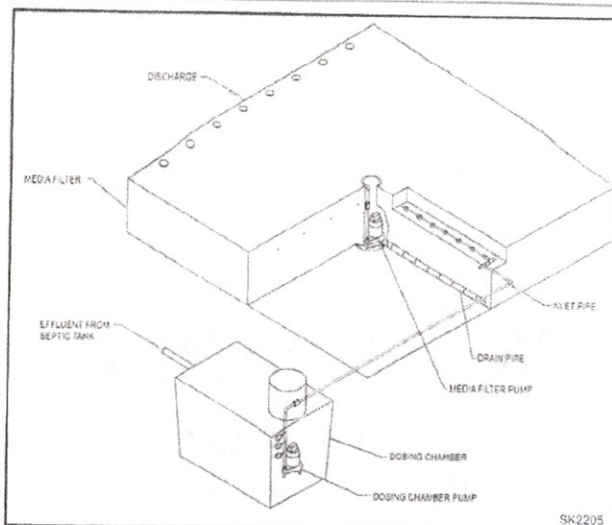

Typical Single Pass Media Filter

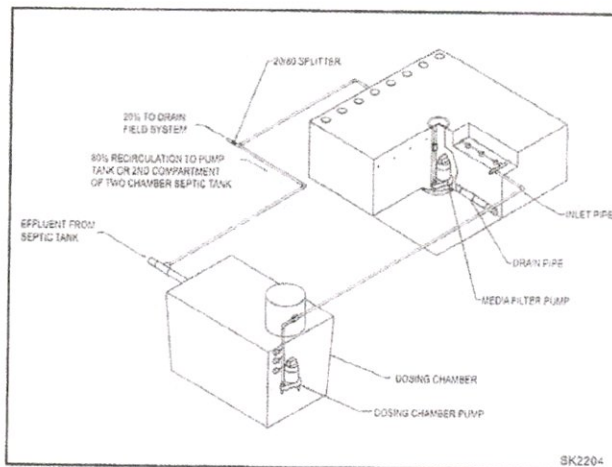

Typical Recirculating Media Filter

SEQUENCE OF OPERATIONS FOR DUAL PUMP TIMED DOSING

Dual pump Timed Dosing Panels control both dosing chamber and media filter pumps. Both pumps operate independently except as noted.

- Operation can begin after the following:
 - Correct voltage is supplied to the panel.
 - A good ground is supplied to the panel.
 - Pumps are connected correctly to panel or starter pak.
 - Panel circuit breakers are closed.
 - Floats are installed properly.
 - Pump HOA Switches are set to "Auto".

Dosing Chamber System:

The dosing chamber circuit will work with two, three, or four float combinations.

- In a two float system, one float in the tank is the "Low Level Cutout" float while the other is a "High Level Alarm" float. The normal operating level should be between the "Low Level Cutout" position and the "High Level Alarm" position.
- The control panel begins timing the "Off" sequence when the "Low Level Cutout" float is activated. Once the timer completes the "Off" sequence, the timer will start the pump and continue to run until the programmed "On" sequence is completed. At this point the "Off" sequence begins timing again and the cycle repeats.

- In the event the liquid level continues to rise, the "Alarm" float switch will be closed. When the "Alarm" float switch is closed, the following will occur:
 - The external high water light will illuminate.
 - The audible high water horn will sound.
- The audible high water horn can be silenced by flipping the alarm silence switch. The horn silence relay automatically resets the alarm after the high water condition has been resolved.
- The three float system adds a "Timer Override" float. The "Timer Override" float gives you the option of pumping from the basin while the timer is in the "Off" cycle. It is only intended for times of abnormally high liquid level intrusions. The normal operating level should be between the "Low Level Cutout" float and the "Timer Override" float.
- A four float system includes a "Redundant Off" float, a "Low Level Cutout" float, a "Timer Override" float and a "High Level Alarm" float. The "Redundant Off" float is positioned slightly below the "Low Level Cutout" float, but above the pump. The normal operating level should be between the "Low Level Cutout" position and the "Timer Override" position. The "Redundant Off" and the "Low Level Cutout" float switches must be closed for the pump to operate on the timer.

Media Filter System:

- Operation can begin after the following:
 - STEP 1 in the dosing chamber system has been completed.
- A media filter system requires two floats: The media filter pump "On/Off" float and the media filter "High Level Alarm" float. The "High Level Alarm" float activates the audio/visual alarm and stops the dosing chamber pump from dosing the media filter.
- A circuit is provided to install a "Redundant Off" float in the media filter if required.

ALL ZOELLER ON-SITE WASTEWATER PRODUCTS MUST BE INSTALLED IN ACCORDANCE WITH LOCAL AND/OR STATE PLUMBING AND/OR HEALTH DEPARTMENT CODES.

"QUALITY PUMPS SINCE 1939"

Product information presented here reflects conditions at time of publication. Consult factory regarding discrepancies or inconsistencies.

ZOELLER
PUMP CO.



MAIL TO: P.O. BOX 16347 • Louisville, KY 40256-0347
SHIP TO: 3649 Cane Run Road • Louisville, KY 40211-1961
(502) 778-2731 • 1 (800) 928-PUMP • FAX (502) 774-3624

SECTION: 3.20.022

FM2091

1108

Supersedes

0108

visit our web site:
www.zoeller.com

ZOELLER ONSITE WASTEWATER PRODUCTS

Multi-Stage Effluent Turbine Submersible Pumps



Effluent turbine pumps are used in onsite applications that demand more head than a traditional single stage centrifugal submersible pump. Zoeller Pump Company is able to meet this need by offering a complete line of submersible effluent turbine pumps. These pumps have been proven in field applications and have many years of development behind them. Typical applications include mound systems, drip systems, and recirculating media filters. All units include cool running submersible motors that do not require external water flow to prevent overheating. An outer pump sleeve is not required. Pumps can be installed directly in a dose tank as long as an effluent filter is used on the septic tank outlet. These pumps can also be used in conjunction with the Zoeller Effluent Turbine Filtered STEP system.

FEATURES:

- Corrosion resistant.
- Many models available - 11, 19, 27, 35, 55 and 85 GPM.
- 1/2 thru 3 HP units.
- 115 and 230 Volt.
- 1-1/4" discharge (11, 19, 27 GPM) or 2" discharge (35, 55 and 85 GPM).
- Heavy wall stainless steel pump shell.
- Franklin Electric submersible motors.
- Stainless steel hex drive pump shaft.
- High efficiency floating stack.
- Glass-filled Noryl discharge and mounting ring (11, 19, and 27 GPM models).
- Stainless steel discharge and mounting ring (35, 55 and 85 GPM models).
- No external capacitors or relays required for starting (1/2 - 1 1/2 HP).
- Starting box provided for 2 & 3 HP units.
- External check valves available.
- Pressure effluent filter available.
- 10 feet of jacketed SO type power cord (1/2 - 1 1/2 HP units only). Consult Factory for longer lengths.
- Timed dosing panels available.
- 5 year extended warranties available. (Consult Factory for details.)
- Dry run capable for up to 24 hours without damage (1/2 - 1 1/2 HP units only).

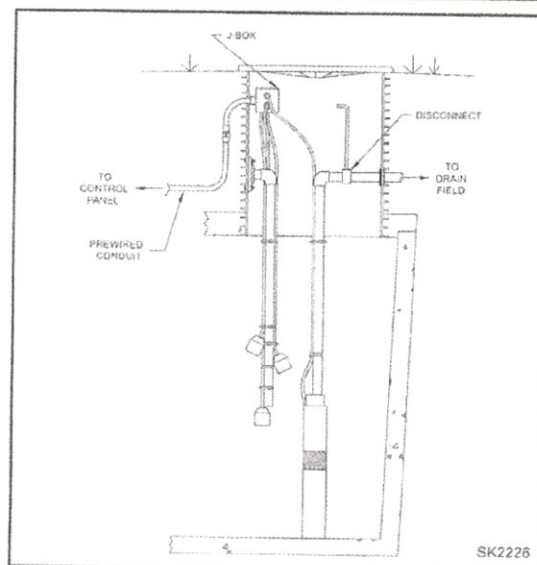

Multi-Stage Effluent Turbine Submersible Pumps

11 GPM Models

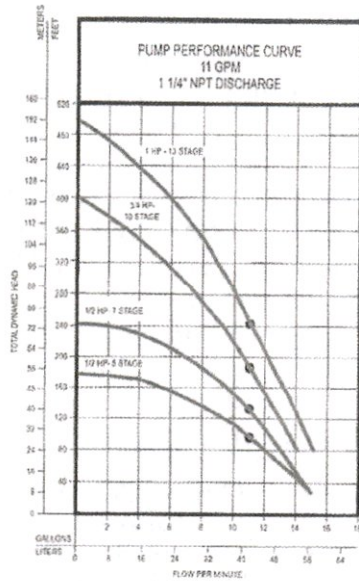

015413

Part Number	H P	Voltage	Phase	Amps	Stages	Height
5030-0005	1/2	115	1	12.0	5	21-1/2"
5030-0006	1/2	230	1	6.0	5	21-1/2"
5030-0007	1/2	115	1	12.0	7	23-1/8"
5030-0008	1/2	230	1	6.0	7	23-1/8"
5030-0009	3/4	230	1	8.0	10	27-1/16"
5030-0012	1	230	1	9.8	13	30-13/16"

19 GPM Models

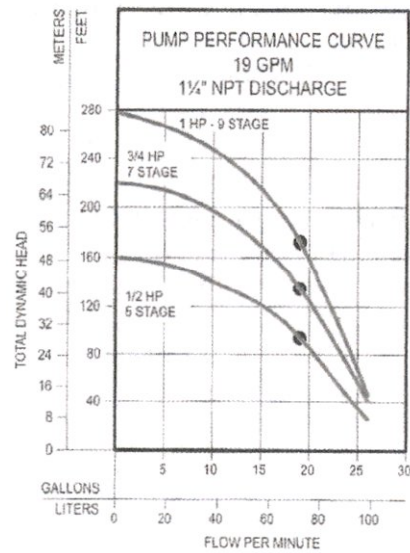

015414

Part Number	H P	Voltage	Phase	Amps	Stages	Height
5031-0005	1/2	115	1	12.0	5	21-15/16"
5031-0006	1/2	230	1	6.0	5	21-15/16"
5031-0007	3/4	230	1	8.0	7	25-1/16"
5031-0008	1	230	1	9.8	9	28-1/8"

27 GPM Models

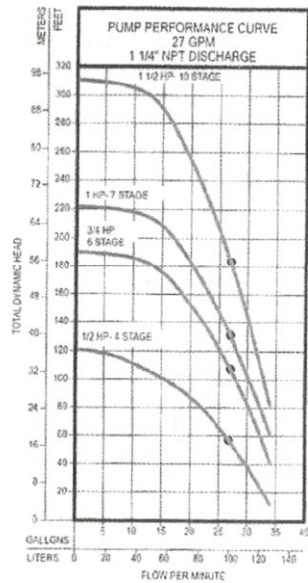

015045

Part Number	H P	Voltage	Phase	Amps	Stages	Height
5032-0005	1/2	115	1	12.0	4	21-1/8"
5032-0006	1/2	230	1	6.0	4	21-1/8"
5032-0007	3/4	230	1	8.0	6	24-5/16"
5032-0008	1	230	1	9.8	7	26-7/16"
5032-0009	1-1/2	230	1	13.1	10	31-7/8"

35 GPM Models

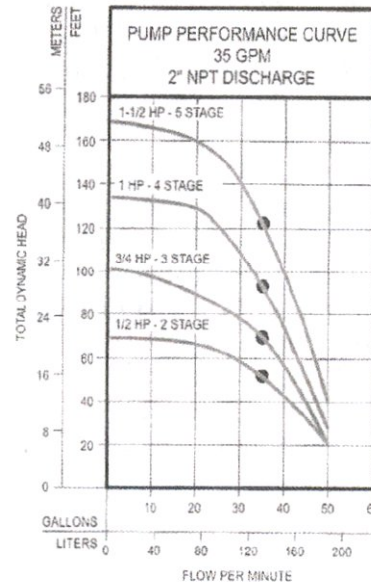

015044

Part Number	H P	Voltage	Phase	Amps	Stages	Height
5033-0005	1/2	115	1	12.0	2	19-7/16"
5033-0006	1/2	230	1	6.0	2	19-7/16"
5033-0007	3/4	230	1	8.0	3	22-3/16"
5033-0008	1	230	1	9.8	4	24-15/16"
5033-0009	1-1/2	230	1	13.1	5	29-15/16"

Since 1978

SALCOR INC

Innovative UV Excellence

DESCRIPTION

The Salcor 3G unit disinfection chamber couples directly to the aerobic plant discharge pipe and is permanently installed below grade. One ultraviolet lamp is mounted in a sub-assembly which can be easily inserted or removed through the top of the riser pipe for periodic servicing.

The disinfection subassembly causes the wastewater entering one side of the unit to flow vertically downward, make an 180 degree turn, and then flow vertically upward and out the other side of the unit. This well-defined flow path is designed to give the fluid proper exposure time under turbulent flow. No short circuiting.

The ultraviolet lamp is surrounded by a clear fused quartz tube to control the lamp surface temperature. A clear Teflon® film covers the quartz tube to minimize surface fouling. When the disinfection chamber is filled with water, the ultraviolet lamp can operate continuously, whether or not water is flowing.

The 3G unit may be installed in a pump tank, or it may be installed in the ground. See Installation Manual for details.

Properly installed, the 3G unit is rated NEMA 6P, (Floodproof), and is capable of operating during short term submergence. The unit passed a 30 day underwater test by Underwriters Laboratories and is UL & CSA certified, (listed) under UL Standard 979.

The electrical subassembly is mounted in a junction box located on top of the 4-inch riser pipe. A printed circuit board contains fuses, alarm circuitry, UV lamp ballast, power cable connections, voltage surge protection, and electronic noise filters.

The board is mounted to the underside of the junction box lid. This simplifies installation and mitigates effects of humidity in the junction box.

The 3G alarm relay circuit triggers an external alarm to warn the user when the UV lamp is not operating properly. Electronic components in the circuit sense changes in the UV lamp operation which correlate with the germicidal ultraviolet output.

When the UV lamp is producing ultraviolet germicidal light at a safe level, a green LED indicator light, located on the top of the electrical junction box, glows, which indicates proper UV lamp operation. The light stops glowing when the light output from the UV lamp falls below a safe level or is not operating.

DESIGN PARAMETERS

- Maximum flow rate: 3 GPM for 30:30 effluent 6 GPM for 10:10 effluent.

- Power use is 40 Watts. Energy use is 0.96 k hr/day, assuming continuous operation.
- UV lamp is low pressure mercury, 90 % of output at 253.7 nanometers. Minimum arc length 30 inches, and the UV intensity is greater than 1 microwatts/cm² at one meter. The unit and the "Long Life lamp" are warranted for 2 years.
- UV dose is greater than 55 mJ/cm² (55,000 microwatt-seconds/cm²).
- UV Lamp Ballast is 90 % efficient, high frequency operation (50 kHz) with thermal link protection. Input Voltage is 120 VAC at 50 or 60 Hz. Input current is up to 0.5 amps.

TWENTY-ONE 3G UV 6 MONTH TESTS

Since 1997, Manufacturers of 21 Treatment Units Have Partnered with the Salcor 3G UV Unit. Each Used the NSF Standard 40 and 1 Washington State Fecal Coliform Reduction Protocol for 26 weeks. SALCOR'S 3G UV Effluent Fecal Coliform Count Ranged From 2 to 35 per 100 mL. (Geometric Mean).

- Aero-Tech
- AK Industries, Hydro Action
- ANUA (Bord na Mona)
- Aqua Klear
- Bio Microbics, Microfast 0.5
- Clearstream
- Consolidated Treatment, Enviroguard .75
- Consolidated Treatment, Multiflo
- Consolidated Treatment, Nyadic
- Delta Whitewater, DF 60
- Delta Whitewater, Ecopod
- Ecological Tanks, Aqua Safe
- Enviro Flo
- Fuji Clean USA
- Hoot Aerobics
- Jet Inc.
- Lowridge Onsite Technologies
- Norweco - Singulair
- Orenco, AX 20N
- Quanics, ATS-CSAT-8-AC-C500
- Solar Air

Residential, Commercial, Municipal Applications

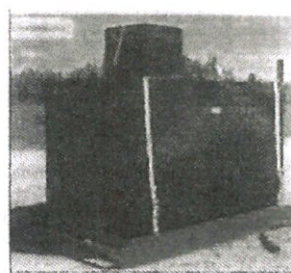
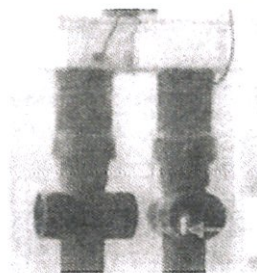



Arkansas Department of Health

4815 West Markham, Slot 46
Little Rock, Arkansas 72205-3867

MEMORANDUM OF AGREEMENT

SUBJECT: ONSITE WASTEWATER SYSTEM APPLICATION

This is an agreement that the onsite wastewater system installed on this property has been permitted under authority of Act 402 of 1977 and by the Arkansas Department of Health with the understanding that the following provisions are met:

1. Onsite Wastewater Systems requiring a Monitoring Contract with a Certified Monitoring Personnel are Holding Tanks, Experimental Systems (i.e. Reduced Absorption Areas, *ABGs), and Drip Dispersal Systems. *Aerobic Biological Generators – Commercial applications only, residential applications must follow manufacturers' service contract requirements.
2. The property owner assumes all responsibility for the proper operation of the onsite wastewater system.
3. The property owner must maintain a monitoring contract with a licensed Certified Monitoring Personnel for the life of the system and retain Onsite Wastewater System Assessments (EHP-71), on file, for at least five (5) years.
4. The Arkansas Department of Health has no responsibility in the operation and maintenance of such systems.
5. That the Arkansas Department of Health may monitor the system as to its operation capabilities.
6. That the Arkansas Department of Health is granted permission to make such inspections as deemed necessary.
7. Subsurface systems with flows ≥ 3000 gpd and all surface discharging systems require the owner to file an additional permit application with the Arkansas Department of Environmental Quality (ADEQ).
8. **That, on the sale of the property, the owner of the property must disclose to the perspective buyer notice of this agreement and any permit requirements. The buyer is to sign memoranda, contracts or permit name change forms and submit these documents to the appropriate regulatory agency.**

SIGNED:  SIGNED: _____
(Property Owner) (Health Department)

DATE: 7.1.21 DATE: _____

SERVICE AND MAINTENANCE CONTRACT

1. **Parties.** This contract ("Agreement" or "Contract") is between Meinco Septic Systems, Inc., ("Meinco") and New Life Assembly of God, ("Client"), referred to individually as a "Party" and collectively as the "Parties."
2. **Service Location.** This is a Contract for septic system service and maintenance services provided by Meinco for Client located at 775 Edgewood Street, Monticello, Arkansas 71655, hereinafter referred to as the "Service Site."
3. **Service Fees.** Client agrees to pay Meinco Three hundred twenty five (\$ 325) for septic system service and maintenance specifically work performed every Three Months (Quarterly) and described more specifically below (hereinafter referred to as "Service Work"). Meinco and Client agree that the invoiced amount is good consideration for this Contract and the services set forth below and reflects the bargained for terms of this agreement.
4. **Materials Charges.** During regular maintenance Meinco will replace materials necessary to keep the septic system operating efficiently (chlorine tablets, UV light bulbs, floats, filters, etc.). Meinco and Client agree that Meinco shall submit to client the costs of maintenance parts and materials and Client will promptly pay the same.
5. **Laboratory Fees.**
 - A) ☐ This paragraph is inapplicable.
 - B) ☒ Client agrees that Meinco will use a third party laboratory, Environmental Services, Inc., for any sampling that is required under this Contract. In such event, Meinco shall submit to Client a laboratory fee of \$ 150.00 and Client will promptly pay the same.
6. **Services Provided.** Meinco agrees to provide the following Service Work to the Client and the Service Site:
 - A) Maintenance requirements, including review of system components and their working condition, monitoring of solid levels to determine system efficiency, and periodic cleaning of system filters or media.
 - B) I. ☒ This paragraph is inapplicable.
 II. ☐ Necessary sampling and submission of paperwork every month(s) or as required to comply with the Arkansas Department of Health Onsite Maintenance Program.
 - C) Necessary paperwork every 3 month(s) as required to comply with the Arkansas Department of Health and/or the Arkansas Department of Environmental Quality.
 - D) I. ☐ This paragraph is inapplicable.
 II. ☒ Sampling of discharge every 6 month(s) in coordination with a 3rd party laboratory for required laboratory tests.
7. **Contract Duration.** This contract shall be for a period of 24 month(s) from the date this Contract is executed by the parties on page 2
8. **Flow Requirements.** This contract shall be null and void if septic system flow exceeds 500 gallons per day.
9. **Modification to System.** If the septic system is modified, abused, mis-used, or altered, then Meinco's responsibility to service or maintain the septic system is terminated. Meinco may remedy such conditions by replacing parts or correcting defects. If Meinco makes such changes to the septic system, then it may charge to client the costs of repairs, modifications, parts, and labor. Meinco may, at its discretion, seek payment in advance of making any repairs or modifications to the septic system. In such event, Meinco shall not be responsible for any damage or adverse effects for its delay in making repairs or modifications to the septic system.
10. **Access to System.** Client agrees to provide Meinco access to the septic system as well as its parts and components.
11. **Termination by Client.** Client may terminate this contract by providing thirty (30) days written notice to Meinco.
12. **Termination by Meinco.** Notwithstanding, and in addition to, any other provision or term in this Contract, **MEINCO MAY TERMINATE THIS CONTRACT AT ANY TIME AND WITHOUT PREVIOUS NOTICE TO CLIENT.**
13. **Solid Removal.** Solid removal is not a covered service and shall incur an additional fee. If Meinco removes solids from the septic system, then it may charge to client the costs of solid removal. In any event, Meinco shall not be responsible for any damage or adverse effects for any delay in removing solids.
14. **Indemnity.** To the fullest extent permitted by law, Client shall indemnify, hold harmless, and defend Meinco and any agent or employees of Meinco from and against all injuries, claims, damages, losses, and expenses, including, but not limited to, attorneys' fees, arising directly or indirectly out of the obligations herein undertaken or resulting out of operations related to the Service Work or Service Site conducted by Meinco. Meinco's agents, anyone directly or indirectly employed by them or anyone for whose acts they may be liable, regardless of whether or not such injury, claim damage, losses, or expenses is caused in part by a party indemnified. Such obligation shall not negate, abridge, or otherwise reduce the rights or obligations of indemnity which would otherwise exist to a party or person described in this paragraph.

15. **Assignment.** Client agrees that even though this is a contract for services, Meinco may assign this Contract to any third party without written notice to Client.
16. **Bilateral Contract.** Meinco and client specifically agree that Client is seeking Meinco's promise to perform and not its performance.
17. **Claims Against Meinco.** Client shall give Meinco written notice of all claims within five (5) days of Client's knowledge of facts giving rise to the event for which claim is made. Otherwise, such claims shall be deemed waived by Client. All unresolved claims, disputes, and other matters in question between Meinco and Client shall be resolved in the manner provided for in this Agreement.
18. **Rights Upon Breach.** If Client breaches this Agreement with Meinco, Meinco may stop all work, including all Service Work. Additionally, Client will be liable to Meinco for consequential, incidental, and reliance damages as well as attorneys' fees and court costs. Such liability upon Client shall extend to petitions for and orders of contempt as well as any attempts by Meinco to collect upon any debt or damages owed to it by Client, including those entered by court of law or other dispute resolution proceeding.
19. **Direct Discussion.** If a dispute arises out of or relates to this Agreement, the Parties shall endeavor to settle the dispute through direct discussion before advancing to any dispute resolution proceeding.
20. **Joint Drafting.** The Parties expressly agree that this Agreement was jointly drafted and that this Agreement shall be construed neither against nor in favor of either Party. Instead, this Agreement shall be construed in a neutral manner.
21. **Choice of Law.** The Parties expressly agree that any dispute or claim filed or heard in any jurisdiction concerning or relating to this Agreement or worked performed as a result of this Agreement shall be governed by the laws of the State of Arkansas.
22. **Forum Selection and Choice of Venue.** The Parties expressly agree that any dispute or claim arising from, filed, or heard concerning or relating to this Agreement or work performed as a result of this Agreement shall be heard in Saline County, Arkansas, and no other forum. If this clause is penetrated and the hearing concerning the dispute removed to the United States federal court system, then the Parties expressly agree that the dispute shall be heard in the United States District Court for the Eastern District of Arkansas, Western Division, at the Richard Sheppard Arnold United States Courthouse in Little Rock, Arkansas.
23. **Waiver of Agreement Terms.** Meinco, at its sole discretion and leisure, may waive any term in this Agreement. Such waiver shall not, under any conditions or circumstances, constitute a modification of this Agreement. Additionally, such waiver shall not, under any conditions or circumstances, constitute a course of performance, course of dealings, or trade usage between Meinco and Client. Any waiver by Meinco shall be limited to a single incident or event. No waiver of any term of this Agreement is valid unless it is in writing, signed by Meinco, and attached to this Agreement as an addendum. It is the responsibility and duty of Client to draft any written waiver and to present it to Meinco for Meinco's approval and signature.
24. **Force Majeure.** Neither Party shall be in breach of its obligations under this Agreement (other than payment obligations) or incur any liability to the other Party for any losses or damages of any nature whatsoever incurred or suffered if and to the extent that the other party it is prevented from carrying out its obligations by, or such losses or damages are caused by, a *force majeure* event. For purposes of this paragraph, the failure of the state of Arkansas or the United States of America to act according to current practices, procedure, or law at the time of the making of this Contract shall be considered a *force majeure* event. Such event by the government shall be in addition to any current or commonly accepted definition of *force majeure* event.
25. **Merger and Integration.** Meinco and Client agree that this Agreement represents a full, final, and complete memorial of their Agreement for the Service Work and that this Agreement does not rely upon any term or promise not otherwise specified within the four corners of this Agreement.
26. **No Oral Modification.** Meinco and Client agree that this Agreement shall not be subject to oral modification. The Parties agree that any modification made or agreed to by the Parties shall be in writing, signed by both Parties, and attached to this Agreement as an Addendum.

By signing this Agreement below, I indicate that I have read this Agreement and its terms, consisting of two (2) pages, excluding any Addendum or Addenda, and that these express terms are both acceptable and agreeable to me. I further declare that these terms do not represent an undue hardship, are not illusory, and are not unconscionable as I have expressly bargained for these terms in consideration of entering into this Contract for the value specified in paragraph three (3).

 Meinco Septic Systems, Inc.

 Client

6/20/2021

Date

7.1.21

Date

Landmark Surveying
of South Arkansas Inc.
P.O. Box 28
Monticello, AR 71657
(870) 367-2200

PLAT OF SURVEY

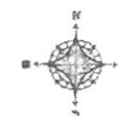
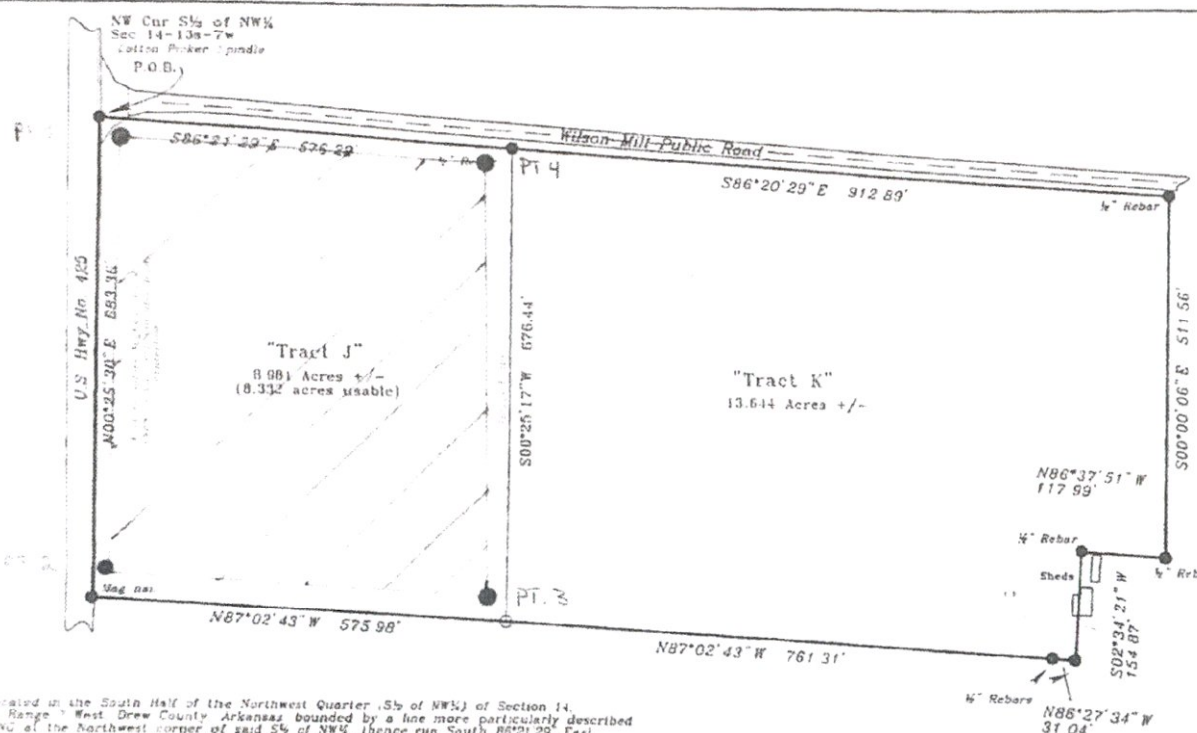

Basis for Bearings
South 86°20'29" East between found monuments along the entire North boundary of that parcel shown as Tract K on the plat of survey for Ralph Maxwell by R W McCoy dated 1998

Survey Description

A parcel of land located in the South Half of the Northwest Quarter (S1/2 of NW1/4) of Section 14, Township 3 South, Range 7 West, Drew County, Arkansas, bounded by a line more particularly described as follows: BEGINNING at the Northwest corner of said S1/2 of NW1/4, thence run South 86°20'29" East along the North boundary of said S1/2 of NW1/4 for a distance of 576.29 feet to a 1/2" Rebar therefound, thence continuing along said North boundary run South 86°20'29" East for a distance of 912.89 feet to a 1/2" Rebar therefound, thence run South 00°00'06" East for a distance of 511.56 feet to a 1/2" Rebar therefound, thence run North 86°37'51" West for a distance of 117.89 feet to a 1/2" Rebar therefound, thence run South 02°34'21" West for a distance of 154.87 feet to a 1/2" Rebar therefound, thence run North 86°27'34" West for a distance of 31.04 feet to a 1/2" Rebar therefound, thence run North 87°02'43" West for a distance of 761.31 feet, thence run North 87°02'43" West for a distance of 575.98 feet to a Mag Nail therefound on the West boundary of said S1/2 of NW1/4, thence run North 00°25'30" East along said West boundary for a distance of 602.50 feet to the point of beginning containing 22.625 acres of land more or less.

Said parcel also known as Tract J and Tract K on the plat of a 1998 survey prepared for Ralph Maxwell by R W McCoy, Professional Land Surveyor.

All Monuments Set during this survey are 1/2" Rebar W/ Cap PLS# 1509 unless specified otherwise above

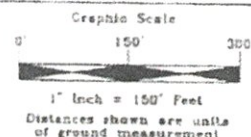

Legend
Monument Found: ●
Monument Set: ○
Calculated Position: △

Prepared for:
James G. Cooper
Date: 03/08/2017
Filename: Cooper 14-13-7
Drawn by: J. Martin
500-13S-07W-0-14-400-22-1509

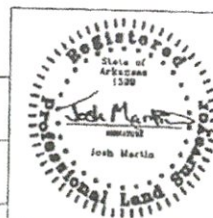

I, Josh Martin, Professional Land Surveyor, do hereby certify that the plat shown hereon is a true and accurate representation of a survey made under my direction and supervision.

Josh Martin 03/06/2017
Josh Martin PLS# 1509

RV park in Limer Rock -
North of River - plunker

Thursday - 2:30 p.m.

New Life Monticello

Legend

📍 1664 US-425





Meinco, Inc
PO Box 1001 * Bryant, AR 72089

ADEQ
Water Permits
5301 Northshore Drive
North Little Rock, AR 72118



UNITED STATES
POSTAL SERVICE.

Retail

G

US POSTAGE PAID

\$8.95

Origin: 72089
04/17/24
0412870518-20

USPS GROUND ADVANTAGE™

1 Lb 0.40 Oz

RDC 01

R015

SHIP
TO:



5301 NORTHSHORE DR
NORTH LITTLE ROCK AR 72118-5328

USPS TRACKING® #



9534 6106 0208 4108 0600 72

