

ARKANSAS DEPARTMENT OF POLLUTION CONTROL AND ECOLOGY
8001 National Drive
Little Rock, Arkansas 72209

41-0002

PERMIT
FOR THE CONSTRUCTION AND/OR OPERATION
OF A SOLID WASTE DISPOSAL
FACILITY

NEKOOSA LIME WASTE AND SLAKER REJECTS LANDFILL

Permit No. S-0185

Date July 24, 1981

G.M. Williams, contact
TO: Nekoosa Papers, Inc.
Post Office Box 496
Ashdown, Arkansas 71822

LOCATION: Part of ~~SE~~ of ~~SE~~ Section 8 and
NE $\frac{1}{4}$ NE $\frac{1}{4}$ Section 17, T13S, R29W in
Little River County

ENGINEER: Garver & Garver - Little Rock, Ark.

This permit is your authority to construct and/or operate the Solid Waste Disposal Facility set forth in your application dated April 24, 1981. This permit is issued pursuant to and subject to the provisions of the Arkansas Solid Waste Management Act (Act 237 of 1971; Sec. 82-2701 et seq., Ark. Stats.), hereinafter called the "Act", the Arkansas Solid Waste Disposal Code, hereinafter called the "Code", and all other applicable rules and regulations of the Department of Pollution Control and Ecology, hereinafter called "Department", and the following terms and conditions:

1. The disposal facility shall be constructed, maintained, and operated in accordance with the final plans and specifications as approved by the Department and in compliance with all applicable provisions of the Act, the Code, and all other applicable rules and regulations.
2. This permit shall automatically terminate unless construction of the disposal facility has been commenced within 50 days ~~months~~ of the date hereof and completed with all reasonable diligence. The Department shall be notified in writing when the disposal facility has been completed in order that it may be inspected.
3. The disposal facility shall be operated by qualified personnel and maintained in good operating condition at all times.
4. This permit may be revoked or modified whenever, in the opinion of the Department, the facilities are no longer in compliance with the Act, the Code, and applicable rules and regulations. This permit shall not relieve the permittee, its agents or employees, from compliance with all provisions of the Act and the Code.
5. Nothing herein contained shall be construed as releasing the permittee from any liability for damage to persons or property by reason of the installation, maintenance, or operation of the disposal facility.
6. This permit is issued in reliance upon the statements and representations made in the application and the plans and specifications and the Department has no responsibility for the adequacy or proper functioning of the disposal facility.
7. NOTE ADDITIONAL CONDITIONS ON ATTACHED SHEET.

Approved:

COMMISSION ON POLLUTION CONTROL & ECOLOGY

By *Jan Broode*
Chairman

DEPARTMENT OF POLLUTION CONTROL & ECOLOGY

By *Janell E. Smith*
Director

Permit No. S-0185

NEKOOSA PAPERS, INC.
Ashdown, Arkansas

ADDITIONAL CONDITIONS

7. This permit shall expire when the approximate 13 acre disposal area described in the final engineering plans has been filled to design capacity.
8. Proper preparation of the site shall be supervised and reported in writing to the Department by a Registered Professional Engineer prior to placement of any waste in the landfill.
9. Daily cover requirements are not required. Placement of final cover will be yearly. Applicant will notify this office in writing when this cover is in place.
10. As an adjunct to the additional conditions listed above, the permittee is reminded that the provisions of Condition #1 of this permit shall also be satisfied in the construction, operation, and maintenance of the landfill.
11. Waste to be deposited in this facility shall consist of the lime and slaker rejects material as described in the narrative.



STATE OF ARKANSAS
DEPARTMENT OF POLLUTION CONTROL AND ECOLOGY

8001 NATIONAL DRIVE, P.O. BOX 9583
LITTLE ROCK, ARKANSAS 72209

April 24, 1989

PHONE: (501) 562-7444

Mr. J.P. Rice, Project Administrator
Nekoosa Papers, Inc.
P.O. Box 496
Ashdown, AR 71822

Re: Lime/Slaker Rejects Landfill, Permit No. 185-S
CSN: 41-0002

Dear Mr. Rice:

This letter is written in response to your detailed information contained with your April 14, 1989 request to reduce the lime/slaker rejects landfill area by 5.6 acres.

We have revised permit S-0185 and included a copy of the new landfill area map, exhibit 6, with your permit.

Its our understanding that with the current loading rates and reduced area, the landfill has capacity for 5.41 more years.

Please contact the Department if there are any questions.

Sincerely,

A handwritten signature in black ink, appearing to read "Joe Doughty".

Joe Doughty, P.E.
Engineer
Solid Waste Division

JD:jfs

cc: Bill Westbrook, Inspector, EFS



Nekoosa Papers Inc.
a company of
Great Northern Nekoosa Corporation

① 4/18/89
SW

April 14, 1989

Mr. Joe Doughty, P.E.
Arkansas Dept. of Pollution Control and Ecology
8001 National Drive, P.O. Box 9583
Little Rock, Arkansas 72209

Re: Nekoosa Lime Waste and Slaker Rejects
Landfill, Permit No. S-0185, Date
July 24, 1981

Dear Joe:

This is the follow-up information on our request to reduce the size of our lime waste and slaker rejects landfill. This approval is essential to our mill expansion.

The operation and conditions of the landfill will remain as the existing permit states. We would reduce the capacity by 5.6 acres.

I have marked two (2) exhibits (No's. 6 and 7) for your review. Red, indicating the area that is filled and green, the proposed area to be filled. The clear area will be used for mill expansion.

Initial Life	-	24 years (from 1981)
Filled Area	-	<u>8</u> years
Remaining	-	16 years
Vol/Day	-	15 cu. yds.
<u>Volume Proposed</u>	-	29,240 cu. yds. (green area) 15 cu. yds./day
	=	<u>1,949</u> days
		360 days/year
<u>Proposed Area</u> (green)	=	5.41 years remaining in site

A reply at your earliest convenience will be appreciated.

Sincerely,

J. P. Rice
Project Administrator

JPR/njg

enclosures (3)

Master

Sheet 10

EXHIBIT 6

Reference Plan For
Operation of
lime Waste/Slaker Reject Landfill

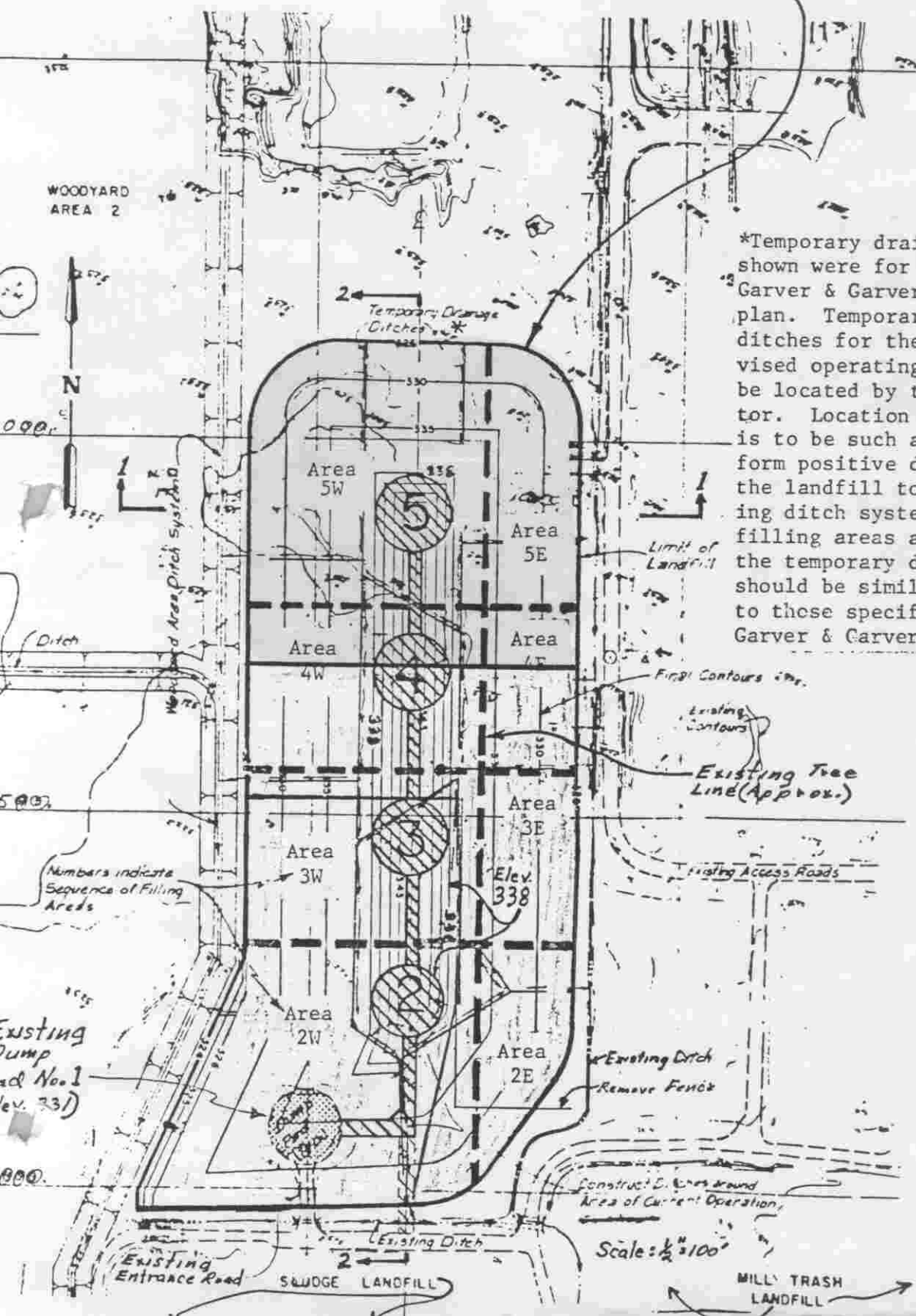

*Temporary drainage ditches shown were for the original Garver & Garver operating plan. Temporary drainage ditches for the 5-1-88 revised operating plan will be located by the Contractor. Location of ditches is to be such as to perform positive drainage from the landfill to the existing ditch system. Landfilling areas affected by the temporary ditches should be similar in size to those specified by Garver & Garver.

*yellow area
no longer
in permit
24 April 89
LP*

WOODYARD
AREA 2

N

Numbers indicate
Sequence of Filling
Areas

Existing
Dump
Road No. 1
(Elev. 331)

Limit of
Landfill

First Contours

Existing
Contours
Existing Tree
Line (Approx.)

Existing Access Roads

Existing Ditch
Remove Fence

Construct Ditches around
Area of Current Operation

Scale: 1/2" = 100'

SANDIDGE LANDFILL

MILL TRASH
LANDFILL